

# TRAFFIC CALMING DISTRICT 18-18-00

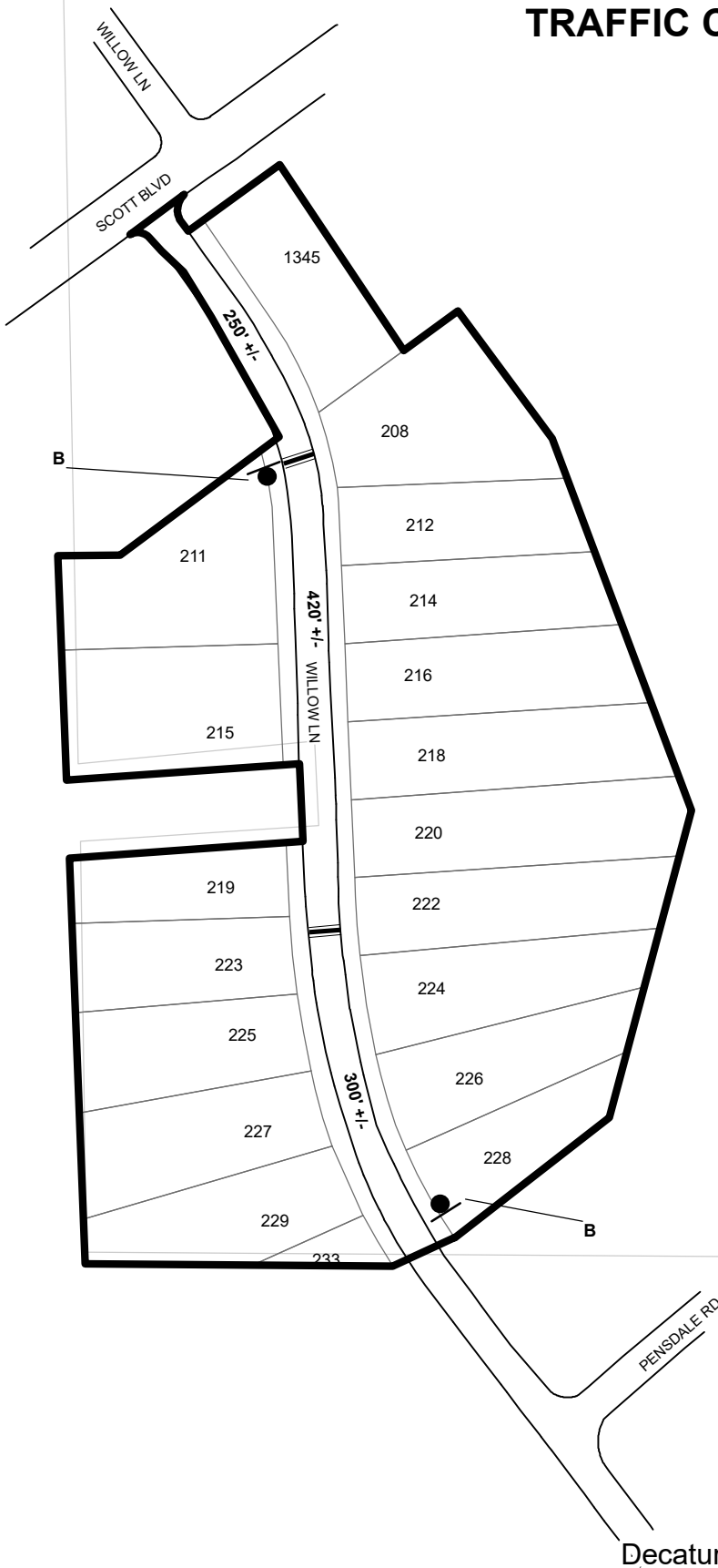

## LEGEND

- AFFECTED AREA
- SPEED TABLES (2)
- PARCEL BOUNDARY AND ADDRESS NUMBER
- SPEED HUMPS AHEAD SIGN AND ADVISORY 15 MPH SPEED PLAQUE

123 +/- DISTANCE BETWEEN TRAFFIC CALMING MEASURES (CENTER TO CENTER) & DISTANCE BETWEEN TRAFFIC CALMING MEASURES AND END OF STREET

### NOTES:

- 1] NUMBER OF PARCELS IN AFFECTED AREA: 19
- 2] STREET(S) IN AFFECTED AREA: WILLOW LN, SCOTT BOULEVARD
- 3] EDGE OF TRAFFIC CALMING MEASURE NOT TO ENCROACH WITHIN 5' OF DRIVEWAY RETURNS

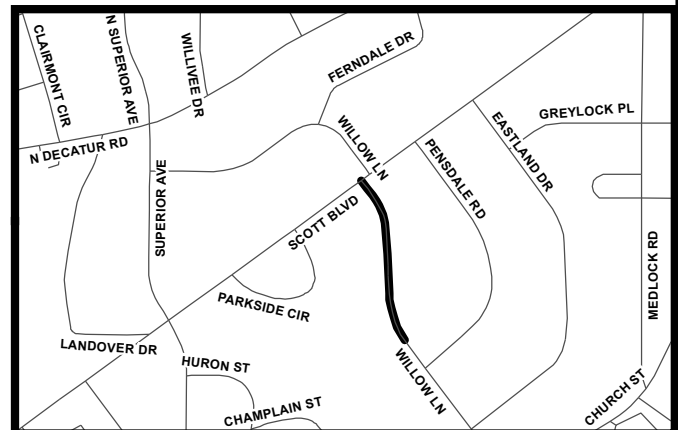

DEKALB COUNTY  
TRANSPORTATION DIVISION  
TRAFFIC CALMING SECTION

DRAWN BY: CH  
REVIEWED BY: CH  
REVIEWED BY: AE  
REVIEWED BY: PGK

SCALE: N.T.S.

Date: 11/5/2018

WILLOW LN  
DIST: 18 TH LAND LOT: 50  
COMMISSION DISTRICTS: 2 & 6