

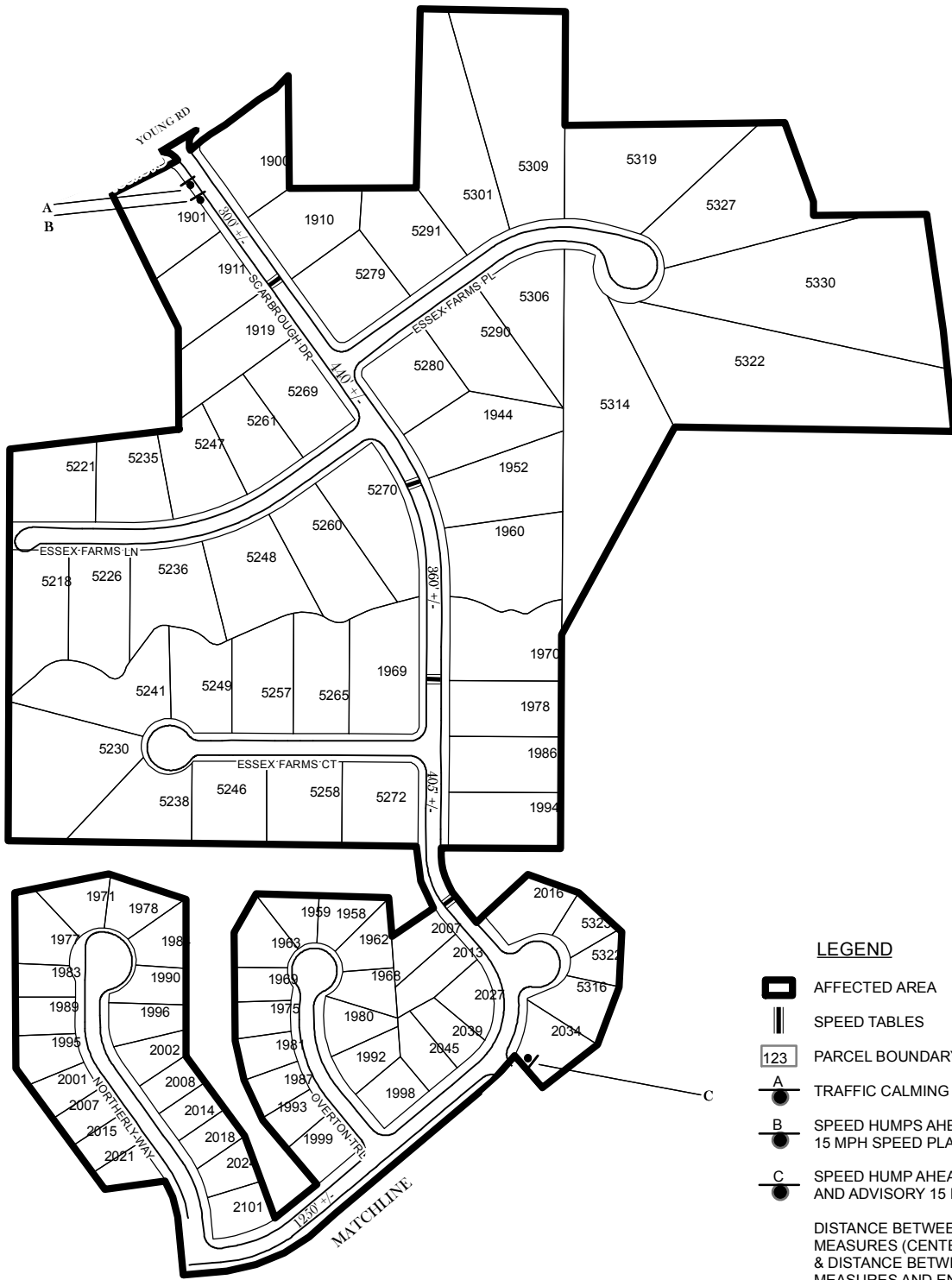



TRAFFIC CALMING DISTRICT 18-16-00 (SECTION 1)

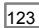
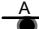
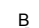

LEGEND

-  AFFECTED AREA
 -  SPEED TABLES
 -  PARCEL BOUNDARY AND ADDRESS NUMBER
 -  A TRAFFIC CALMING DISTRICT SIGNS
 -  B SPEED HUMPS AHEAD SIGN AND ADVISORY 15 MPH SPEED PLAQUE
 -  C SPEED HUMP AHEAD SIGN, CROSS STREET, AND ADVISORY 15 MPH SPEED PLAQUE
- DISTANCE BETWEEN TRAFFIC CALMING MEASURES (CENTER TO CENTER) & DISTANCE BETWEEN TRAFFIC CALMING MEASURES AND END OF STREET

DEKALB COUNTY
TRANSPORTATION DIVISION
TRAFFIC CALMING SECTION

DRAWN BY: CH
REVIEWED BY: CH
REVIEWED BY: AE
REVIEWED BY: PGK

SCALE: NTS

Date: 6/26/2018

SCARBROUGH DRIVE (SECTION 1)

COMMISSION DISTRICTS: 5 & 7

PG 2 OF 3