

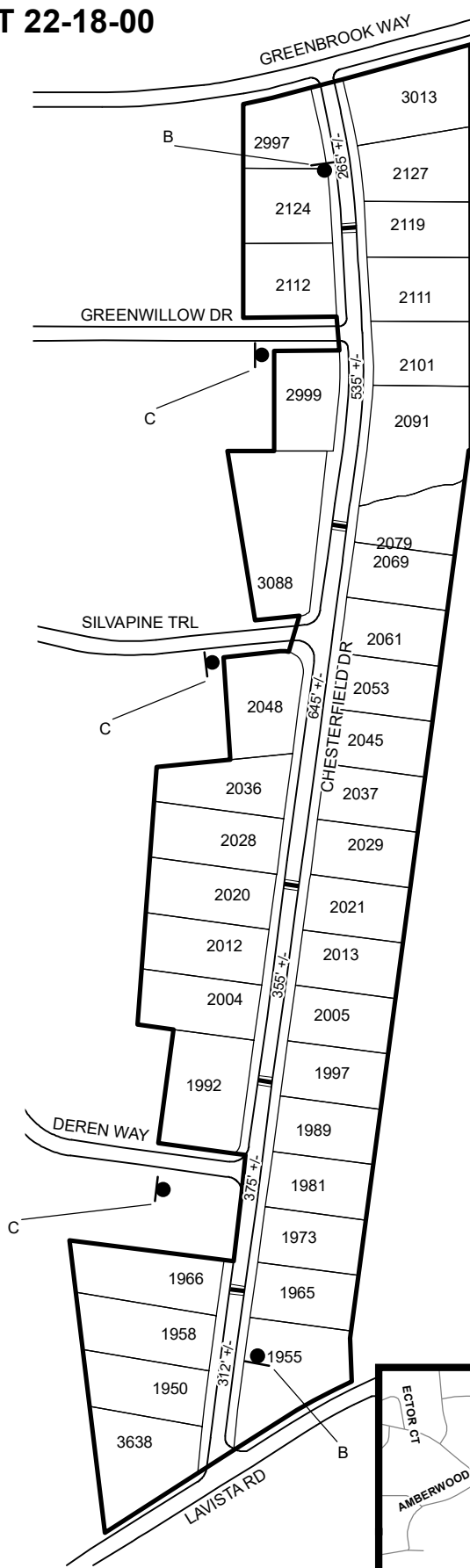





TRAFFIC CALMING DISTRICT 22-18-00



LEGEND

-  AFFECTED AREA
-  SPEED TABLES (5)
-  123 PARCEL BOUNDARY AND ADDRESS NUMBER
-  B SPEED HUMPS AHEAD SIGN AND ADVISORY 15 MPH SPEED PLAQUE
-  C SPEED HUMP AHEAD SIGN, CROSS STREET, AND ADVISORY 15 MPH SPEED PLAQUE
- 123 +/- DISTANCE BETWEEN TRAFFIC CALMING MEASURES (CENTER TO CENTER) & DISTANCE BETWEEN TRAFFIC CALMING MEASURES AND END OF STREET

NOTES:

- 1) NUMBER OF PARCELS IN AFFECTED AREA: 38
- 2) STREET(S) IN AFFECTED AREA: CHESTERFIELD DR, GREENBROOK WAY, GREENWILLOW DR, LAVISTA RD
- 3) EDGE OF TRAFFIC CALMING MEASURE NOT TO ENCROACH WITHIN 5' OF DRIVEWAY RETURNS

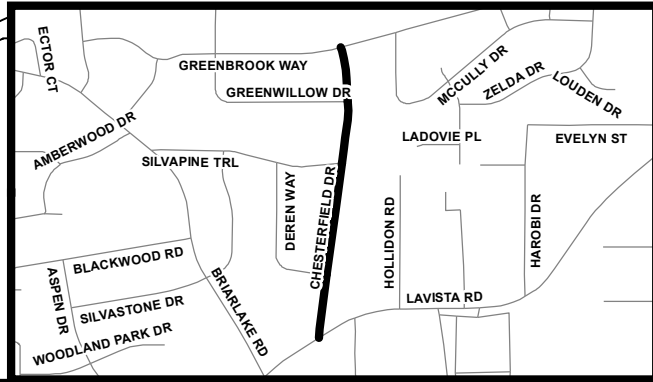

DEKALB COUNTY TRANSPORTATION DIVISION TRAFFIC CALMING SECTION	DRAWN BY: CH	SCALE: N.T.S. Date: 8/9/2022	CHESTERFIELD DR
	REVIEWED BY: CH		DIST: 18 TH LAND LOT: 191 & 208
	REVIEWED BY:	COMMISSION DISTRICTS: 1 & 7	
	REVIEWED BY:		