







TRAFFIC CALMING DISTRICT 18-15-00

LEGEND

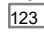
-  AFFECTED AREA
 -  SPEED TABLES (5)
 -  123 PARCEL BOUNDARY AND ADDRESS NUMBER
 -  A TRAFFIC CALMING DISTRICT SIGNS
 -  B SPEED HUMPS AHEAD SIGN AND ADVISORY 15 MPH SPEED PLAQUE
 -  C SPEED HUMP AHEAD SIGN, CROSS STREET, AND ADVISORY 15 MPH SPEED PLAQUE
- 123 +/- DISTANCE BETWEEN TRAFFIC CALMING MEASURES (CENTER TO CENTER) & DISTANCE BETWEEN TRAFFIC CALMING MEASURES AND END OF STREET

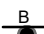

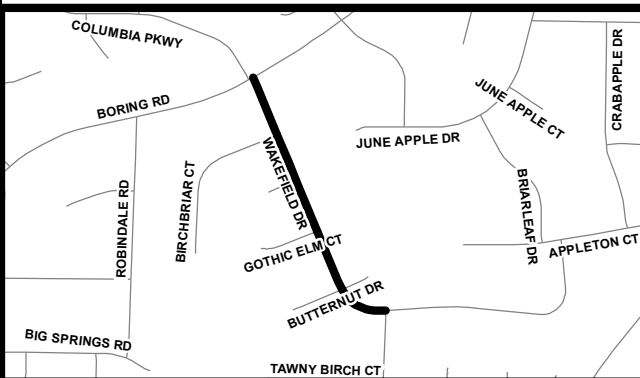
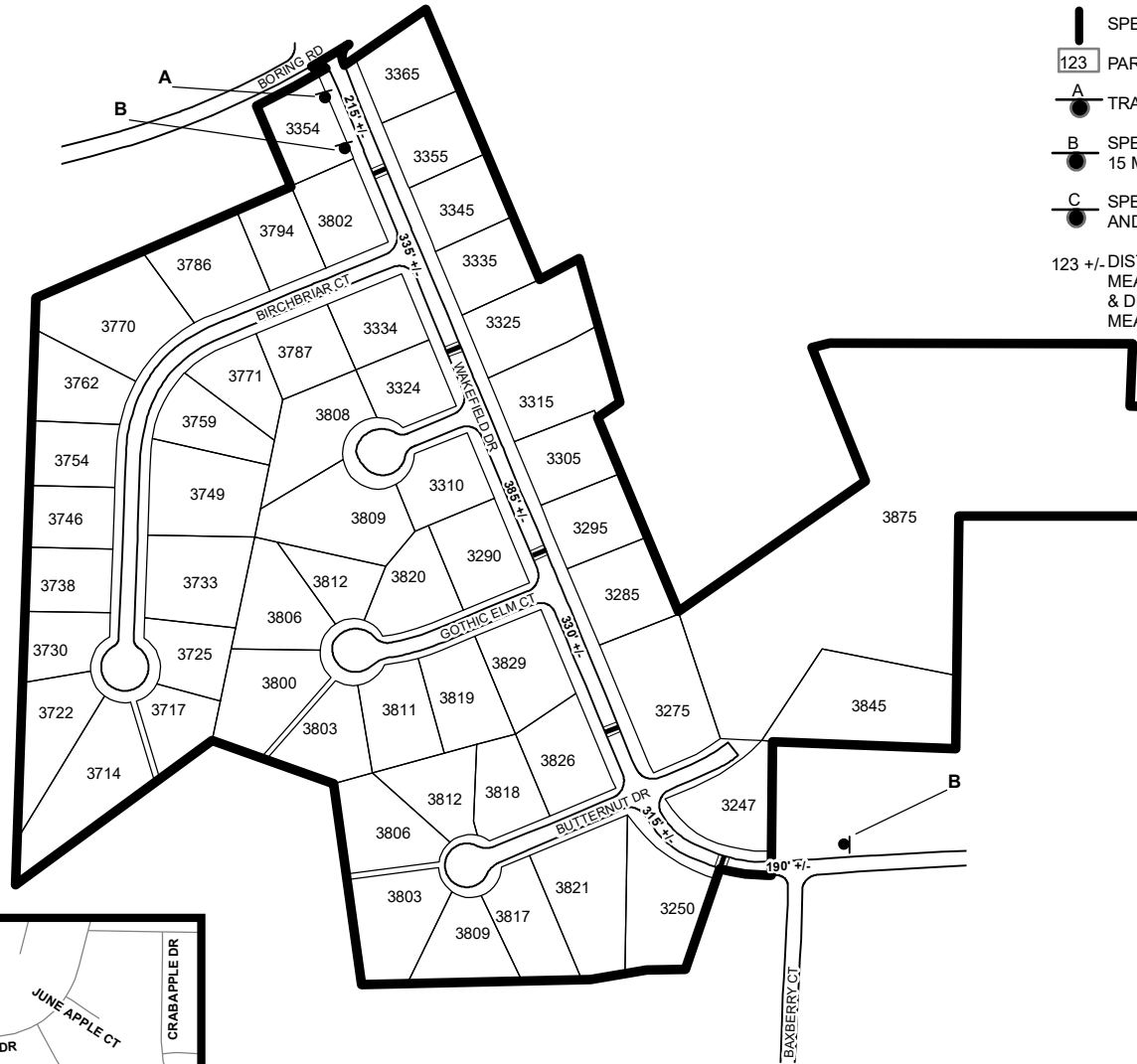
NOTES:

- 1) NUMBER OF PARCELS IN AFFECTED AREA: 55
- 2) STREET(S) IN AFFECTED AREA: WAKEFIELD DR, BIRCHBRIAR CT, BUTTERNUT DR, GOTHIC ELM CT, WHITE ASH CT
- 3) EDGE OF TRAFFIC CALMING MEASURE NOT TO ENCROACH WITHIN 5' OF DRIVEWAY RETURNS

DEKALB COUNTY
TRANSPORTATION DIVISION
TRAFFIC CALMING SECTION

DRAWN BY: CH
REVIEWED BY: CH
REVIEWED BY: AE
REVIEWED BY: PGK

SCALE: N.T.S.

Date: 8/14/2018

WAKEFIELD DR

DIST: 15 TH LAND LOT: 93

COMMISSION DISTRICTS: 3 & 7