

TRAFFIC CALMING DISTRICT 24-16-00

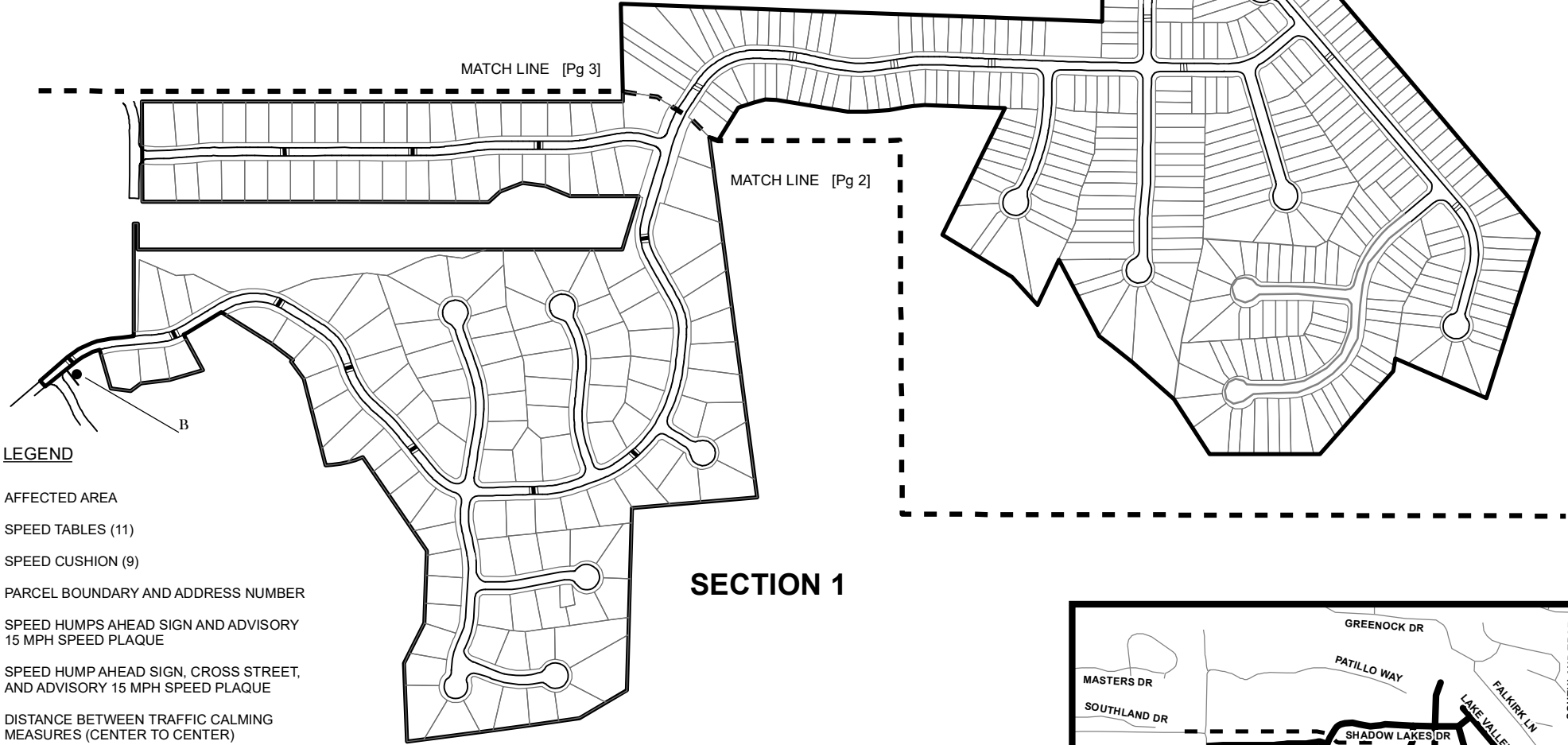

NOTE:
ADDRESS AND STREET NAMES HAVE BEEN REMOVED FROM PAGE 1.
REFER TO PAGES 2 AND 3 FOR ADDRESS NUMBERS AND STREET NAMES.

SECTION 2



LEGEND

- AFFECTED AREA
- SPEED TABLES (11)
- SPEED CUSHION (9)
- 123 PARCEL BOUNDARY AND ADDRESS NUMBER
- SPEED HUMPS AHEAD SIGN AND ADVISORY 15 MPH SPEED PLAQUE
- SPEED HUMP AHEAD SIGN, CROSS STREET, AND ADVISORY 15 MPH SPEED PLAQUE
- 123 +/- DISTANCE BETWEEN TRAFFIC CALMING MEASURES (CENTER TO CENTER) & DISTANCE BETWEEN TRAFFIC CALMING MEASURES AND END OF STREET

SECTION 1

NOTES:

- 1] NUMBER OF PARCELS IN AFFECTED AREA: 475
- 2] STREET(S) IN AFFECTED AREA: SHADOW LAKES DR, COURSE RIDGE DR, COURSE SIDE WAY, HOWELL RDG, LAKE VALLEY PT, LAKES CIR, PATTILLO LN, SHADOW LAKES VW, SHADOW LAKES WAY, SHADOW SQ, SHADOW VALLEY CT, LAKE ROCK LN & VALLEY ROCK DR
- 3] EDGE OF TRAFFIC CALMING MEASURE NOT TO ENCROACH WITHIN 5' OF DRIVEWAY RETURNS

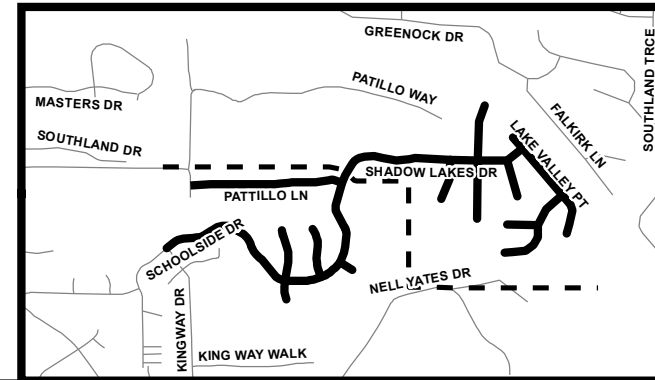

**DEKALB COUNTY
TRANSPORTATION DIVISION
TRAFFIC CALMING SECTION**

DRAWN BY: CH/AE
REVIEWED BY: AE
REVIEWED BY:
REVIEWED BY: PGK

SCALE: N.T.S.

Date: 2/14/2024

SHADOW LAKES DR, PATTILLO LN,
SHADOW VALLEY CT & LAKE VALLEY PT

DIST: 16 TH LAND LOT: 66, 95, 96, 97 & 98

COMMISSION DISTRICTS: 4 & 7 Pg 1 of 3