

# TRAFFIC CALMING DISTRICT 19-16-00





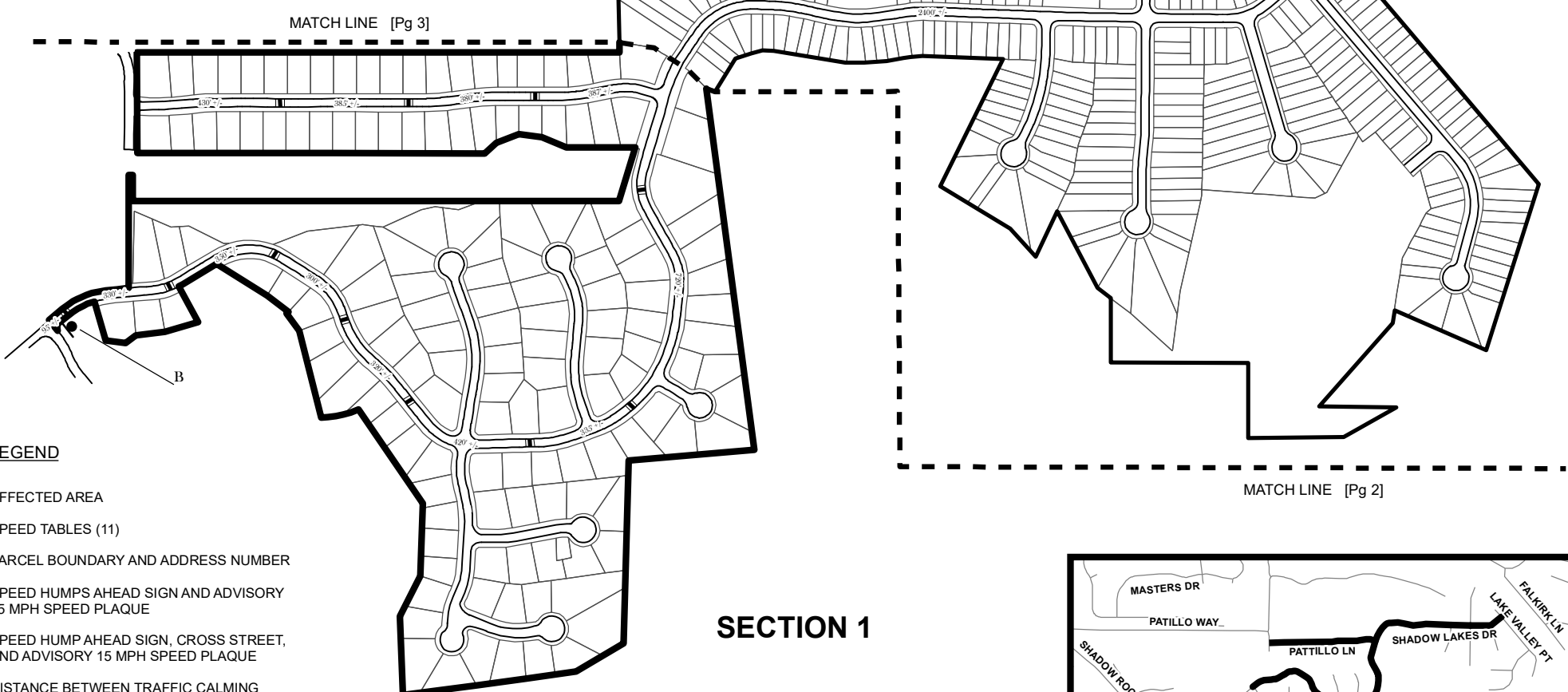

## SECTION 2

## SECTION 1

NOTE:  
ADDRESS AND STREET NAMES HAVE BEEN REMOVED FROM PAGE 1.  
REFER TO PAGES 2 AND 3 FOR ADDRESS NUMBERS AND STREET NAMES.



### LEGEND

-  AFFECTED AREA
-  SPEED TABLES (11)
-  123 PARCEL BOUNDARY AND ADDRESS NUMBER
-  B SPEED HUMPS AHEAD SIGN AND ADVISORY 15 MPH SPEED PLAQUE
-  C SPEED HUMP AHEAD SIGN, CROSS STREET, AND ADVISORY 15 MPH SPEED PLAQUE
- 123 +/- DISTANCE BETWEEN TRAFFIC CALMING MEASURES (CENTER TO CENTER) & DISTANCE BETWEEN TRAFFIC CALMING MEASURES AND END OF STREET

### NOTES:

- 1] NUMBER OF PARCELS IN AFFECTED AREA: 412
- 2] STREET(S) IN AFFECTED AREA: SHADOW LAKES DR, COURSE RIDGE DR, COURSE SIDE WAY, HOWELL RDG, LAKE VALLEY PT, LAKES CIR, PATTILLO LN, SCHOOLSIDE DR, SHADOW LAKES VW, SHADOW LAKES WAY, SHADOW SQ, SHADOW VALLEY CT
- 3] EDGE OF TRAFFIC CALMING MEASURE NOT TO ENCROACH WITHIN 5' OF DRIVEWAY RETURNS

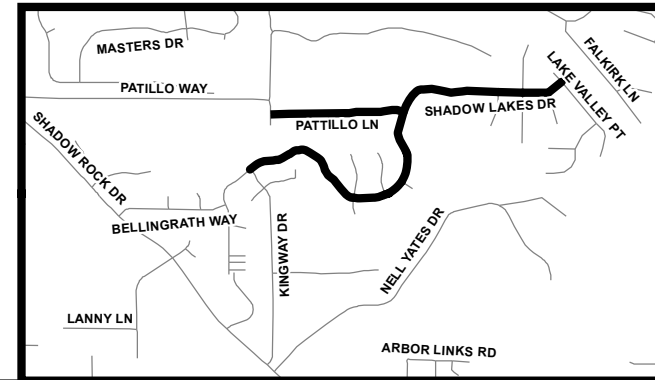

DEKALB COUNTY TRANSPORTATION DIVISION TRAFFIC CALMING SECTION	DRAWN BY: CH	SCALE: N.T.S.  Date: 11/19/2019	SHADOW LAKES DR & PATTILLO LANE
	REVIEWED BY: CH		DIST: 16 TH LAND LOT: 66, 95 & 96 & 97 & 98
	REVIEWED BY: AE		COMMISSION DISTRICTS: 4 & 7
	REVIEWED BY: PGK		Pg 1 of 3