

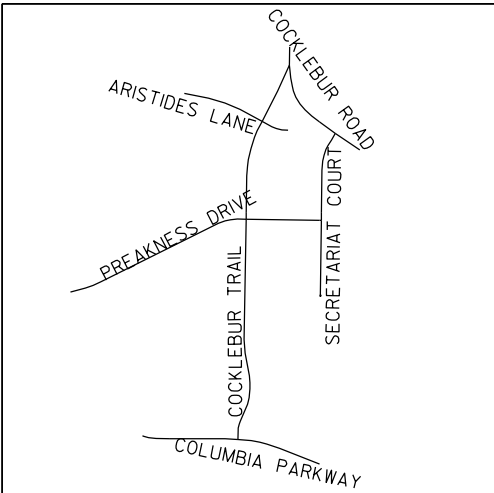

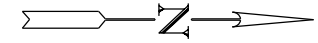





TRAFFIC CALMING DISTRICT 17-15-03

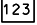

LOCATION MAP

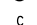
-  AFFECTED AREA
 -  SPEED TABLES (5)
 -  YES VOTES (11)
 -  PARCEL BOUNDARY AND ADDRESS NUMBER
 -  TRAFFIC CALMING DISTRICT SIGNS
 -  SPEED HUMPS AHEAD AND ADVISORY 15 MPH SPEED PLAQUE
 -  SPEED HUMP AHEAD SIGN, CROSS STREET, AND ADVISORY 15 MPH SPEED PLAQUE
- DISTANCE BETWEEN TRAFFIC CALMING MEASURES (CENTER TO CENTER) & DISTANCE BETWEEN TRAFFIC CALMING MEASURES AND END OF STREET

- NOTES:**
- 1) NUMBER OF PARCELS IN AFFECTED AREA: 16
 - 2) STREETS IN AFFECTED AREA : COCKLEBUR TRAIL
 - 3) EDGE OF TRAFFIC CALMING MEASURE NOT TO ENCROACH WITHIN 5' OF DRIVEWAY RETURNS

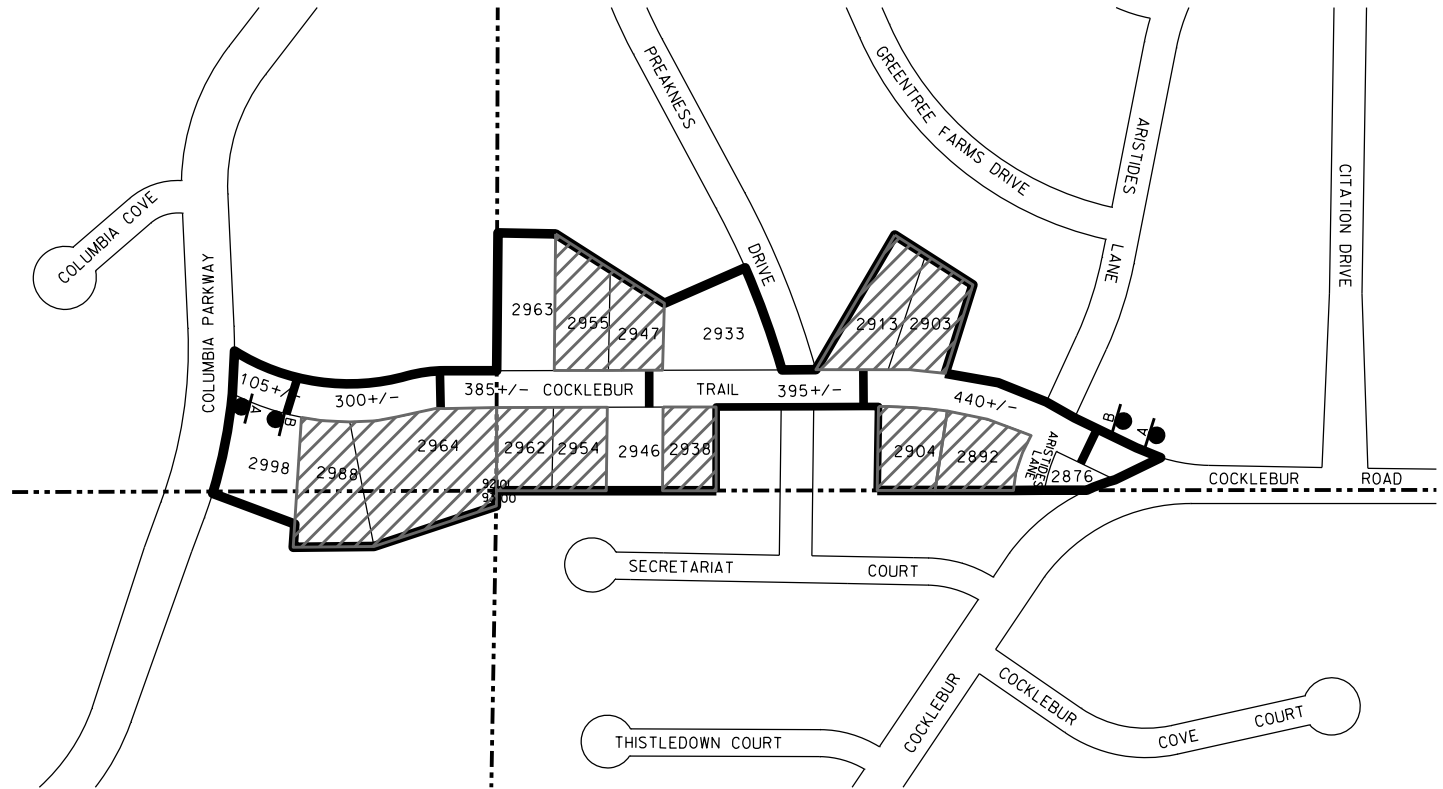

DEKALB COUNTY
TRANSPORTATION DIVISION
TRAFFIC CALMING SECTION

DRAWN BY: TC	APPROVED:
REVIEWED BY: TC	SCALE: N.T.S
REVIEWED BY:	DATE: 03/28/2017
REVIEWED BY:	

COCKLEBUR TRAIL
DIST: 15TH LAND LOT: 92, 93 & 101
COMMISSION DISTRICTS: 3 & 7