

TRAFFIC CALMING DISTRICT 24-15-00

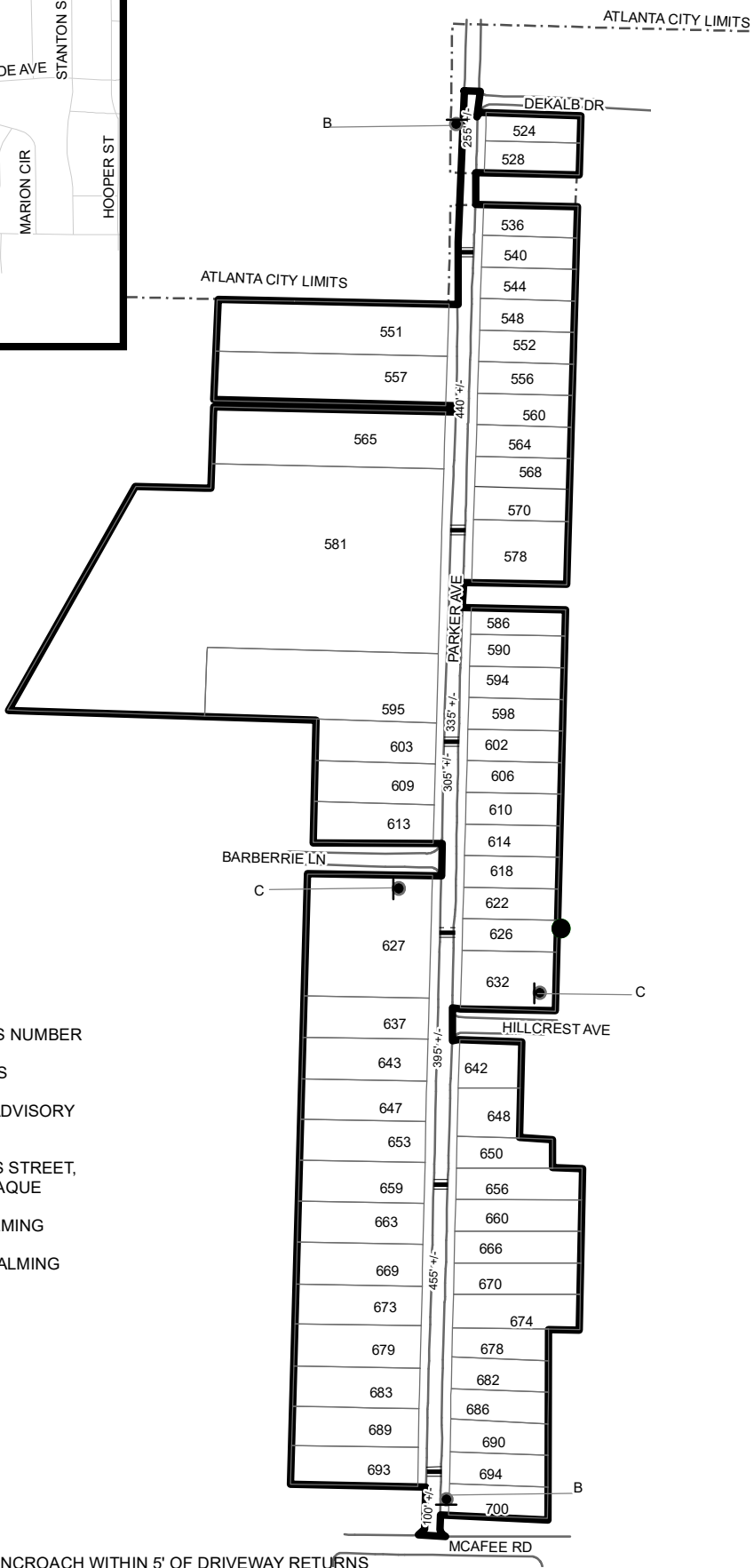
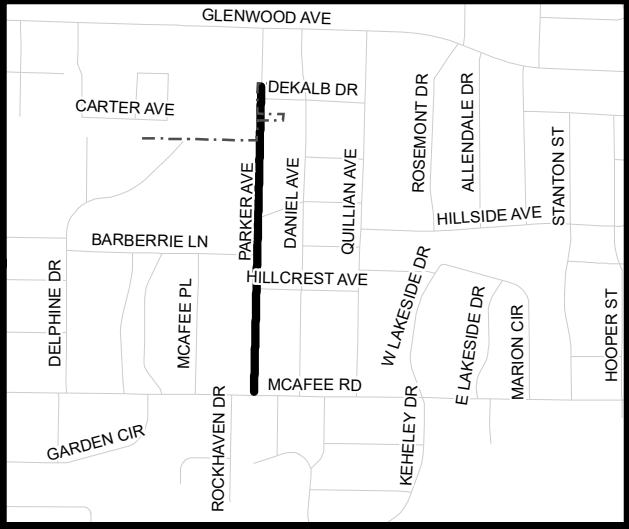

LEGEND

- AFFECTED AREA
 - SPEED TABLES (6)
 - PARCEL BOUNDARY AND ADDRESS NUMBER
 - A TRAFFIC CALMING DISTRICT SIGNS
 - B SPEED HUMPS AHEAD SIGN AND ADVISORY 15 MPH SPEED PLAQUE
 - C SPEED HUMP AHEAD SIGN, CROSS STREET, AND ADVISORY 15 MPH SPEED PLAQUE
- 123 +/- DISTANCE BETWEEN TRAFFIC CALMING MEASURES (CENTER TO CENTER) & DISTANCE BETWEEN TRAFFIC CALMING MEASURES AND END OF STREET

NOTES:

- 1] NUMBER OF PARCELS IN AFFECTED AREA: 60
- 2] STREET(S) IN AFFECTED AREA: PARKER AVE.
- 3] EDGE OF TRAFFIC CALMING MEASURE NOT TO ENCROACH WITHIN 5' OF DRIVEWAY RETURNS

DEKALB COUNTY TRANSPORTATION DIVISION TRAFFIC CALMING SECTION	DRAWN BY: AE	SCALE: N.T.S.	PARKER AVENUE DIST: 15 TH LAND LOT: 171 & 172 COMMISSION DISTRICTS: 3 & 6
	REVIEWED BY: AE		
	REVIEWED BY:	Date: 3/26/2024	
	REVIEWED BY:		