

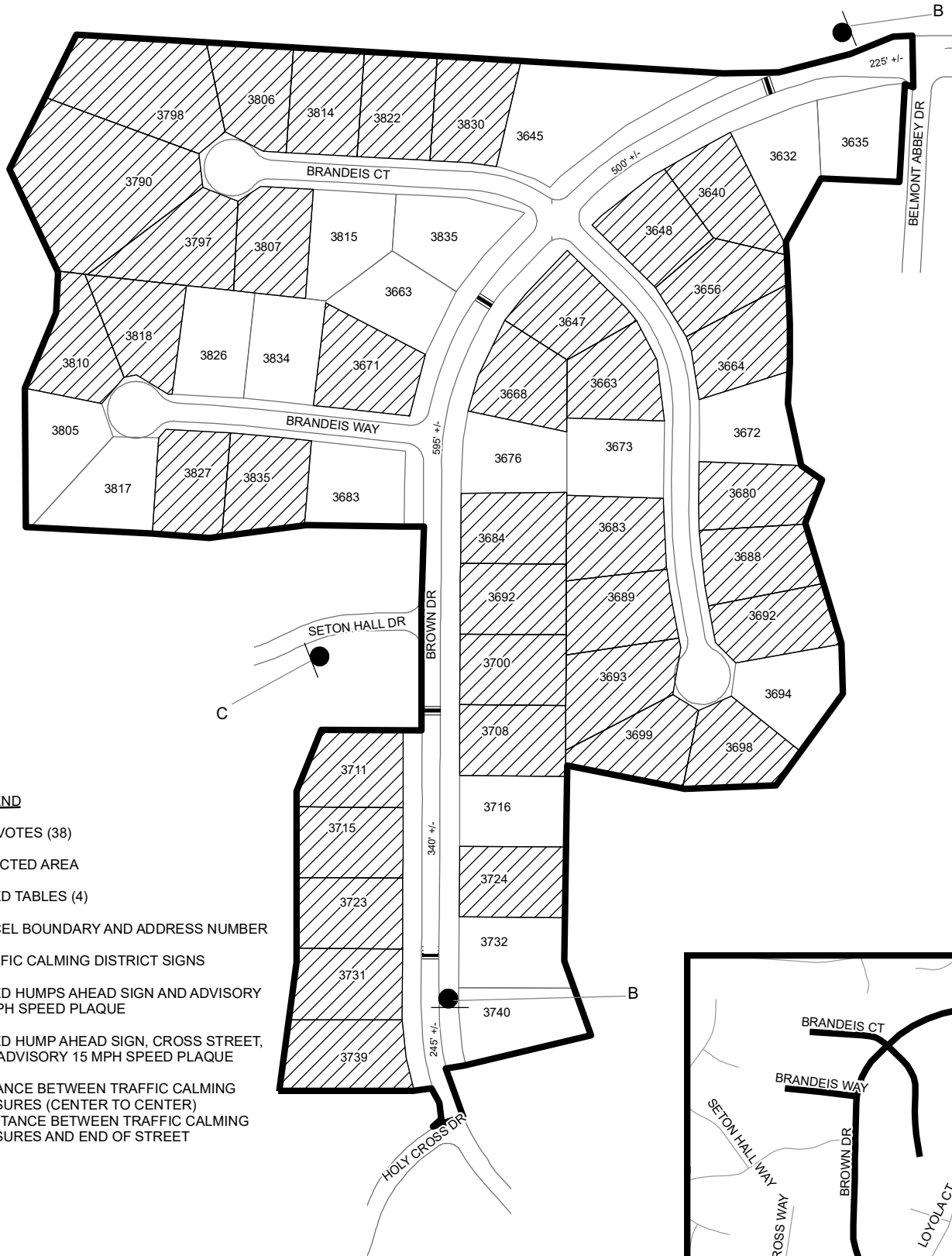







# TRAFFIC CALMING DISTRICT 23-15-09

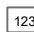

**LEGEND**

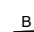
-  YES VOTES (38)
-  AFFECTED AREA
-  SPEED TABLES (4)
-  PARCEL BOUNDARY AND ADDRESS NUMBER
-  TRAFFIC CALMING DISTRICT SIGNS
-  SPEED HUMPS AHEAD SIGN AND ADVISORY 15 MPH SPEED PLAQUE
-  SPEED HUMP AHEAD SIGN, CROSS STREET, AND ADVISORY 15 MPH SPEED PLAQUE
-  123' +/- DISTANCE BETWEEN TRAFFIC CALMING MEASURES (CENTER TO CENTER) & DISTANCE BETWEEN TRAFFIC CALMING MEASURES AND END OF STREET

NOTES:  
 1] NUMBER OF PARCELS IN AFFECTED AREA: 56  
 2] STREET(S) IN AFFECTED AREA: BROWN DR, BELMONT ABBEY DR, BRANDEIS CT & BRANDEIS WY  
 3] EDGE OF TRAFFIC CALMING MEASURE NOT TO ENCROACH WITHIN 5' OF DRIVEWAY RETURNS

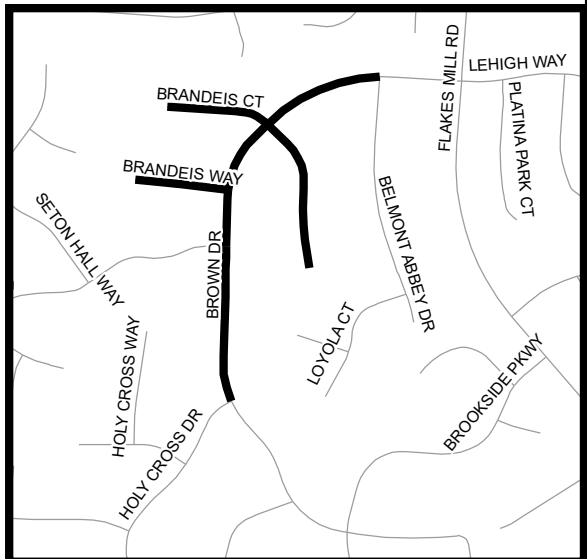

DEKALB COUNTY  
 TRANSPORTATION DIVISION  
 TRAFFIC CALMING SECTION

DRAWN BY: AE  
 REVIEWED BY: AE  
 REVIEWED BY:  
 REVIEWED BY:

SCALE: N.T.S.  
 DATE: 10/24/2023

BROWN DRIVE  
 DIST: 15 TH LAND LOT: 36, 60 & 61  
 COMMISSION DISTRICTS: 3 & 7