





# TRAFFIC CALMING DISTRICT 19-18-04

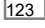

### LEGEND

-  AFFECTED AREA
  -  YES VOTES
  -  SPEED TABLES (2)
  -  PARCEL BOUNDARY AND ADDRESS NUMBER
  -  TRAFFIC CALMING DISTRICT SIGNS
  -  SPEED HUMPS AHEAD SIGN AND ADVISORY 15 MPH SPEED PLAQUE
- 123 +/- DISTANCE BETWEEN TRAFFIC CALMING MEASURES (CENTER TO CENTER) & DISTANCE BETWEEN TRAFFIC CALMING MEASURES AND END OF STREET

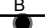
### NOTES:

- 1] NUMBER OF PARCELS IN AFFECTED AREA: 9
- 2] STREET(S) IN AFFECTED AREA: 1ST AVE
- 3] EDGE OF TRAFFIC CALMING MEASURE NOT TO ENCROACH WITHIN 5' OF DRIVEWAY RETURNS

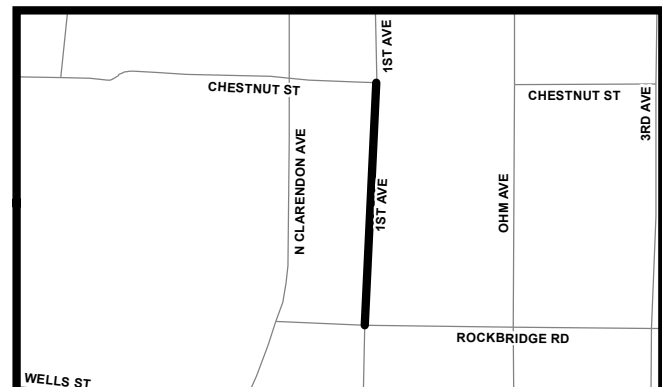

DEKALB COUNTY  
TRANSPORTATION DIVISION  
TRAFFIC CALMING SECTION

DRAWN BY: CH  
REVIEWED BY: CH  
REVIEWED BY: AE  
REVIEWED BY: PGK

SCALE: N.T.S.

Date: 6/11/2019

1st AVE

DIST: 18 TH LAND LOT: 9

COMMISSION DISTRICTS: 4 & 6