

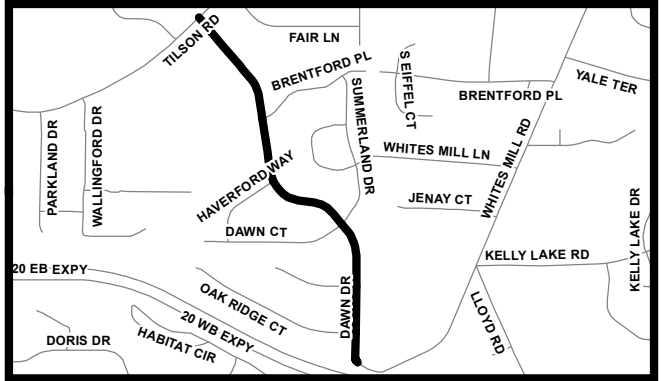

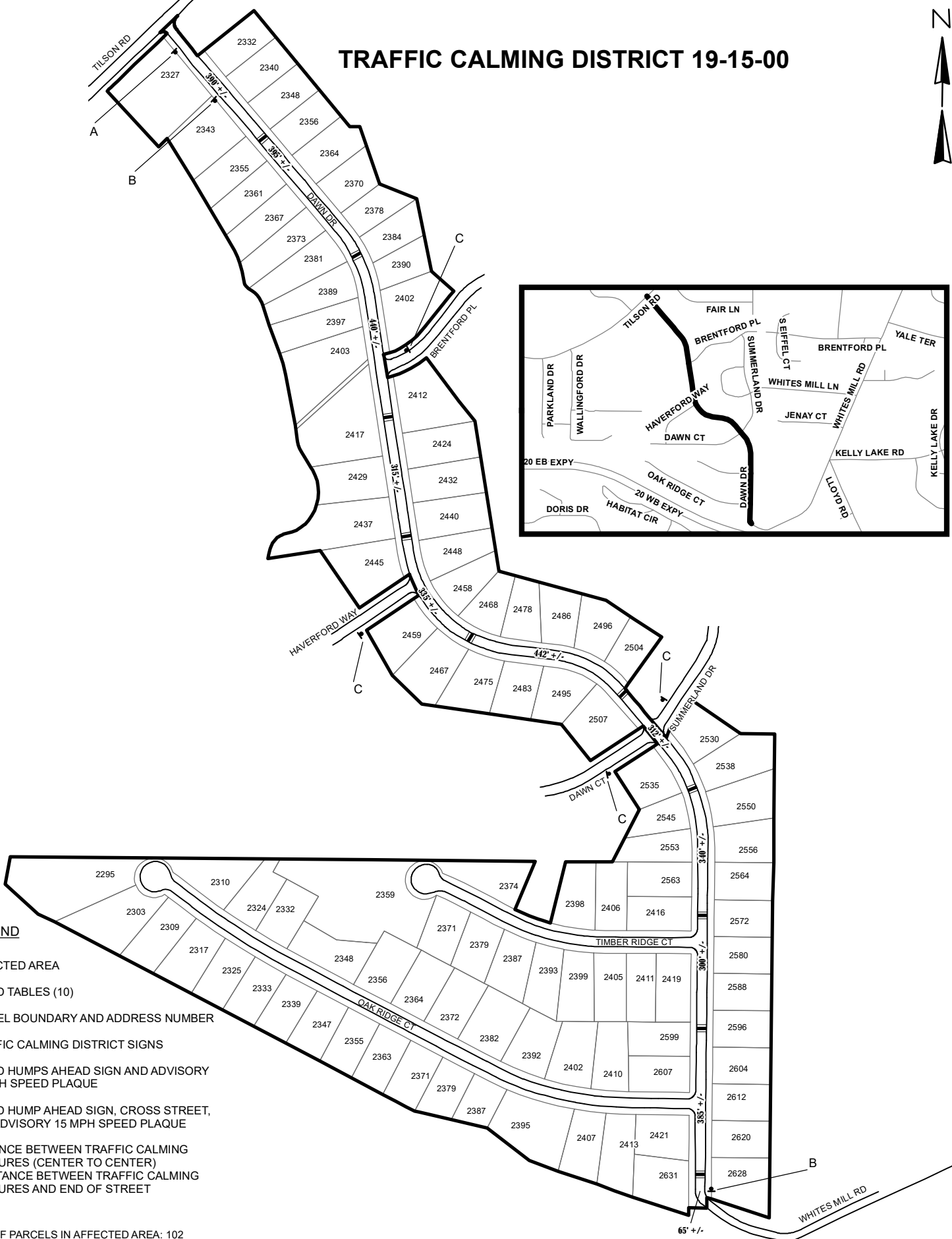







TRAFFIC CALMING DISTRICT 19-15-00



LEGEND

-  AFFECTED AREA
-  SPEED TABLES (10)
-  PARCEL BOUNDARY AND ADDRESS NUMBER
-  TRAFFIC CALMING DISTRICT SIGNS
-  SPEED HUMPS AHEAD SIGN AND ADVISORY 15 MPH SPEED PLAQUE
-  SPEED HUMP AHEAD SIGN, CROSS STREET, AND ADVISORY 15 MPH SPEED PLAQUE
-  123 +/- DISTANCE BETWEEN TRAFFIC CALMING MEASURES (CENTER TO CENTER) & DISTANCE BETWEEN TRAFFIC CALMING MEASURES AND END OF STREET

- NOTES:
- 1) NUMBER OF PARCELS IN AFFECTED AREA: 102
 - 2) STREET(S) IN AFFECTED AREA: DAWN DR, OAK RIDGE CT, TILSON RD, TIMBER RIDGE CT
 - 3) EDGE OF TRAFFIC CALMING MEASURE NOT TO ENCROACH WITHIN 5' OF DRIVEWAY RETURNS

DEKALB COUNTY
TRANSPORTATION DIVISION
TRAFFIC CALMING SECTION

DRAWN BY: CH
REVIEWED BY: CH
REVIEWED BY:
REVIEWED BY:

SCALE: N.T.S.
Date: 5/28/2019

DAWN DR
DIST: 15 TH LAND LOT: 118 & 139
COMMISSION DISTRICTS: 3 & 6