

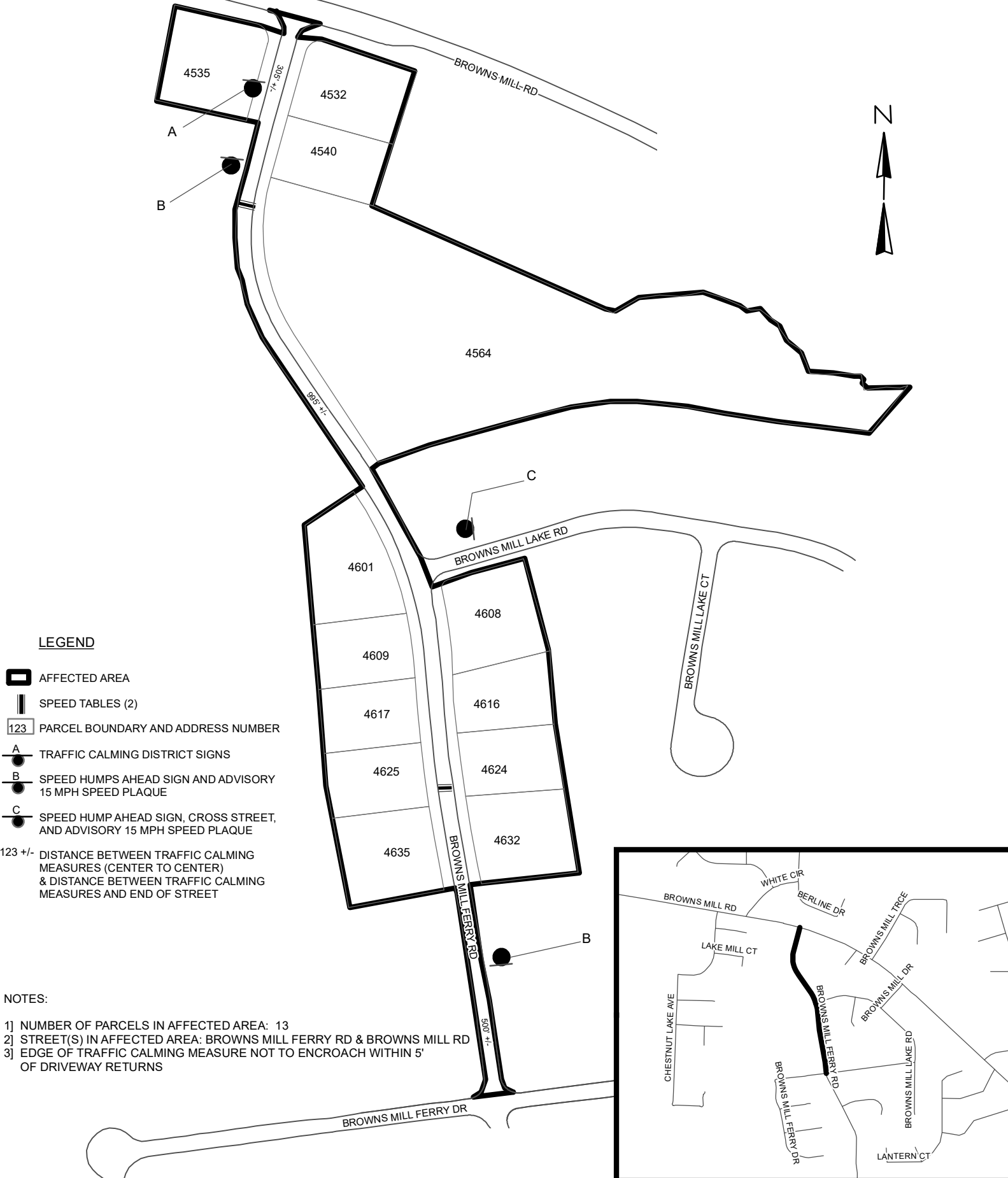





TRAFFIC CALMING DISTRICT 22-11-00



LEGEND

-  AFFECTED AREA
 -  SPEED TABLES (2)
 -  PARCEL BOUNDARY AND ADDRESS NUMBER
 -  TRAFFIC CALMING DISTRICT SIGNS
 -  SPEED HUMPS AHEAD SIGN AND ADVISORY 15 MPH SPEED PLAQUE
 -  SPEED HUMP AHEAD SIGN, CROSS STREET, AND ADVISORY 15 MPH SPEED PLAQUE
- 123 +/- DISTANCE BETWEEN TRAFFIC CALMING MEASURES (CENTER TO CENTER) & DISTANCE BETWEEN TRAFFIC CALMING MEASURES AND END OF STREET

NOTES:

- 1] NUMBER OF PARCELS IN AFFECTED AREA: 13
- 2] STREET(S) IN AFFECTED AREA: BROWNS MILL FERRY RD & BROWNS MILL RD
- 3] EDGE OF TRAFFIC CALMING MEASURE NOT TO ENCROACH WITHIN 5' OF DRIVEWAY RETURNS

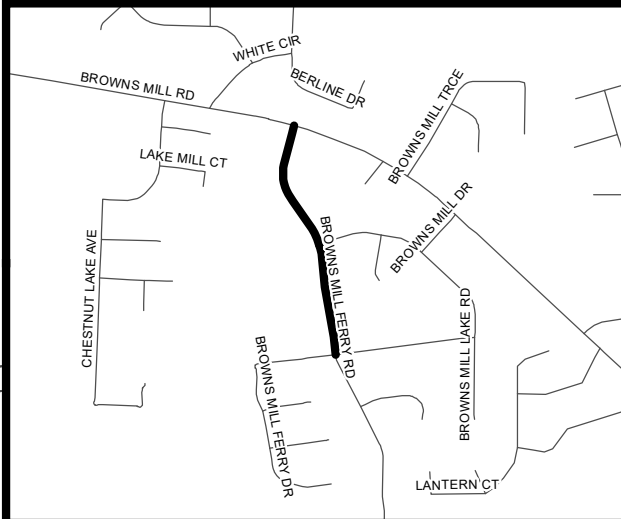

DEKALB COUNTY
TRANSPORTATION DIVISION
TRAFFIC CALMING SECTION

DRAWN BY: AE
REVIEWED BY: AE
REVIEWED BY:
REVIEWED BY:

SCALE: N.T.S.
Date: 2/8/2022

BROWNS MILL FERRY ROAD
DIST: 11 TH LAND LOT: 248
COMMISSION DISTRICTS: 5 & 7