

# TRAFFIC CALMING DISTRICT 00-15-13 REVISED DESIGN

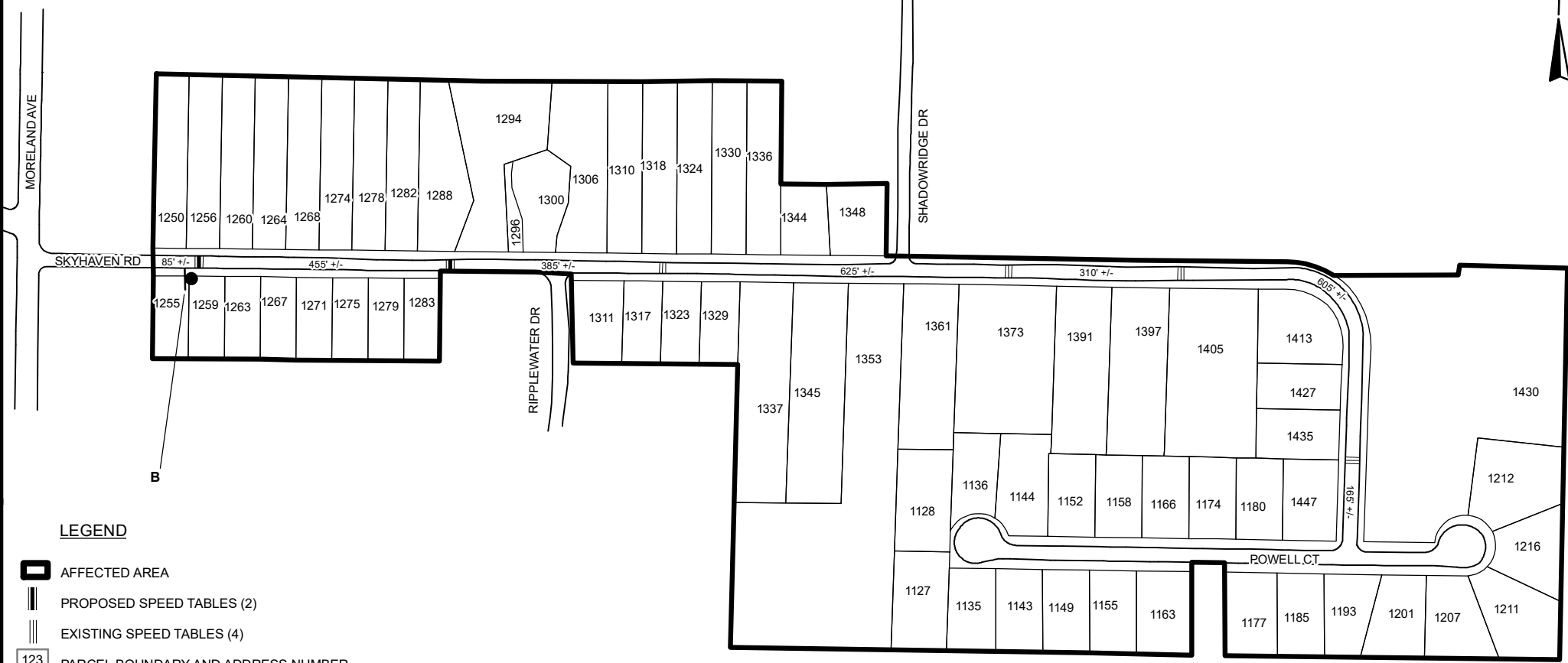

### LEGEND

- AFFECTED AREA
- PROPOSED SPEED TABLES (2)
- EXISTING SPEED TABLES (4)
- PARCEL BOUNDARY AND ADDRESS NUMBER
- TRAFFIC CALMING DISTRICT SIGNS
- SPEED HUMPS AHEAD SIGN AND ADVISORY 15 MPH SPEED PLAQUE
- SPEED HUMP AHEAD SIGN, CROSS STREET, AND ADVISORY 15 MPH SPEED PLAQUE
- DISTANCE BETWEEN TRAFFIC CALMING MEASURES (CENTER TO CENTER) & DISTANCE BETWEEN TRAFFIC CALMING MEASURES AND END OF STREET

- NOTES:
- 1] NUMBER OF PARCELS IN AFFECTED AREA: 67
  - 2] STREET(S) IN AFFECTED AREA: SKYHAVEN RD, POWELL CT
  - 3] EDGE OF TRAFFIC CALMING MEASURE NOT TO ENCROACH WITHIN 5' OF DRIVEWAY RETURNS

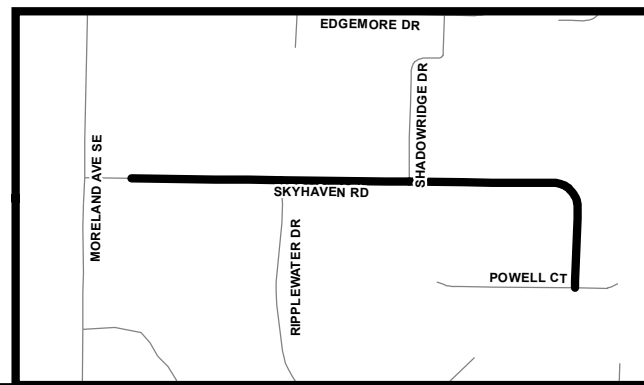

<b>DEKALB COUNTY TRANSPORTATION DIVISION TRAFFIC CALMING SECTION</b>	DRAWN BY: CH	SCALE: N.T.S.  Date: 12/8/2020	SKYHAVEN RD DIST: 15 TH LAND LOT: 144 & 145 COMMISSION DISTRICTS: 3 & 6
	REVIEWED BY: CH		
	REVIEWED BY:		
	REVIEWED BY:		