

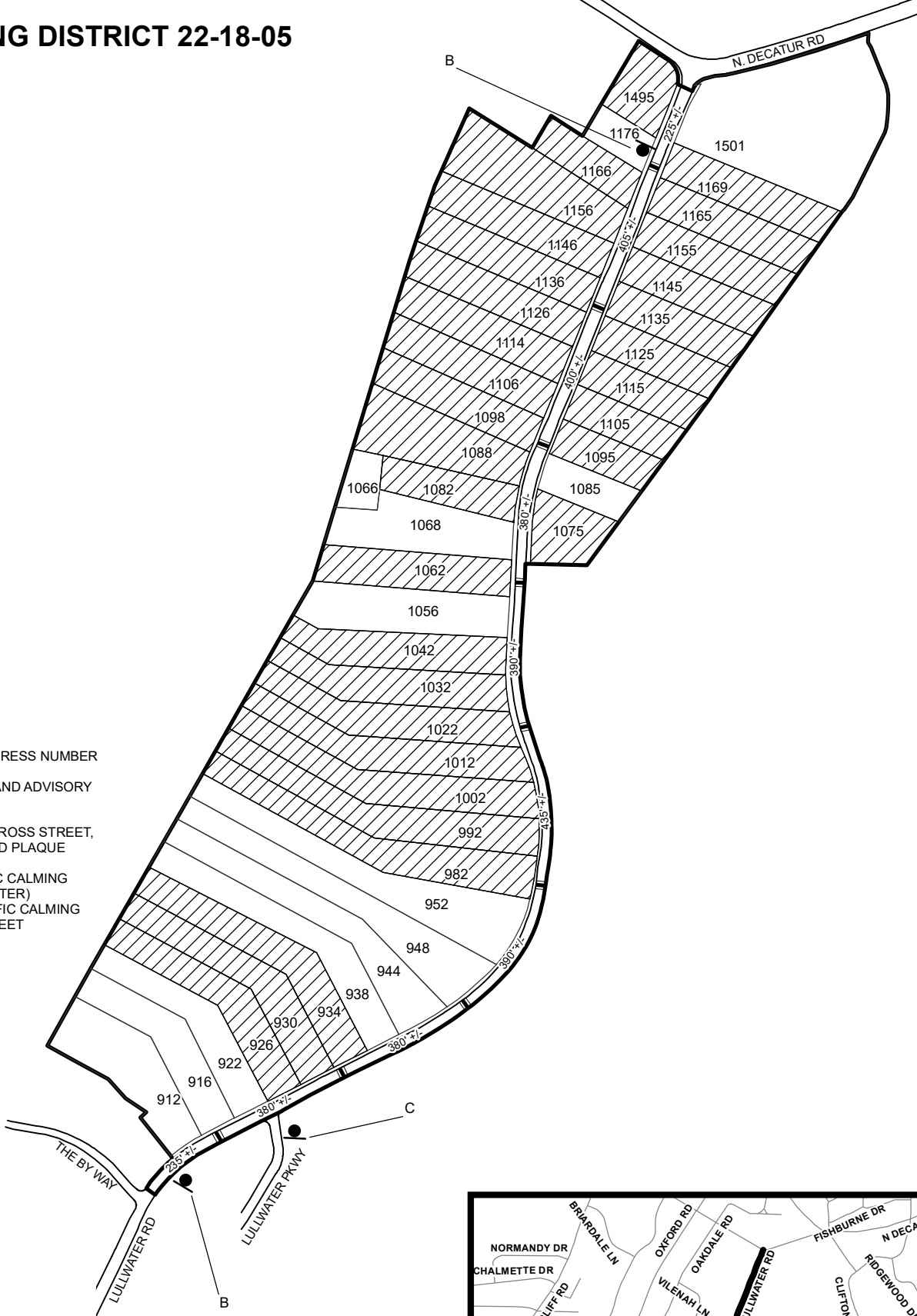



# TRAFFIC CALMING DISTRICT 22-18-05

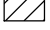
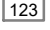

## LEGEND

-  AFFECTED AREA
-  SPEED TABLES (9)
-  YES VOTES (32)
-  PARCEL BOUNDARY AND ADDRESS NUMBER
-  SPEED HUMPS AHEAD SIGN AND ADVISORY 15 MPH SPEED PLAQUE
-  SPEED HUMP AHEAD SIGN, CROSS STREET, AND ADVISORY 15 MPH SPEED PLAQUE
- 123 +/- DISTANCE BETWEEN TRAFFIC CALMING MEASURES (CENTER TO CENTER) & DISTANCE BETWEEN TRAFFIC CALMING MEASURES AND END OF STREET

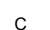
## NOTES:

- 1] NUMBER OF PARCELS IN AFFECTED AREA: 45
- 2] STREET(S) IN AFFECTED AREA: LULLWATER RD, N. DECATUR RD
- 3] EDGE OF TRAFFIC CALMING MEASURE NOT TO ENCROACH WITHIN 5' OF DRIVEWAY RETURNS

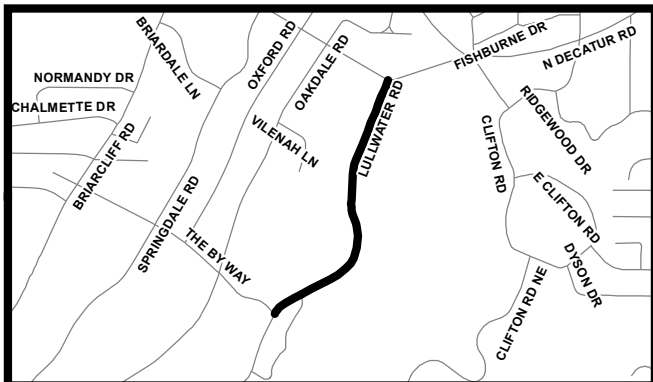

DEKALB COUNTY TRANSPORTATION DIVISION TRAFFIC CALMING SECTION	DRAWN BY: CH	SCALE: N.T.S.  Date: 5/10/2022	LULLWATER RD
	REVIEWED BY: CH		DIST: 18 TH LAND LOT: 2 & 3 & 54
	REVIEWED BY:	COMMISSION DISTRICTS: 2 & 6	
	REVIEWED BY:		