

# TRAFFIC CALMING DISTRICT 23-15-00

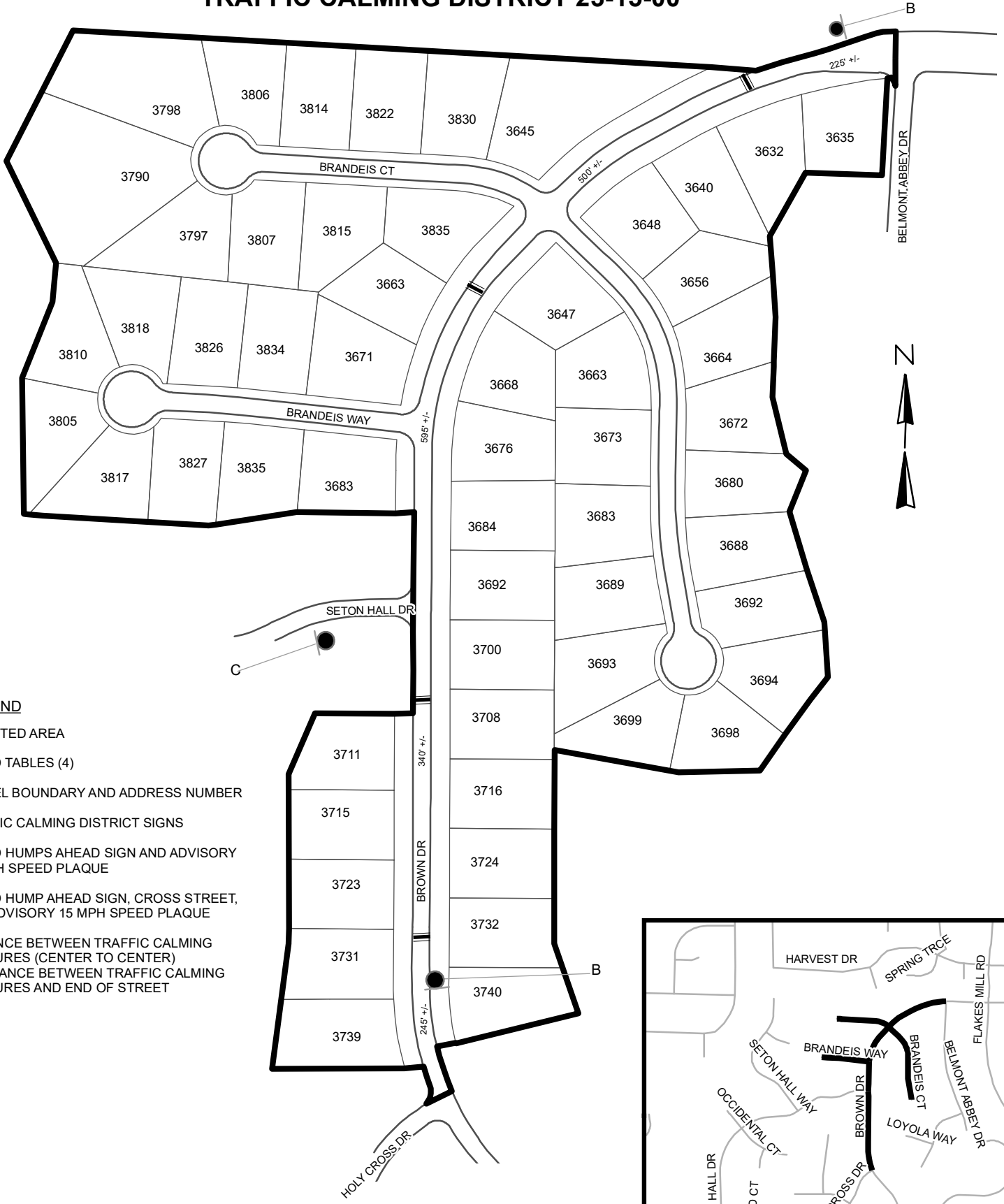

## LEGEND

- AFFECTED AREA
  - SPEED TABLES (4)
  - PARCEL BOUNDARY AND ADDRESS NUMBER
  - TRAFFIC CALMING DISTRICT SIGNS
  - SPEED HUMPS AHEAD SIGN AND ADVISORY 15 MPH SPEED PLAQUE
  - SPEED HUMP AHEAD SIGN, CROSS STREET, AND ADVISORY 15 MPH SPEED PLAQUE
- 123 +/- DISTANCE BETWEEN TRAFFIC CALMING MEASURES (CENTER TO CENTER) & DISTANCE BETWEEN TRAFFIC CALMING MEASURES AND END OF STREET

- NOTES:
- 1] NUMBER OF PARCELS IN AFFECTED AREA: 56
  - 2] STREET(S) IN AFFECTED AREA: BROWN DR, BELMONT ABBEY DR, BRANDEIS CT & BRANDEIS WY
  - 3] EDGE OF TRAFFIC CALMING MEASURE NOT TO ENCROACH WITHIN 5' OF DRIVEWAY RETURNS

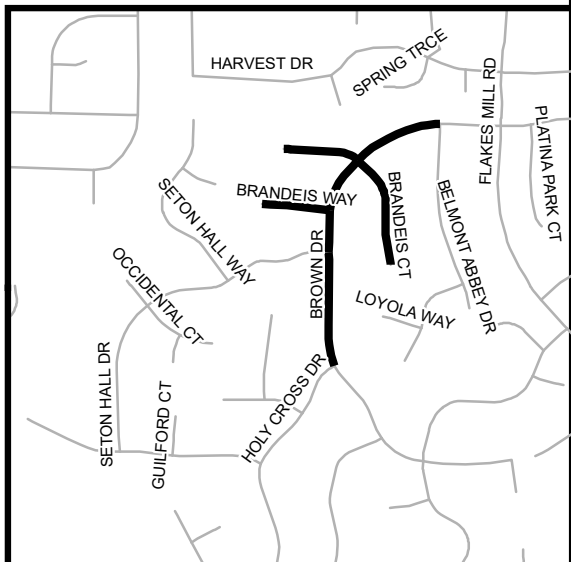

DEKALB COUNTY  
TRANSPORTATION DIVISION  
TRAFFIC CALMING SECTION

DRAWN BY: AE  
REVIEWED BY: AE  
REVIEWED BY:  
REVIEWED BY:

SCALE: N.T.S.  
Date: 5/9/2023

BROWN DRIVE (BELMONT ABBEY DR TO HOLLY CROSS DR)  
DIST: 15 TH LAND LOT: 36, 60 & 61  
COMMISSION DISTRICTS: 3 & 7