

# TRAFFIC CALMING DISTRICT 23-18-00

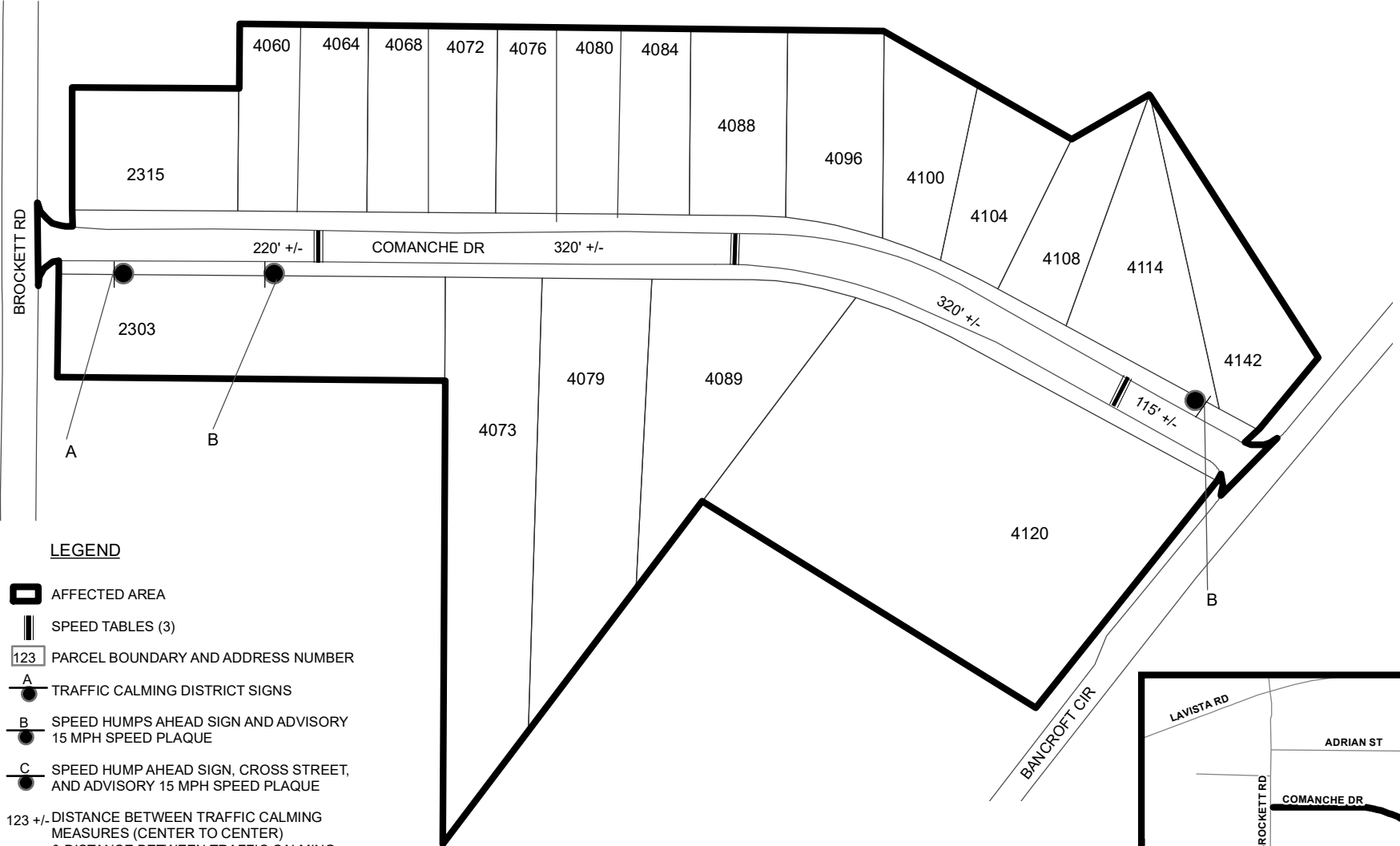

**LEGEND**

- AFFECTED AREA
- SPEED TABLES (3)
- PARCEL BOUNDARY AND ADDRESS NUMBER
- TRAFFIC CALMING DISTRICT SIGNS
- SPEED HUMPS AHEAD SIGN AND ADVISORY 15 MPH SPEED PLAQUE
- SPEED HUMP AHEAD SIGN, CROSS STREET, AND ADVISORY 15 MPH SPEED PLAQUE
- 123 +/- DISTANCE BETWEEN TRAFFIC CALMING MEASURES (CENTER TO CENTER) & DISTANCE BETWEEN TRAFFIC CALMING MEASURES AND END OF STREET

**NOTES:**

- 1) NUMBER OF PARCELS IN AFFECTED AREA: 20
- 2) STREET(S) IN AFFECTED AREA: COMANCHE DR, BANCROFT CIR & BROCKETT RD
- 3) EDGE OF TRAFFIC CALMING MEASURE NOT TO ENCROACH WITHIN 5' OF DRIVEWAY RETURNS

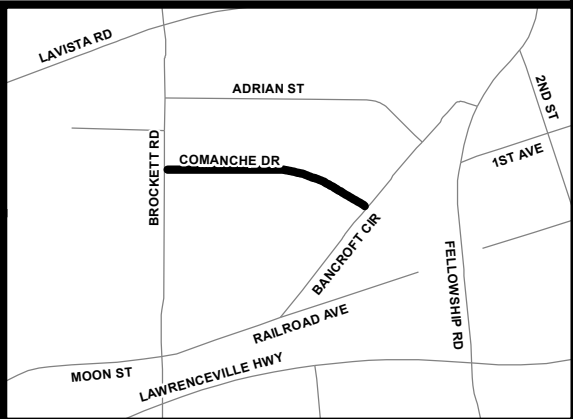

DEKALB COUNTY  
TRANSPORTATION DIVISION  
TRAFFIC CALMING SECTION

DRAWN BY: AE  
REVIEWED BY: AE  
REVIEWED BY:  
REVIEWED BY:

SCALE: N.T.S.  
  
Date: 2/28/2023

COMANCHE DRIVE  
DIST: 18 TH LAND LOT(S): 213  
COMMISSION DISTRICTS: 1 & 7