

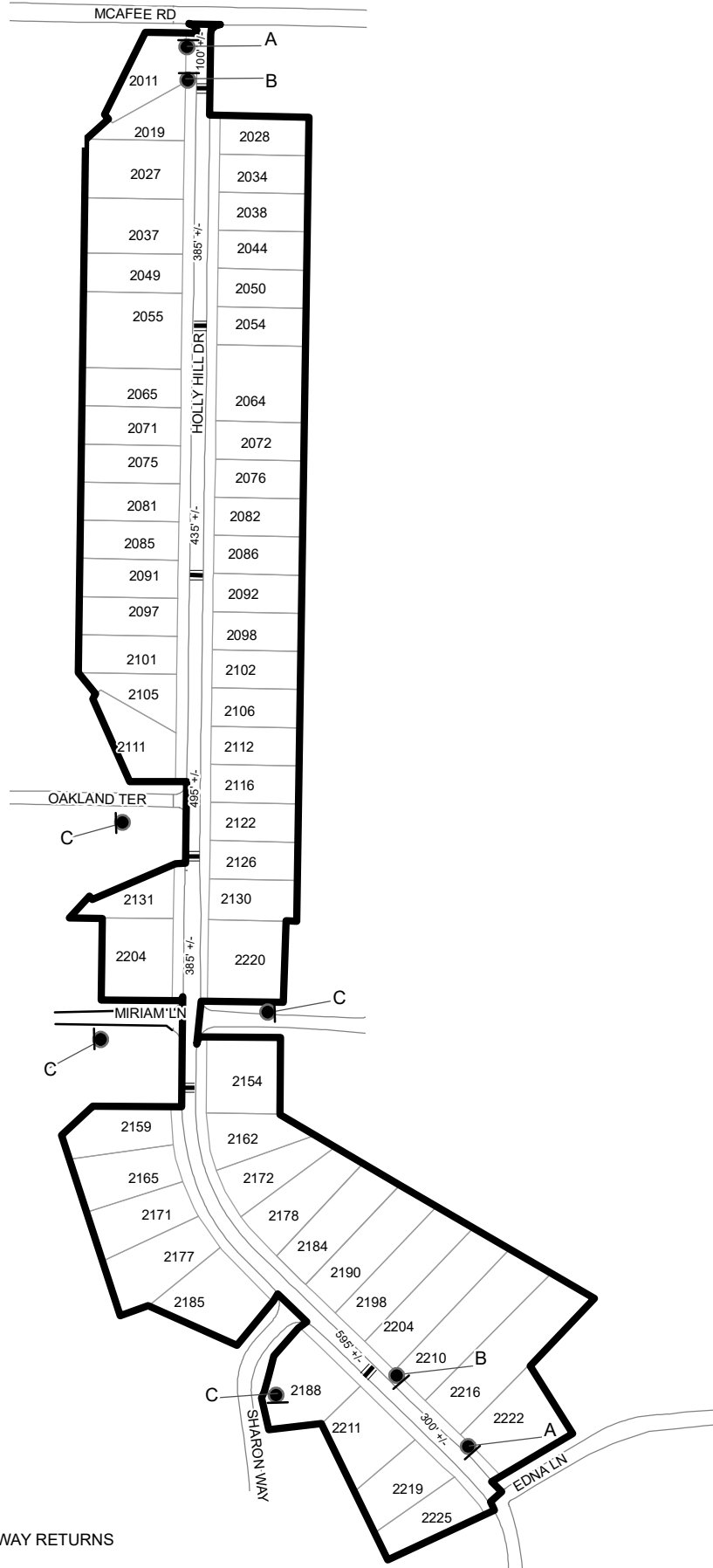

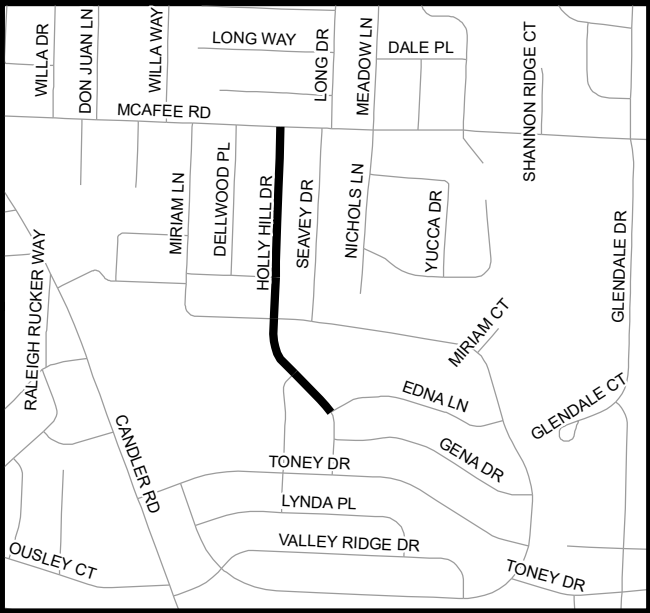

TRAFFIC CALMING DISTRICT 23-15-00

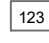

LEGEND

-  AFFECTED AREA
-  SPEED TABLES (6)
-  PARCEL BOUNDARY AND ADDRESS NUMBER
-  TRAFFIC CALMING DISTRICT SIGNS
-  SPEED HUMPS AHEAD SIGN AND ADVISORY 15 MPH SPEED PLAQUE
-  SPEED HUMP AHEAD SIGN, CROSS STREET, AND ADVISORY 15 MPH SPEED PLAQUE
-  123' +/- DISTANCE BETWEEN TRAFFIC CALMING MEASURES (CENTER TO CENTER) & DISTANCE BETWEEN TRAFFIC CALMING MEASURES AND END OF STREET

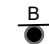
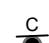
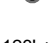
NOTES:
 1] NUMBER OF PARCELS IN AFFECTED AREA: 59
 2] STREET(S) IN AFFECTED AREA: HOLLY HILL DR, MIRIAM LN & SHARON WAY
 3] EDGE OF TRAFFIC CALMING MEASURE NOT TO ENCROACH WITHIN 5' OF DRIVEWAY RETURNS

DEKALB COUNTY
 TRANSPORTATION DIVISION
 TRAFFIC CALMING SECTION

DRAWN BY: AE
 REVIEWED BY:
 REVIEWED BY: AE
 REVIEWED BY:

SCALE: N.T.S.
 DATE: 10/24/2023

HOLLY HILL DRIVE
 DIST: 15 TH LAND LOT: 152
 COMMISSION DISTRICTS: 3 & 7