

# TRAFFIC CALMING DISTRICT 25-15-00

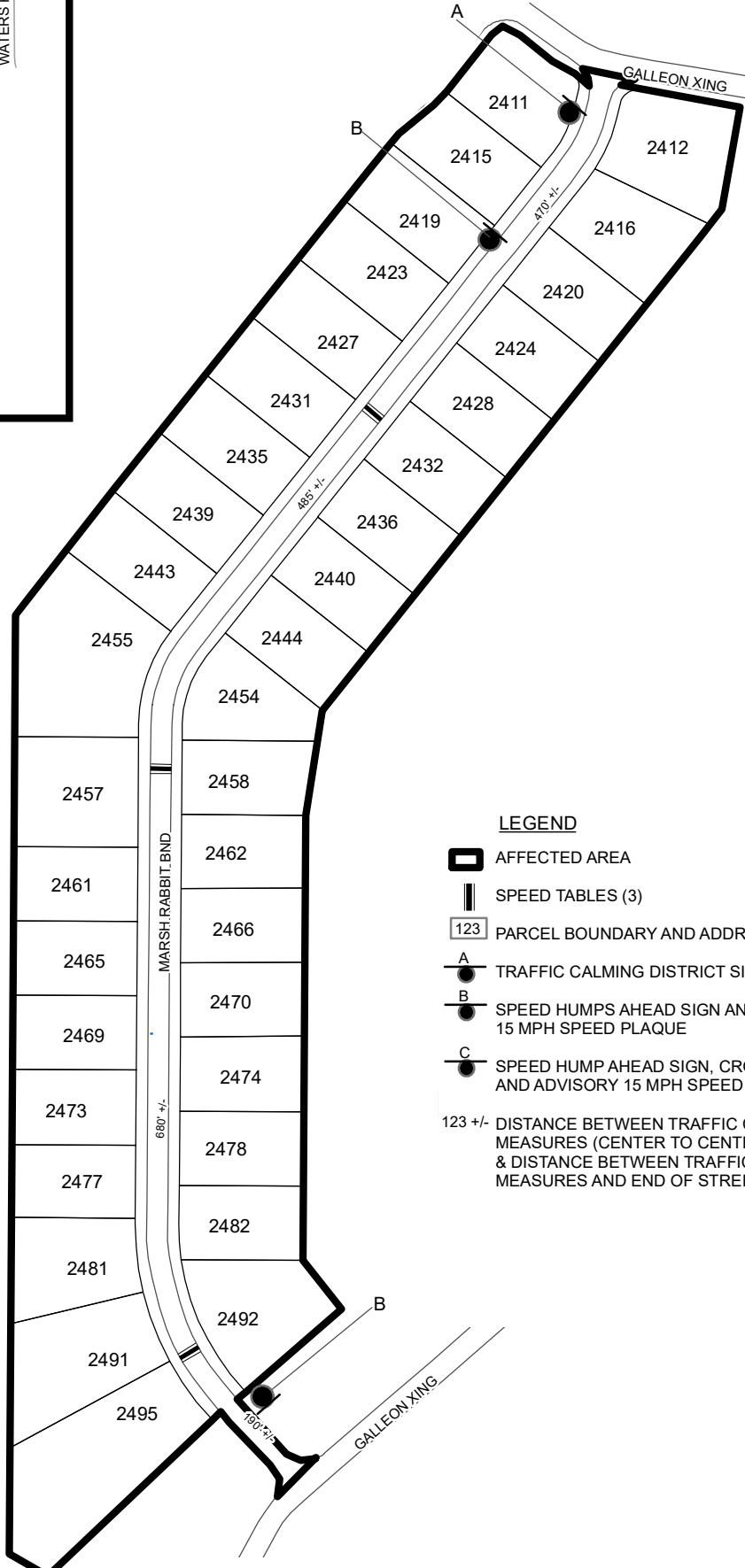
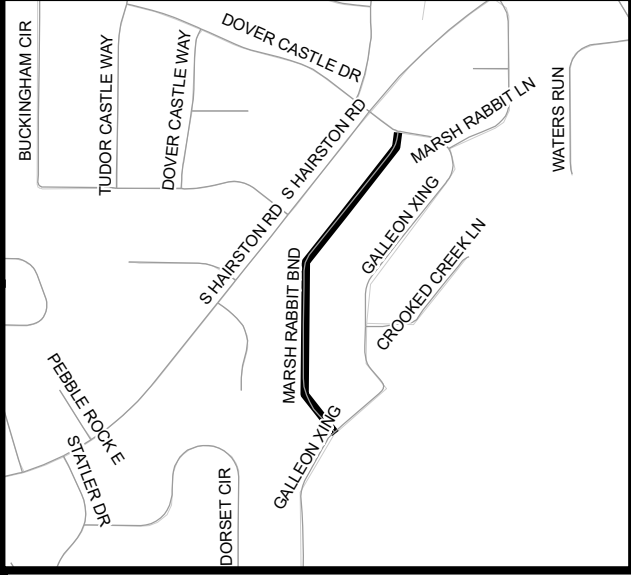

## LEGEND

- AFFECTED AREA
- SPEED TABLES (3)
- PARCEL BOUNDARY AND ADDRESS NUMBER
- TRAFFIC CALMING DISTRICT SIGNS
- SPEED HUMPS AHEAD SIGN AND ADVISORY 15 MPH SPEED PLAQUE
- SPEED HUMP AHEAD SIGN, CROSS STREET, AND ADVISORY 15 MPH SPEED PLAQUE
- 123 +/- DISTANCE BETWEEN TRAFFIC CALMING MEASURES (CENTER TO CENTER) & DISTANCE BETWEEN TRAFFIC CALMING MEASURES AND END OF STREET

## NOTES:

- 1] NUMBER OF PARCELS IN AFFECTED AREA: 37
- 2] STREET(S) IN AFFECTED AREA: MARSH RABBIT BEND
- 3] EDGE OF TRAFFIC CALMING MEASURE NOT TO ENCROACH WITHIN 5' OF DRIVEWAY RETURNS

DEKALB COUNTY  
TRANSPORTATION DIVISION  
TRAFFIC CALMING SECTION

DRAWN BY: AE  
REVIEWED BY: AE  
REVIEWED BY:  
REVIEWED BY:

SCALE: N.T.S.

Date: 5/29/2025

MARSH RABBIT BEND

DIST: 15 TH LAND LOTS: 129 & 160

COMMISSION DISTRICTS: 5 & 7