

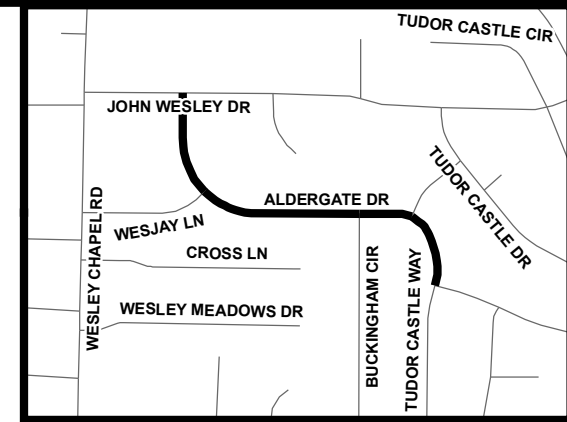

TRAFFIC CALMING DISTRICT 18-15-11

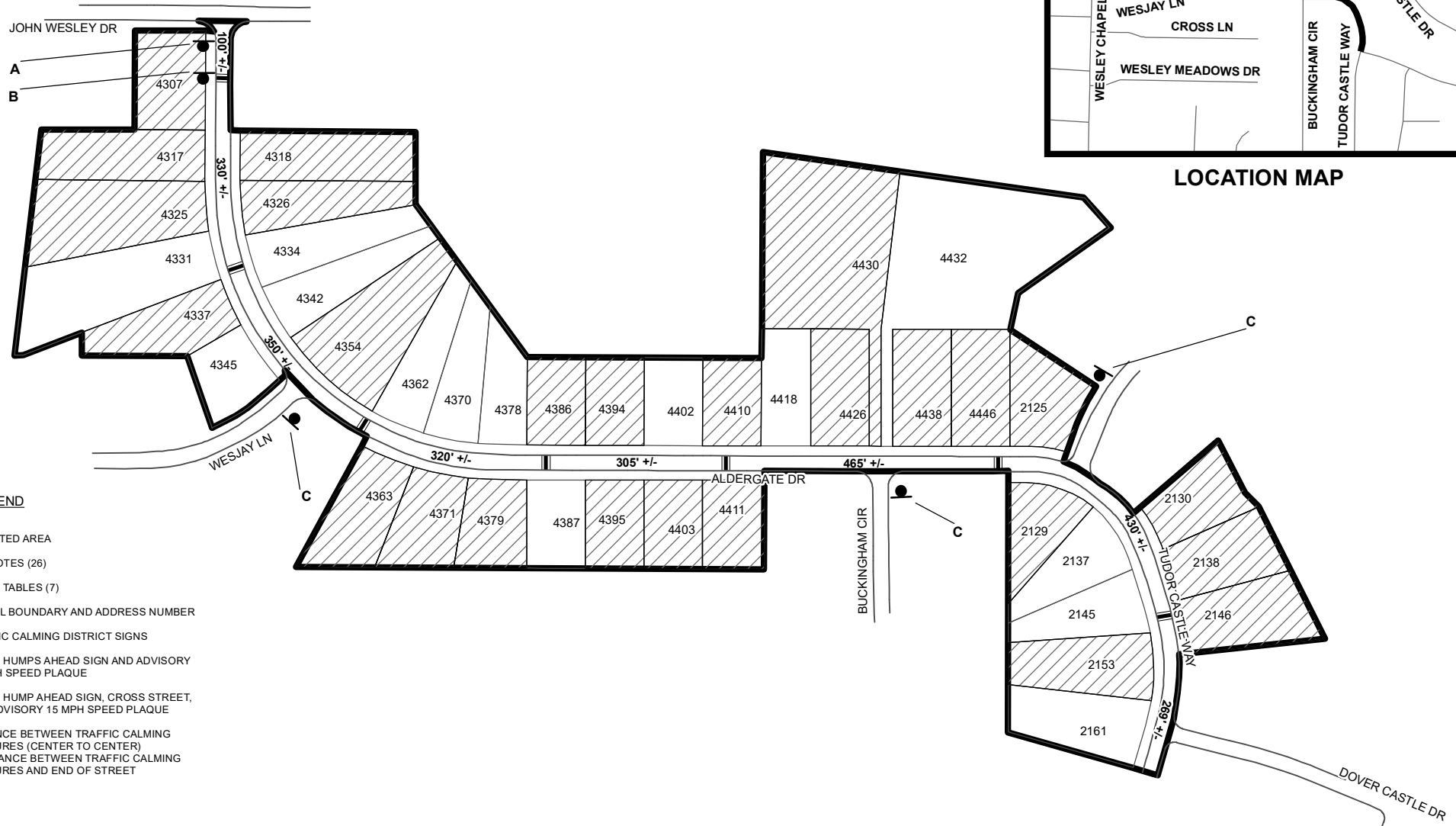

LOCATION MAP



LEGEND

- AFFECTED AREA
- YES VOTES (26)
- SPEED TABLES (7)
- PARCEL BOUNDARY AND ADDRESS NUMBER
- TRAFFIC CALMING DISTRICT SIGNS
- SPEED HUMPS AHEAD SIGN AND ADVISORY 15 MPH SPEED PLAQUE
- SPEED HUMP AHEAD SIGN, CROSS STREET, AND ADVISORY 15 MPH SPEED PLAQUE
- 123 +/- DISTANCE BETWEEN TRAFFIC CALMING MEASURES (CENTER TO CENTER) & DISTANCE BETWEEN TRAFFIC CALMING MEASURES AND END OF STREET

NOTES:

- 1] NUMBER OF PARCELS IN AFFECTED AREA: 40
- 2] STREET(S) IN AFFECTED AREA: ALDERGATE DR, TUDOR CASTLE WAY
- 3] EDGE OF TRAFFIC CALMING MEASURE NOT TO ENCROACH WITHIN 5' OF DRIVEWAY RETURNS

DEKALB COUNTY
TRANSPORTATION DIVISION
TRAFFIC CALMING SECTION

DRAWN BY: CH
REVIEWED BY: CH
REVIEWED BY: AE
REVIEWED BY: PGK

SCALE: N.T.S.

Date: 12/11/2018

ALDERGATE DR & TUDOR CASTLE WAY

DIST: 15 TH LAND LOT: 159

COMMISSION DISTRICTS: 5 & 7