

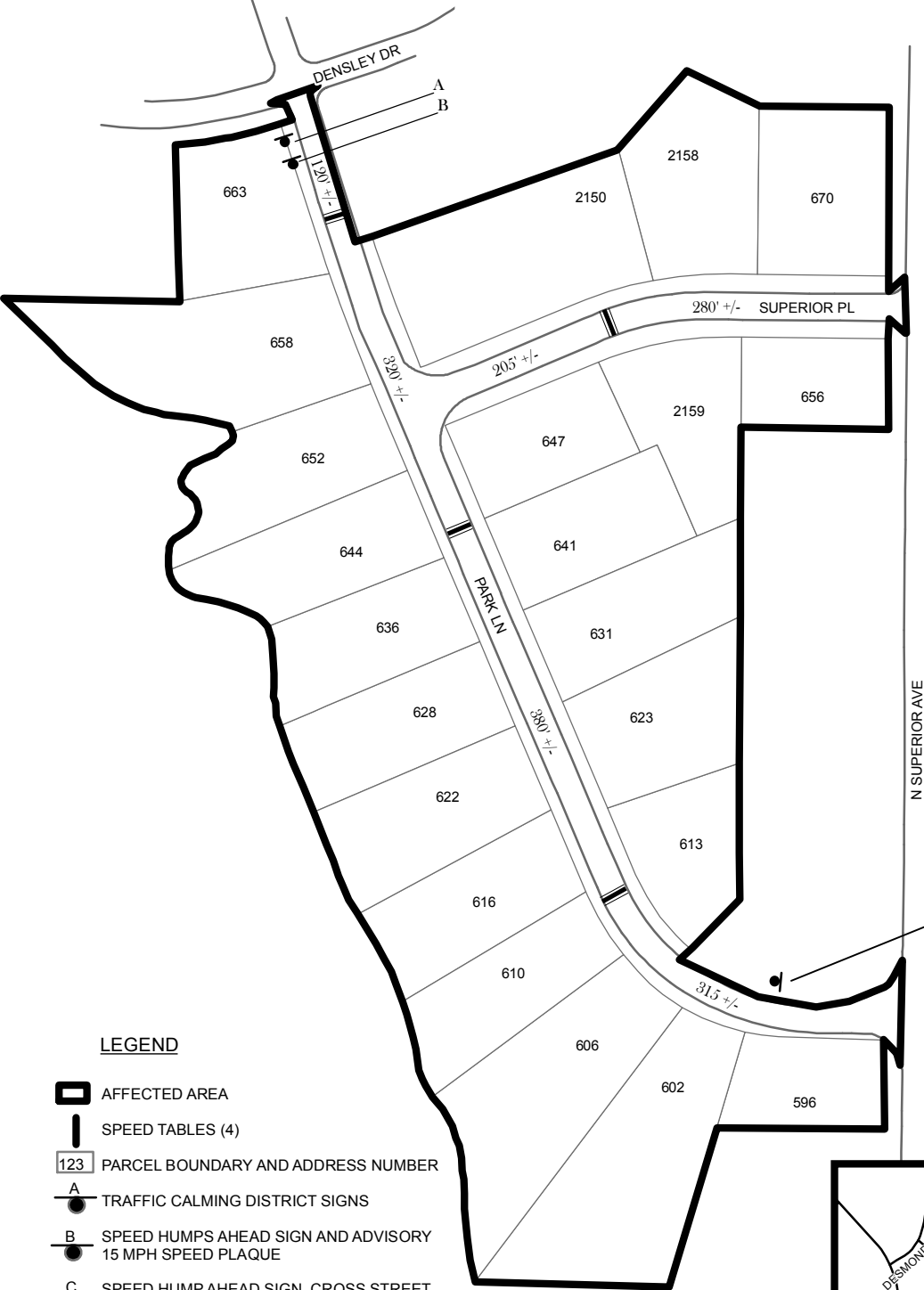



# TRAFFIC CALMING DISTRICT 18-18-00

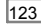

### LEGEND

-  AFFECTED AREA
  -  SPEED TABLES (4)
  -  PARCEL BOUNDARY AND ADDRESS NUMBER
  -  TRAFFIC CALMING DISTRICT SIGNS
  -  SPEED HUMPS AHEAD SIGN AND ADVISORY 15 MPH SPEED PLAQUE
  -  SPEED HUMP AHEAD SIGN, CROSS STREET, AND ADVISORY 15 MPH SPEED PLAQUE
- 123 +/- DISTANCE BETWEEN TRAFFIC CALMING MEASURES (CENTER TO CENTER) & DISTANCE BETWEEN TRAFFIC CALMING MEASURES AND END OF STREET

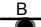
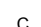
### NOTES:

- 1) NUMBER OF PARCELS IN AFFECTED AREA: 22
- 2) STREET(S) IN AFFECTED AREA: PARK LN, SUPERIOR PL, NORTH SUPERIOR AVE, DENSLEY DR
- 3) EDGE OF TRAFFIC CALMING MEASURE NOT TO ENCROACH WITHIN 5' OF DRIVEWAY RETURNS

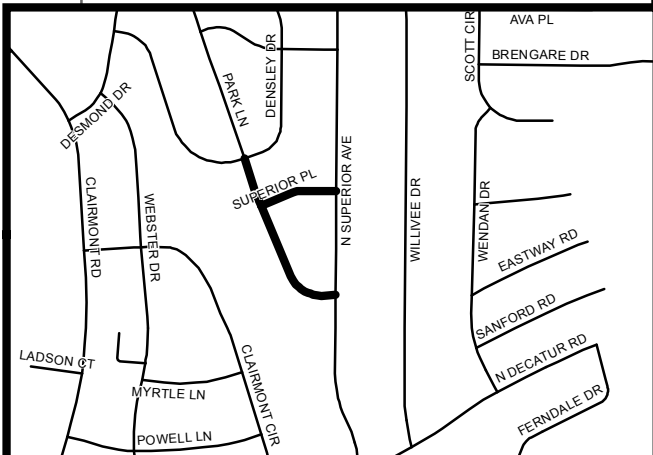

DEKALB COUNTY  
TRANSPORTATION DIVISION  
TRAFFIC CALMING SECTION

DRAWN BY: CH  
REVIEWED BY: CH  
REVIEWED BY: AE  
REVIEWED BY: PGK

SCALE: NTS  
Date: 1/9/2018

PARK LN & SUPERIOR PL  
DIST: 18TH LAND LOT: 51 & 60  
COMMISSION DISTRICTS: 2 & 6