

TRAFFIC CALMING DISTRICT 25-15-00

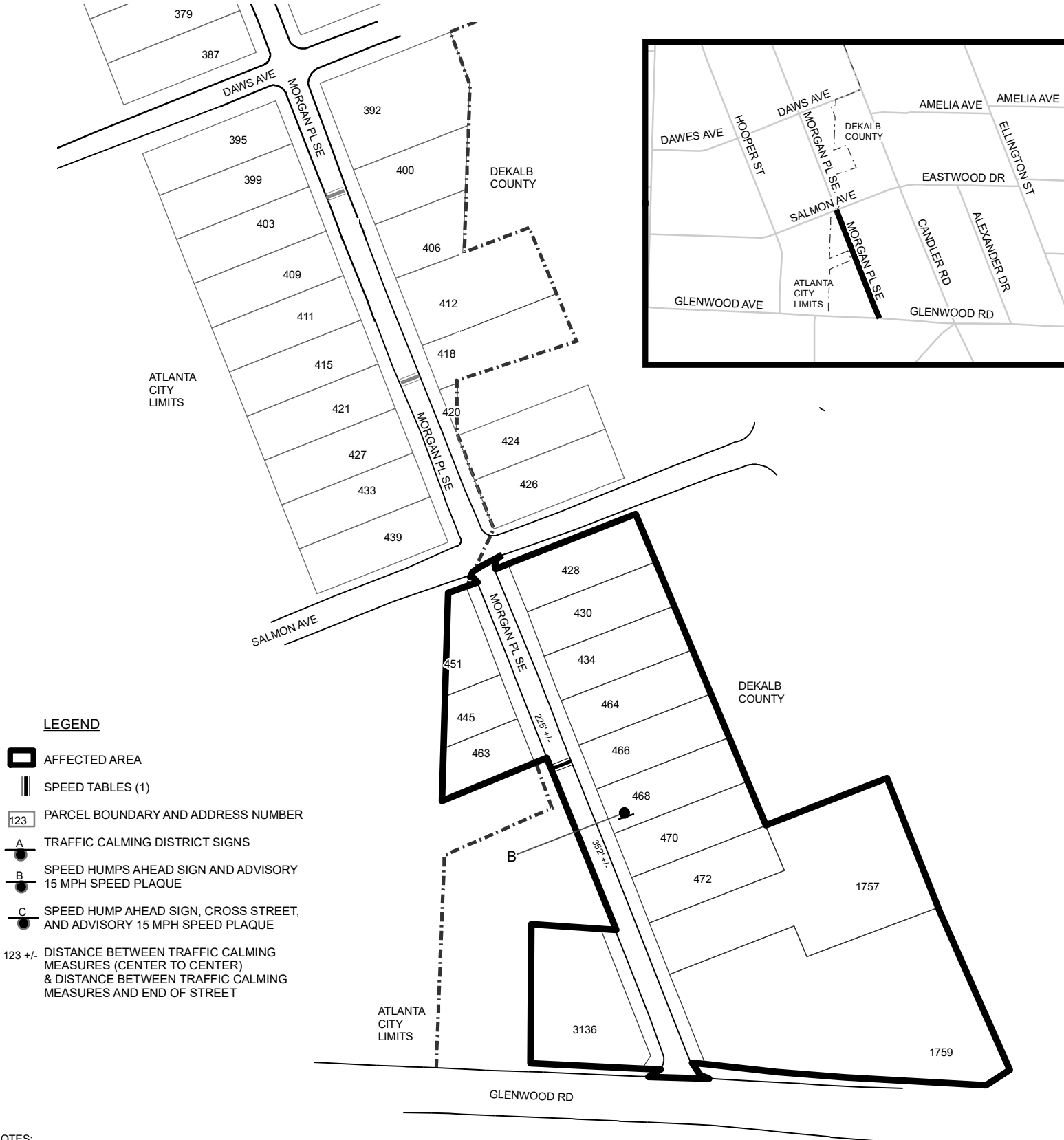

NOTES:

- 1) NUMBER OF PARCELS IN AFFECTED AREA: 14
- 2) STREET(S) IN AFFECTED AREA: MORGAN PL, CANDLER RD & GLENWOOD RD
- 3) EDGE OF TRAFFIC CALMING MEASURE NOT TO ENCROACH WITHIN 5' OF DRIVEWAY RETURNS

DEKALB COUNTY
TRANSPORTATION DIVISION
TRAFFIC CALMING SECTION

DRAWN BY: AE
REVIEWED BY: AE
REVIEWED BY:
REVIEWED BY:

SCALE: N.T.S.

Date: 9/23/2025

MORGAN PLACE
DIST: 15 TH LAND LOT: 183
COMMISSION DISTRICTS: 3 & 7