

TRAFFIC CALMING DISTRICT 17-18-00

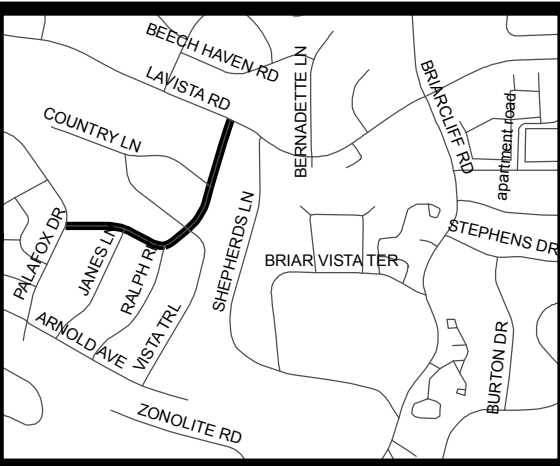

- LEGEND**
- AFFECTED AREA
 - SPEED TABLES (7)
 - PARCEL BOUNDARY AND ADDRESS NUMBER
 - A TRAFFIC CALMING DISTRICT SIGNS
 - B SPEED HUMPS AHEAD SIGN AND ADVISORY 15 MPH SPEED PLAQUE
 - C SPEED HUMPS AHEAD SIGN, CROSS STREET, AND ADVISORY 15 MPH SPEED PLAQUE
 - D SPEED HUMP SIGN AND DOWNWARD DIAGONAL LEFT ARROW PLAQUE
 - 123 +/- DISTANCE BETWEEN TRAFFIC CALMING MEASURES (CENTER TO CENTER) & DISTANCE BETWEEN TRAFFIC CALMING MEASURES AND END OF STREET

- NOTES:**
- 1] NUMBER OF PARCELS IN AFFECTED AREA: 46
 - 2] STREET(S) IN AFFECTED AREA: WOODLAND HILLS DRIVE, LAVISTA ROAD, & PALAFOX DRIVE
 - 3] EDGE OF TRAFFIC CALMING MEASURE NOT TO ENCROACH WITHIN 5' OF DRIVEWAY RETURNS

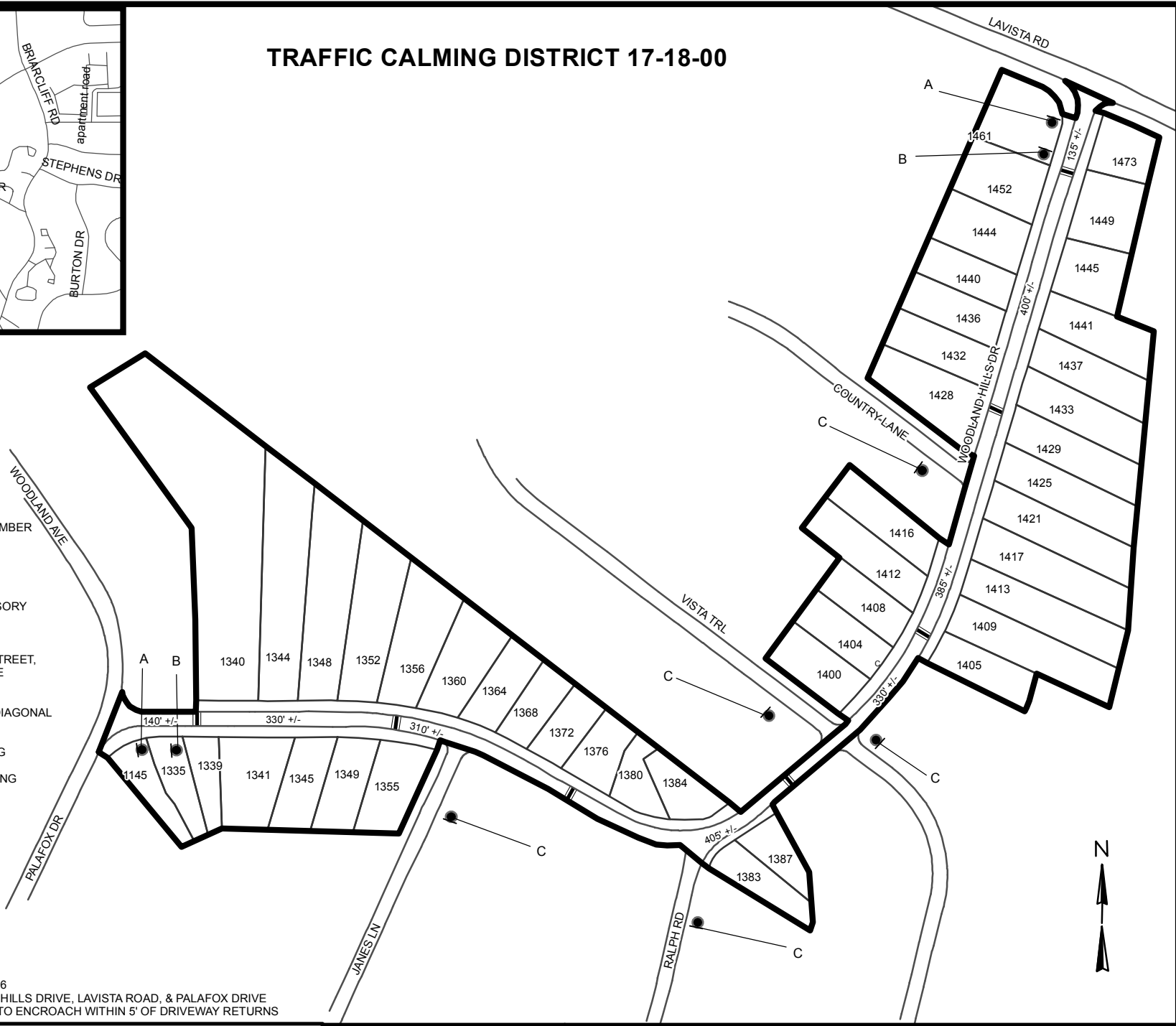

DEKALB COUNTY
TRANSPORTATION DIVISION
TRAFFIC CALMING SECTION

DRAWN BY: AE
REVIEWED BY: PGK
REVIEWED BY:
REVIEWED BY:

SCALE: N.T.S.
Date: 12/5/2017

WOODLAND HILLS DRIVE
DIST: 18 TH LAND LOT: 107 & 108
COMMISSION DISTRICTS: 2 & 6