

# TRAFFIC CALMING DISTRICT 19-16-00 (SECTION 1)

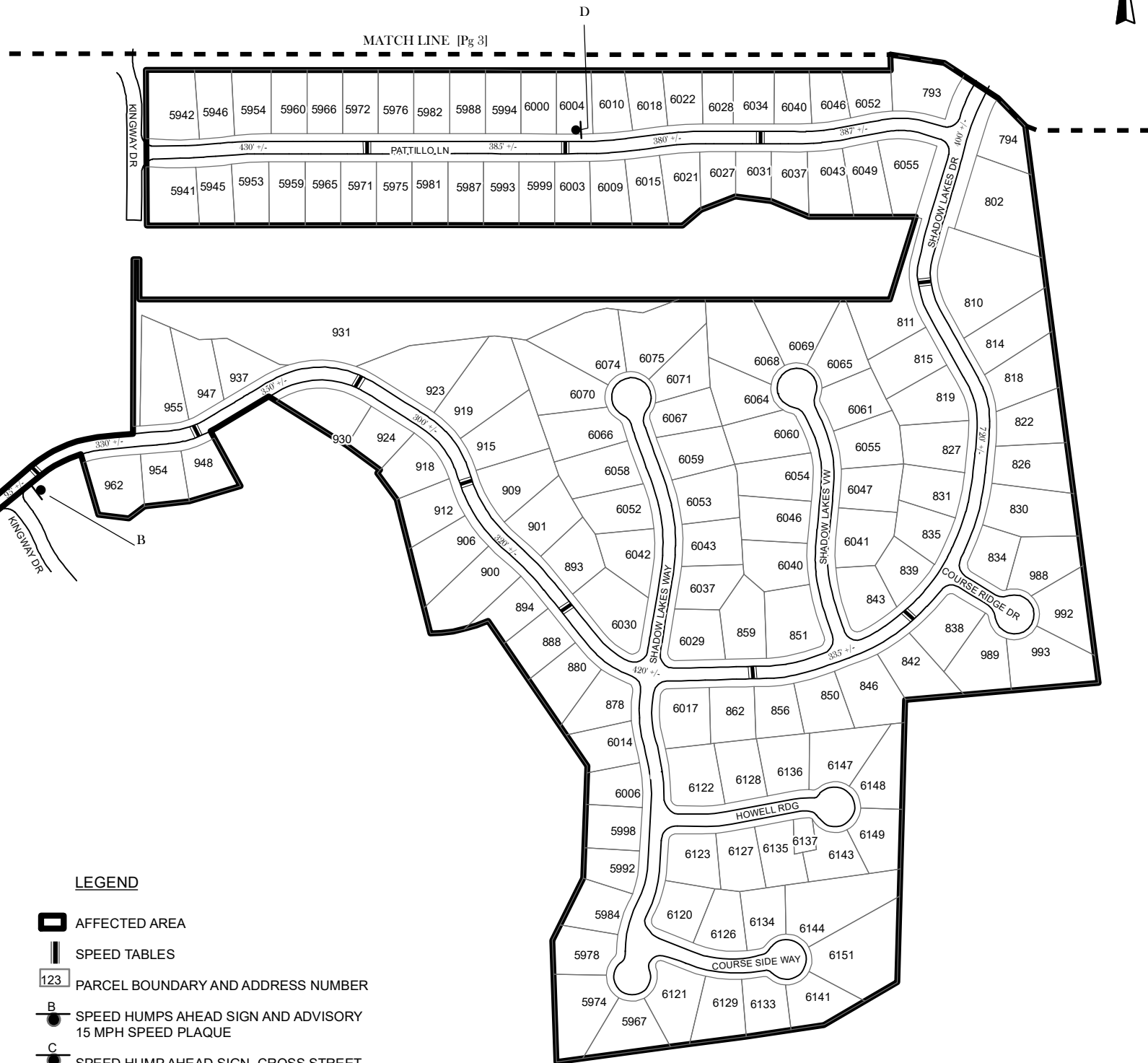

**LEGEND**

- AFFECTED AREA**
- SPEED TABLES**
- PARCEL BOUNDARY AND ADDRESS NUMBER**
- SPEED HUMPS AHEAD SIGN AND ADVISORY 15 MPH SPEED PLAQUE**
- SPEED HUMP AHEAD SIGN, CROSS STREET, AND ADVISORY 15 MPH SPEED PLAQUE**
- SPEED HUMP SIGN AND DIAGONAL DOWNWARD ARROW PLAQUE**

123 +/- DISTANCE BETWEEN TRAFFIC CALMING MEASURES (CENTER TO CENTER) & DISTANCE BETWEEN TRAFFIC CALMING MEASURES AND END OF STREET

DEKALB COUNTY TRANSPORTATION DIVISION TRAFFIC CALMING SECTION	DRAWN BY: CH	SCALE: N.T.S.	SHADOW LAKES DR & PATTILLO LN (SECTION 1) DIST: 16 TH LAND LOT: 66 & 95
	REVIEWED BY: CH		
	REVIEWED BY: AE	Date: 11/19/2018	COMMISSION DISTRICTS: 4 & 7 Pg 2 of 3
	REVIEWED BY: PGK		