

TRAFFIC CALMING DISTRICT 19-18-00

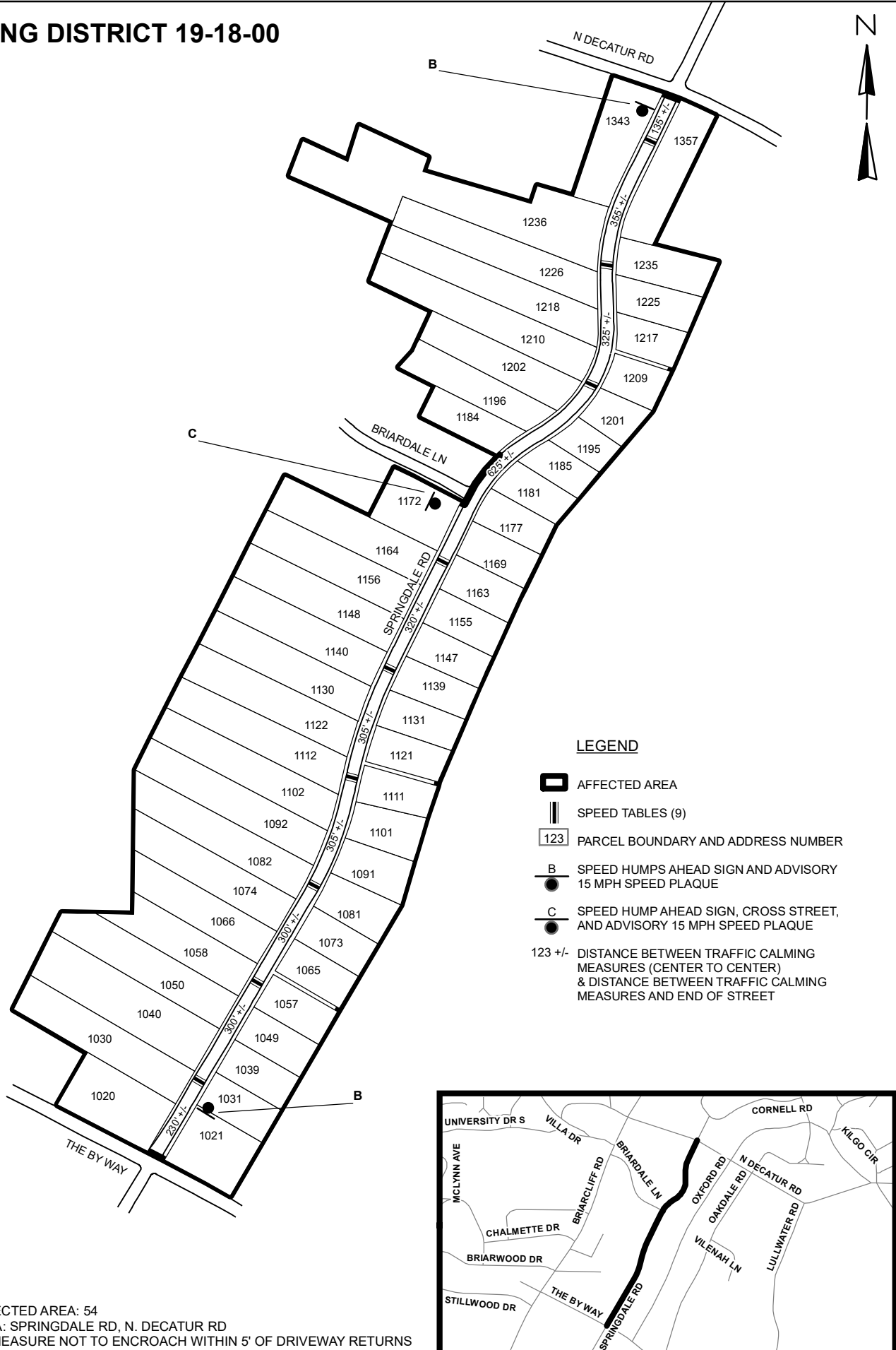

- LEGEND**
- AFFECTED AREA
 - SPEED TABLES (9)
 - PARCEL BOUNDARY AND ADDRESS NUMBER
 - SPEED HUMPS AHEAD SIGN AND ADVISORY 15 MPH SPEED PLAQUE
 - SPEED HUMP AHEAD SIGN, CROSS STREET, AND ADVISORY 15 MPH SPEED PLAQUE
 - 123 +/- DISTANCE BETWEEN TRAFFIC CALMING MEASURES (CENTER TO CENTER) & DISTANCE BETWEEN TRAFFIC CALMING MEASURES AND END OF STREET

NOTES:

- 1] NUMBER OF PARCELS IN AFFECTED AREA: 54
- 2] STREET(S) IN AFFECTED AREA: SPRINGDALE RD, N. DECATUR RD
- 3] EDGE OF TRAFFIC CALMING MEASURE NOT TO ENCROACH WITHIN 5' OF DRIVEWAY RETURNS

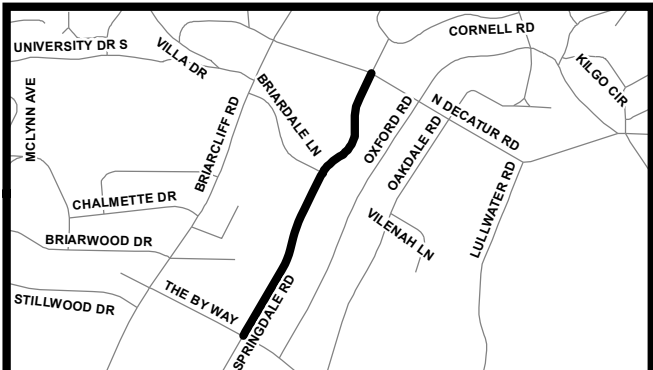

DEKALB COUNTY TRANSPORTATION DIVISION TRAFFIC CALMING SECTION	DRAWN BY: CH	SCALE: N.T.S.	SPRINGDALE RD DIST: 18 TH LAND LOT: 02 & 54 COMMISSION DISTRICTS: 2 & 6
	REVIEWED BY: CH		
	REVIEWED BY:	Date: 10/22/2019	
	REVIEWED BY:		