

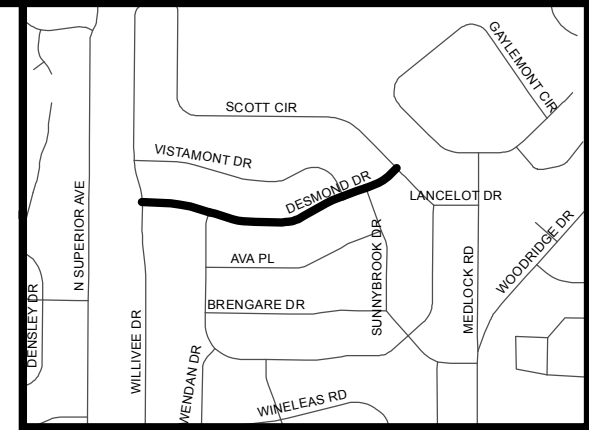





# TRAFFIC CALMING DISTRICT 17-18-12



LOCATION MAP

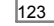

## LEGEND

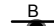
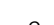
-  AFFECTED AREA
  -  YES VOTES (28)
  -  SPEED TABLES (5)
  -  123 PARCEL BOUNDARY AND ADDRESS NUMBER
  -  A TRAFFIC CALMING DISTRICT SIGNS
  -  B SPEED HUMPS AHEAD SIGN AND ADVISORY 15 MPH SPEED PLAQUE
  -  C SPEED HUMP AHEAD SIGN, CROSS STREET, AND ADVISORY 15 MPH SPEED PLAQUE
- 123 +/- DISTANCE BETWEEN TRAFFIC CALMING MEASURES (CENTER TO CENTER) & DISTANCE BETWEEN TRAFFIC CALMING MEASURES AND END OF STREET

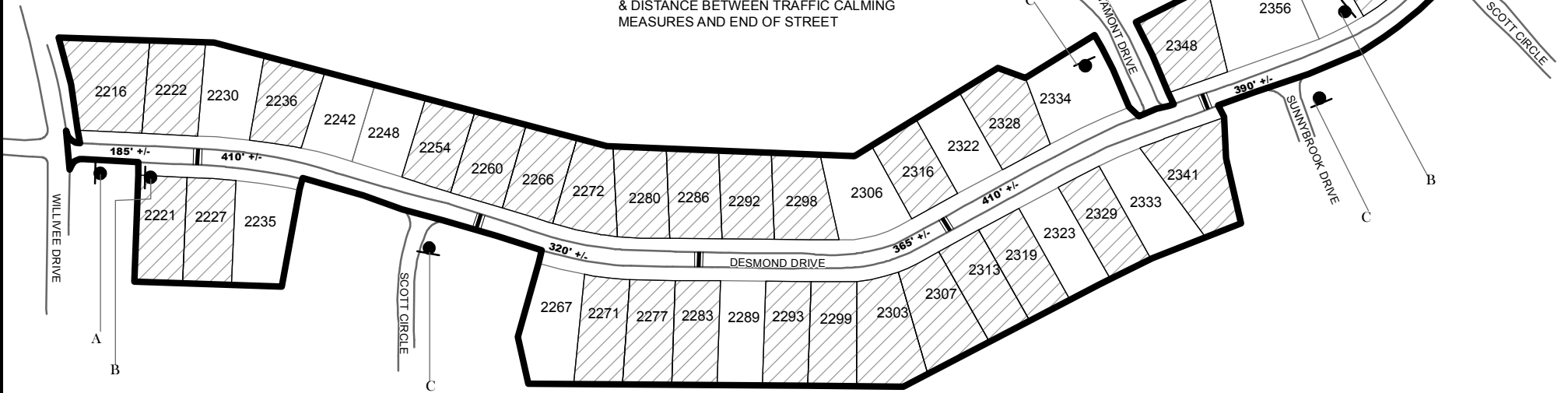

NOTES:

- 1) NUMBER OF PARCELS IN AFFECTED AREA: 41
- 2) STREET(S) IN AFFECTED AREA: DESMOND DRIVE & SCOTT CIRCLE
- 3) EDGE OF TRAFFIC CALMING MEASURE NOT TO ENCROACH WITHIN 5' OF DRIVEWAY RETURNS

|  |                  |                  |   |
|--|------------------|------------------|---|
| <b>DEKALB COUNTY<br/>TRANSPORTATION DIVISION<br/>TRAFFIC CALMING SECTION</b> | DRAWN BY: AE     | SCALE: N.T.S.    | DESMOND DRIVE<br><br>DIST: 18 TH LAND LOTS: 61<br><br>COMMISSION DISTRICTS: 2 & 6 |
|  | REVIEWED BY: PGK |                  |   |
|  | REVIEWED BY:     | Date: 12/12/2017 |   |
|  | REVIEWED BY:     |                  |   |