

TRAFFIC CALMING DISTRICT 24-15-00

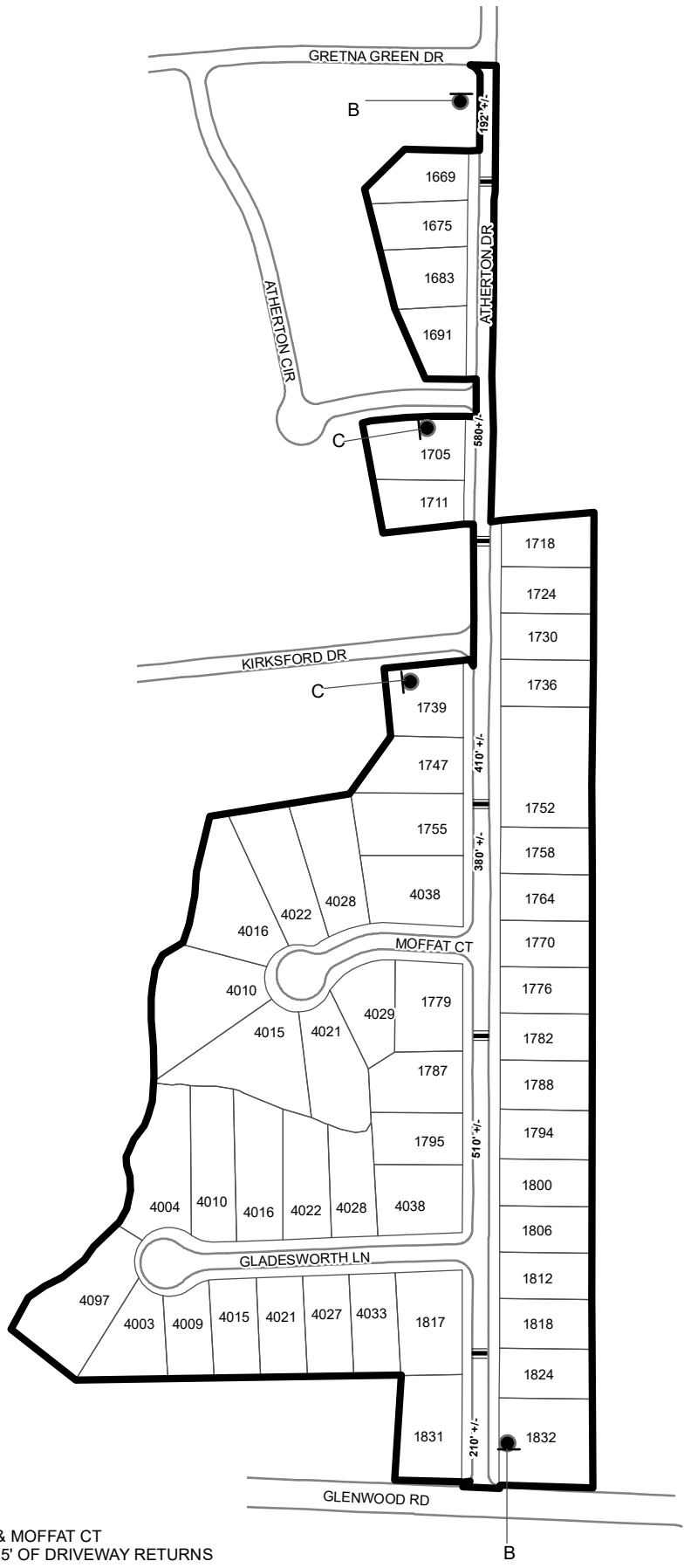
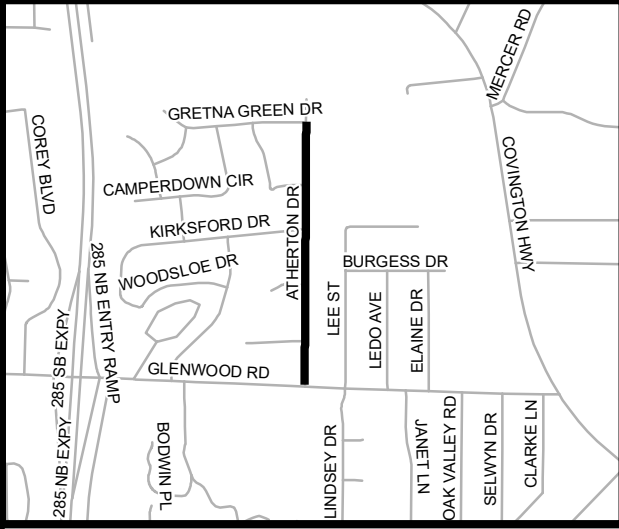

LEGEND

- AFFECTED AREA
 - SPEED TABLES (5)
 - PARCEL BOUNDARY AND ADDRESS NUMBER
 - TRAFFIC CALMING DISTRICT SIGNS
 - SPEED HUMPS AHEAD SIGN AND ADVISORY 15 MPH SPEED PLAQUE
 - SPEED HUMP AHEAD SIGN, CROSS STREET, AND ADVISORY 15 MPH SPEED PLAQUE
- 123 +/- DISTANCE BETWEEN TRAFFIC CALMING MEASURES (CENTER TO CENTER) & DISTANCE BETWEEN TRAFFIC CALMING MEASURES AND END OF STREET

NOTES:

- 1] NUMBER OF PARCELS IN AFFECTED AREA: 53
- 2] STREET(S) IN AFFECTED AREA: ATHERTON DR, GLADESWORTH LN & MOFFAT CT
- 3] EDGE OF TRAFFIC CALMING MEASURE NOT TO ENCROACH WITHIN 5' OF DRIVEWAY RETURNS

DEKALB COUNTY
TRANSPORTATION DIVISION
TRAFFIC CALMING SECTION

DRAWN BY: AE
REVIEWED BY: AE
REVIEWED BY: AE
REVIEWED BY:

SCALE: N.T.S.
Date: 3/26/2024

ATHERTON DRIVE
DIST: 15TH LAND LOT: 189
COMMISSION DISTRICTS: 5 & 7