

May 25, 2017

To: DeKalb County, Ga  
From: Michael and Janet Montgomery  
Re: Request to purchase surplus property

We would like to purchase the following property, currently owned by DeKalb County, GA, which is listed as a surplus property:

Parcel ID - 1804603127

Address - 3190 Zion Street, Scottdale 30079

Petitioner's Name and Mailing Address:

Michael Montgomery

Janet Montgomery

150 Pinecrest Ave.

Decatur GA, 30030

Properties owned in Dekalb County by the petitioner:

(1) Residence - 150 Pinecrest Ave, Decatur, GA, 30030

(2) Property - 274 N. Clarendon Ave., Scottdale, GA, 30079

Code Violations - no known

We recently purchased the property at 3188 Zion Street and would like to add this lot to that property in order to increase the size and improve the appearance of our lot. We plan to build one single family home on the combined lots.

Enclosed find a cashiers check for \$75.00. Please contact us if you need any additional information.



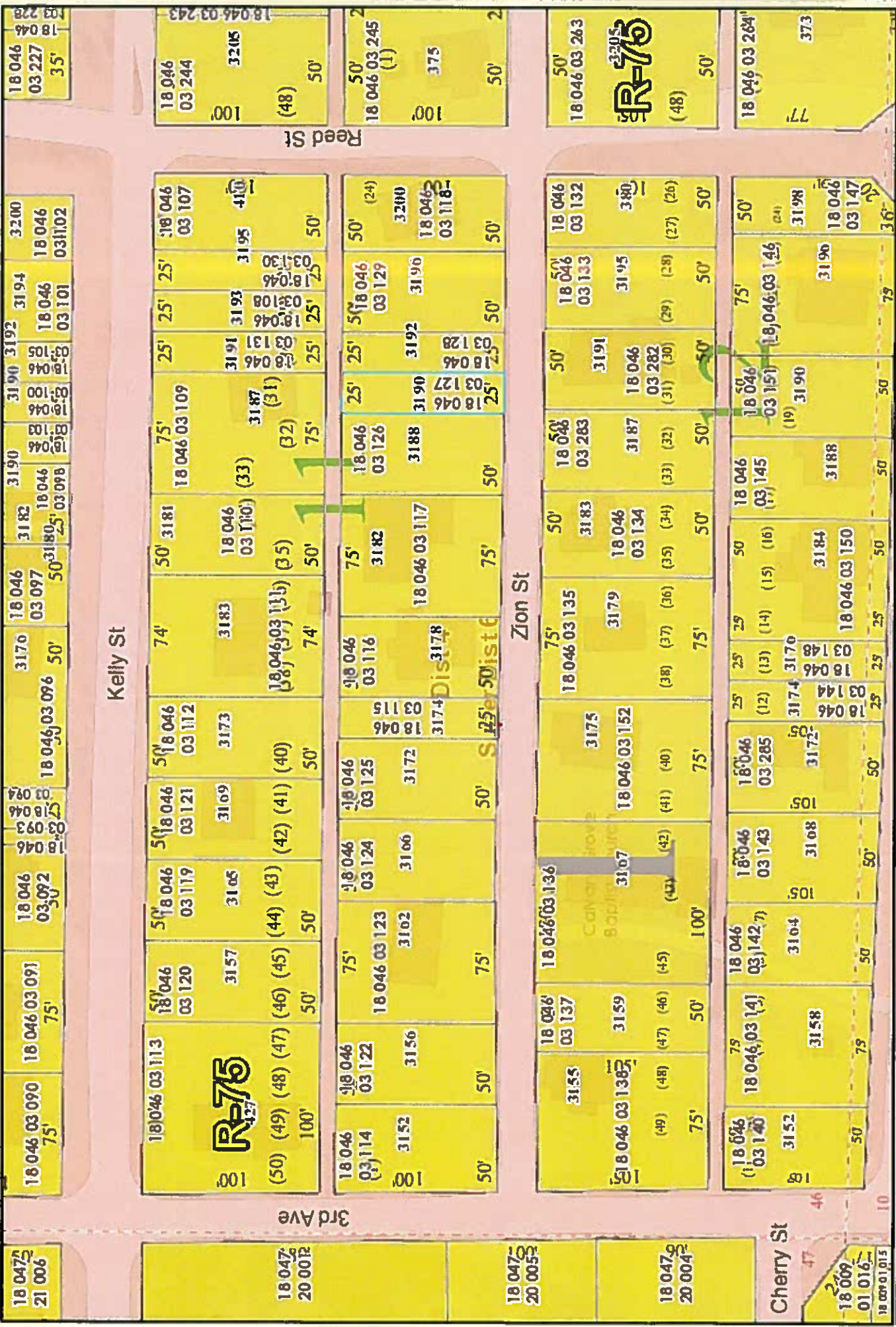

**3190 Zion Street**

**Date Printed: 7/18/2019**

**Scale:** 0 0.005 0.01 0.02 0.03 0.04 FT

**North Arrow:** N

**Disclaimer:**  
 Dekalb County GIS Disclaimer  
 The maps and data on this map were prepared by Dekalb County GIS. The maps and data are subject to change without notice. While Dekalb County strives to provide accurate and up-to-date information, the information is provided "as is" without warranty, representation or guarantee of any kind as to the content, accuracy, timeliness or completeness of any of the database information provided herein. Dekalb County explicitly disclaims all representations and warranties, including, without limitation, the implied warranties of merchantability and fitness for a particular purpose. In no event shall Dekalb County be liable for any special, indirect, or consequential damages whatsoever resulting from the use, use, or profits, whether in an action of contract, negligence, or other actions, arising out of or in connection with the use of the maps and/or data herein provided. The maps and data are for illustration purposes only and should not be relied upon for any reason. The maps and data are not necessarily accurate to surveying or engineering standards created or used as a legal description. The areas depicted by maps and data are approximate, and are not necessarily accurate to surveying or engineering standards.