

STATE OF GEORGIA PLAT ACT CERTIFICATION

THIS SURVEY WAS PREPARED IN CONFORMITY WITH THE TECHNICAL STANDARDS FOR PROPERTY SURVEYS IN GEORGIA AS SET FORTH IN CHAPTER 180-7 OF THE RULES OF THE GEORGIA BOARD OF REGISTRATION FOR PROFESSIONAL ENGINEERS AND LAND SURVEYORS AND AS SET FORTH IN THE GEORGIA PLAT ACT O.C.G.A. 15-6-67. I CERTIFY THAT THIS SURVEY WAS DONE UNDER MY SUPERVISION USING A TOPCON GTS 233W TOTAL STATION WITH AN ANGULAR ERROR OF 1 SECOND PER STATION. THE TRAVERSE UPON WHICH THIS PLAT IS BASED, HAS BEEN CALCULATED FOR CLOSURE BY THE LEAST SQUARE RULE AND IS FOUND TO BE ACCURATE WITHIN ONE FOOT IN 20,000+ FEET. THE ADJUSTED ACCURACY OF THIS PLAT IS ONE FOOT IN 50,000+ FEET.

N/F
SNAPPINGER BP LLC
DB 22799 PG 408
ZONING M

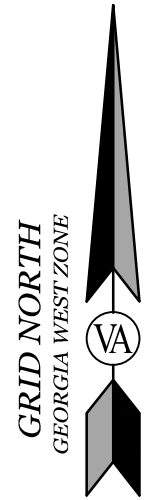

R/W ABANDONMENT SURVEY FOR:

MARSHALLS OF MA, INC.

LAND LOTS 26 AND 39 16TH DISTRICT DEKALB COUNTY, GEORGIA



VALENTINO & ASSOCIATES, INC.
LAND SURVEYORS
1280 WINCHESTER PARKWAY
SUITE 243
SMYRNA, GEORGIA 30080
PHONE: (770) 438-0015
FAX: (770) 435-6050
WEB: VALENTINOSURVEY.COM
STATE OF GEORGIA LAND SURVEYING FIRM LICENSE NO. LSF000794

REVISIONS

NO.	DATE	DESCRIPTION

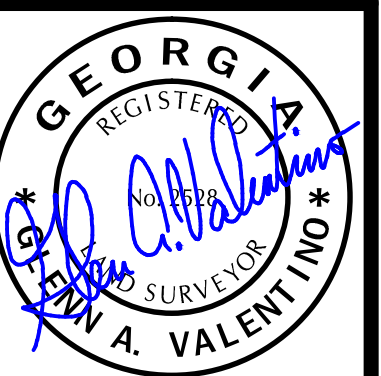

SCALE: 1" = 40'
DATE: 8/1/2016
JOB NUMBER: 16-042
FILE NUMBER: 16-042
PLOTTED: 8/1/2016

R/W ABANDONMENT SURVEY

SHEET
1 OF 1

