

TRAFFIC CALMING DISTRICT 22-16-00

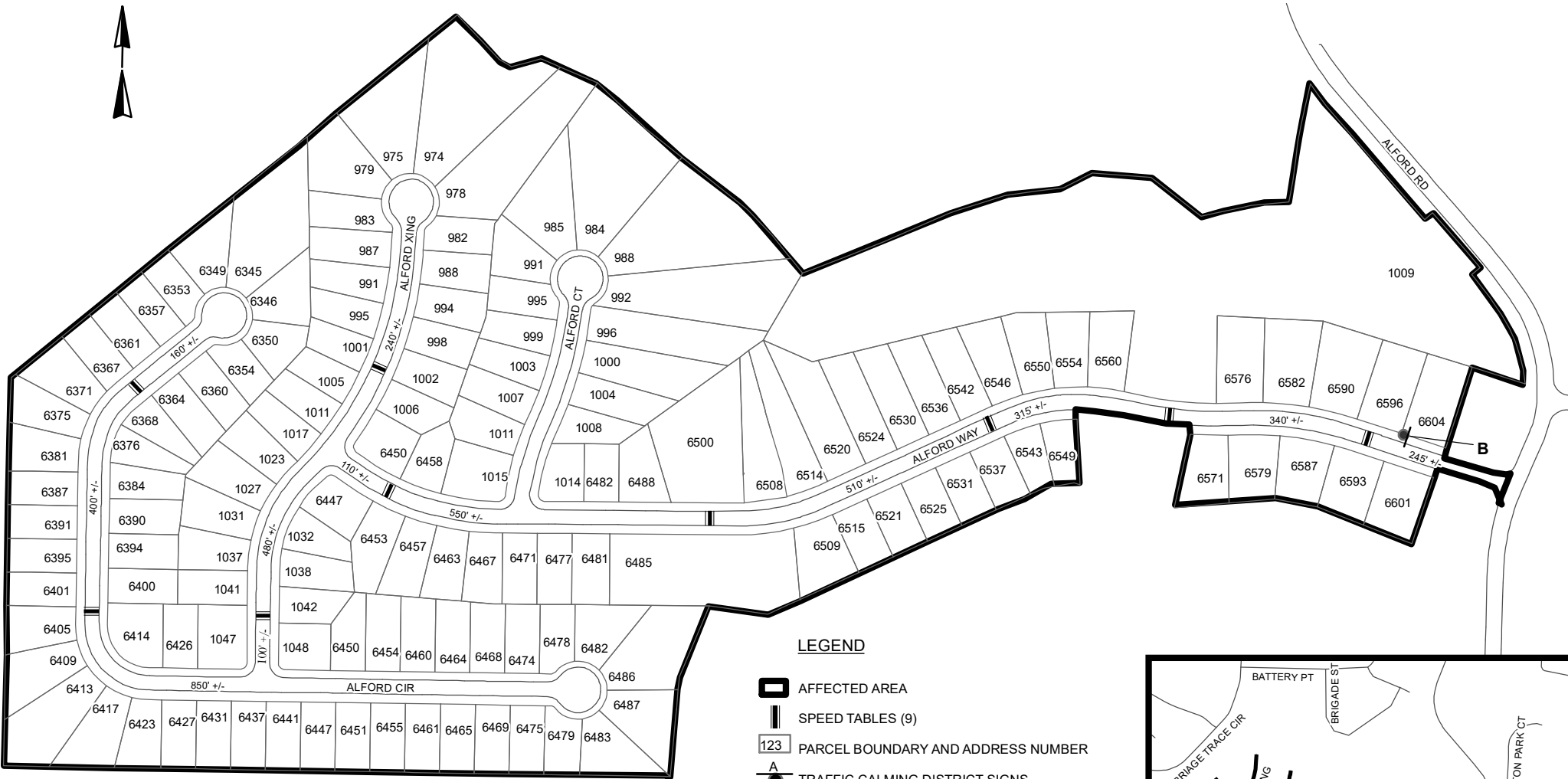

- NOTES:**
- 1] NUMBER OF PARCELS IN AFFECTED AREA: 142
 - 2] STREET(S) IN AFFECTED AREA: ALFORD WAY, ALFORD CIR, ALFORD CROSSING, ALFORT CT, & ALFORD RD
 - 3] EDGE OF TRAFFIC CALMING MEASURE NOT TO ENCROACH WITHIN 5' OF DRIVEWAY RETURNS

LEGEND

- AFFECTED AREA
- SPEED TABLES (9)
- PARCEL BOUNDARY AND ADDRESS NUMBER
- TRAFFIC CALMING DISTRICT SIGNS
- SPEED HUMPS AHEAD SIGN AND ADVISORY 15 MPH SPEED PLAQUE
- SPEED HUMP AHEAD SIGN, CROSS STREET, AND ADVISORY 15 MPH SPEED PLAQUE
- 123 +/- DISTANCE BETWEEN TRAFFIC CALMING MEASURES (CENTER TO CENTER) & DISTANCE BETWEEN TRAFFIC CALMING MEASURES AND END OF STREET

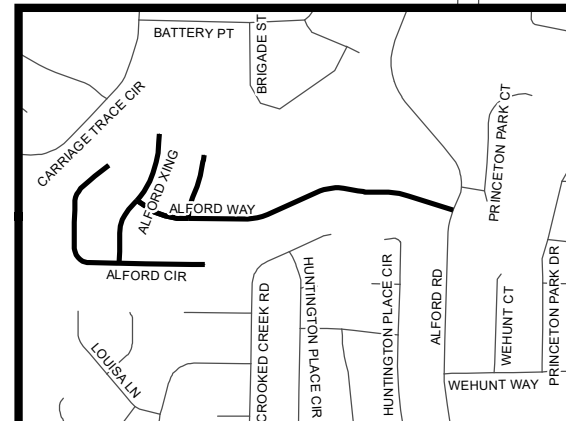

**DEKALB COUNTY
TRANSPORTATION DIVISION
TRAFFIC CALMING SECTION**

DRAWN BY: AE

REVIEWED BY: AE

REVIEWED BY:

REVIEWED BY:

SCALE: N.T.S.

Date: 2/8/2022

ALFORD WAY, ALFORD CIRCLE & ALFORD CROSSING

DIST: 16 TH LAND LOT: 127

COMMISSION DISTRICTS: 5 & 7