









# TRAFFIC CALMING DISTRICT 20-18-13



## LEGEND

-  AFFECTED AREA
-  YES VOTES (44)
-  SPEED TABLES (6)
-  STRIPING
-  123 PARCEL BOUNDARY AND ADDRESS NUMBER
-  A TRAFFIC CALMING DISTRICT SIGNS
-  B SPEED HUMPS AHEAD SIGN AND ADVISORY 15 MPH SPEED PLAQUE
-  C SPEED HUMP AHEAD SIGN, CROSS STREET, AND ADVISORY 15 MPH SPEED PLAQUE
- 123 +/- DISTANCE BETWEEN TRAFFIC CALMING MEASURES (CENTER TO CENTER) & DISTANCE BETWEEN TRAFFIC CALMING MEASURES AND END OF STREET

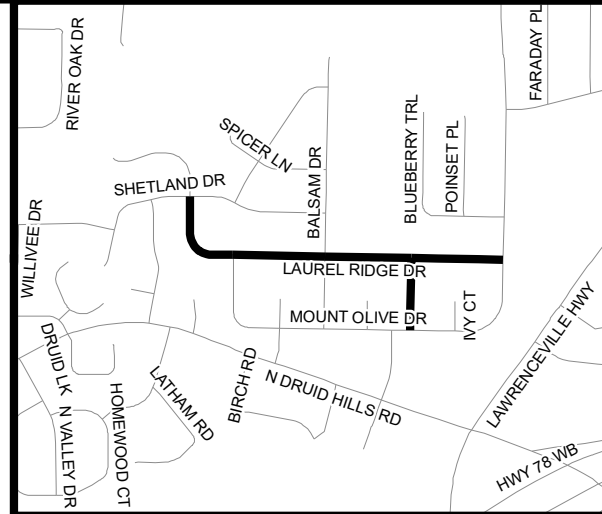
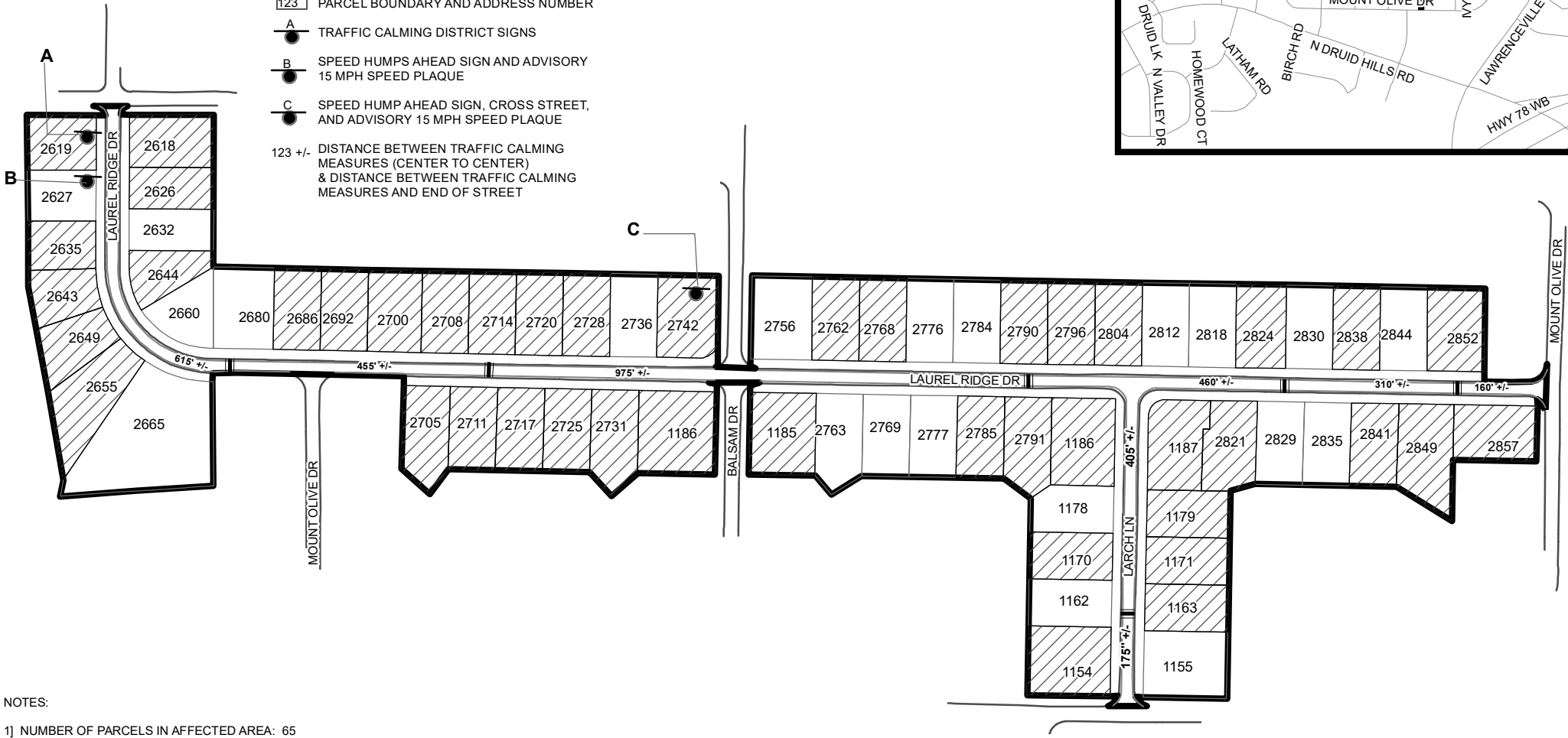

- NOTES:
- 1) NUMBER OF PARCELS IN AFFECTED AREA: 65
  - 2) STREET(S) IN AFFECTED AREA: LAUREL RIDGE DRIVE, LARCH LANE & BALSAM DRIVE
  - 3) EDGE OF TRAFFIC CALMING MEASURE NOT TO ENCROACH WITHIN 5' OF DRIVEWAY RETURNS

<p><b>DEKALB COUNTY TRANSPORTATION DIVISION TRAFFIC CALMING SECTION</b></p>	DRAWN BY: AE	<p>SCALE: N.T.S.</p>	<p>LAUREL RIDGE DRIVE &amp; LARCH LANE DIST: 18 TH LAND LOT: 114 &amp; 115 COMMISSION DISTRICTS: 4 &amp; 6</p>
	REVIEWED BY: PGK		
	REVIEWED BY:	<p>Date: 10/27/2020</p>	
	REVIEWED BY:		