

TRAFFIC CALMING DISTRICT 17-18-00

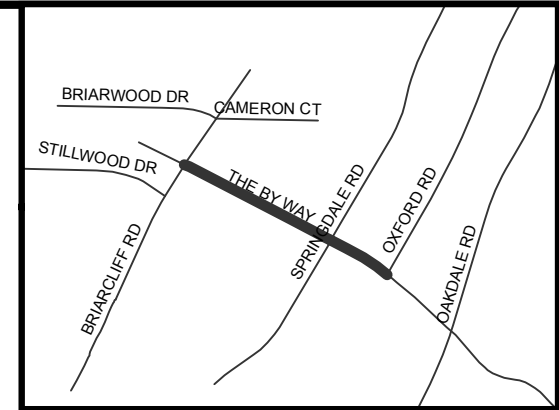

Location Map

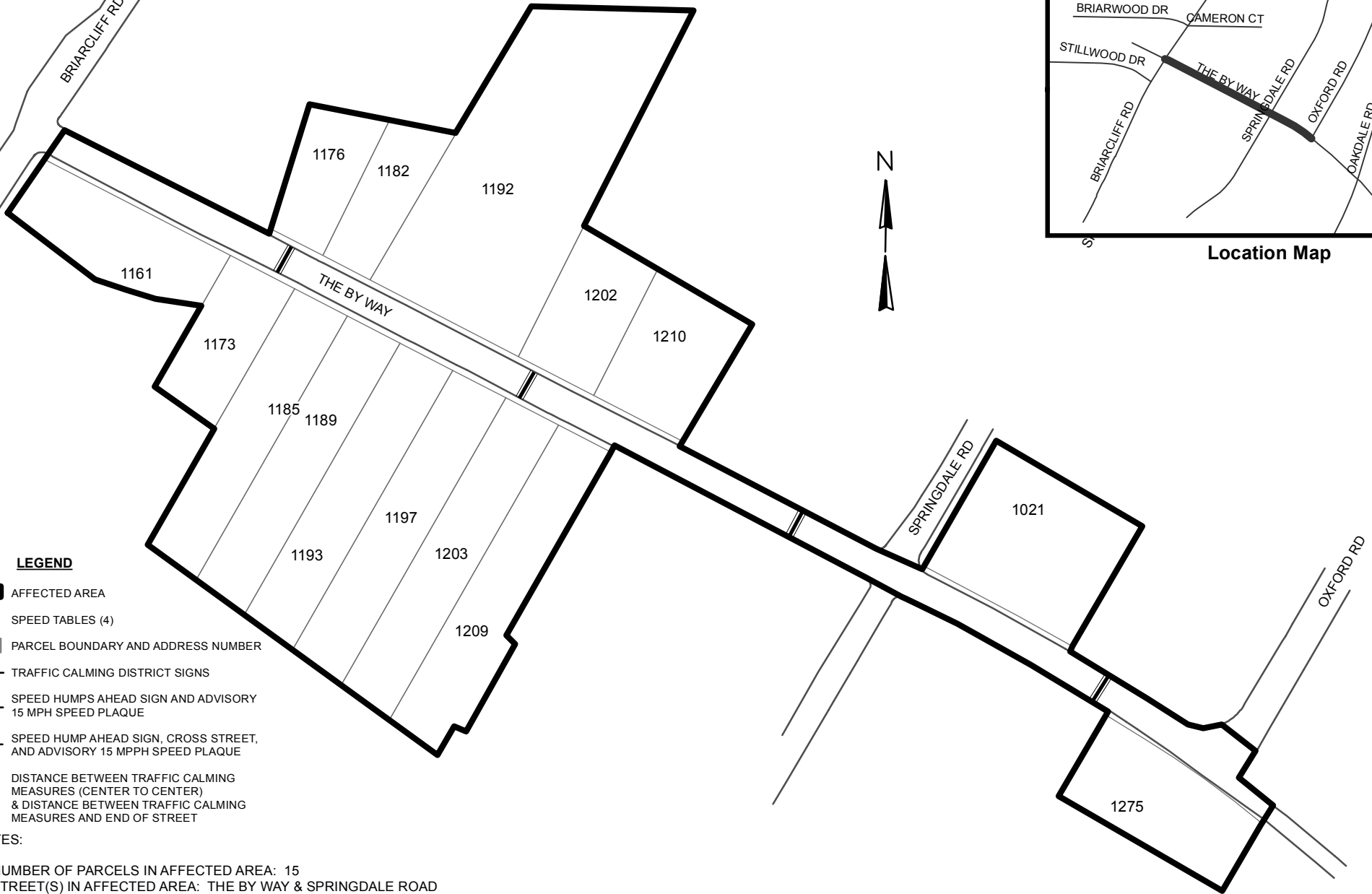

LEGEND

- AFFECTED AREA
 - SPEED TABLES (4)
 - PARCEL BOUNDARY AND ADDRESS NUMBER
 - TRAFFIC CALMING DISTRICT SIGNS
 - SPEED HUMPS AHEAD SIGN AND ADVISORY 15 MPH SPEED PLAQUE
 - SPEED HUMP AHEAD SIGN, CROSS STREET, AND ADVISORY 15 MPPH SPEED PLAQUE
- DISTANCE BETWEEN TRAFFIC CALMING MEASURES (CENTER TO CENTER) & DISTANCE BETWEEN TRAFFIC CALMING MEASURES AND END OF STREET

NOTES:

- 1] NUMBER OF PARCELS IN AFFECTED AREA: 15
- 2] STREET(S) IN AFFECTED AREA: THE BY WAY & SPRINGDALE ROAD
- 3] EDGE OF TRAFFIC CALMING MEASURE NOT TO ENCROACH WITHIN 5' OF DRIVEWAY RETURNS

DEKALB COUNTY
TRANSPORTATION DIVISION
TRAFFIC CALMING SECTION

DRAWN BY: AE

REVIEWED BY: PGK

REVIEWED BY:

REVIEWED BY:

SCALE: N.T.S.

Date: 4/25/2017

THE BY WAY

DIST: 18TH LAND LOT: 1 & 2

COMMISSION DISTRICTS: 2 & 6

Drawing No

1 of 3