

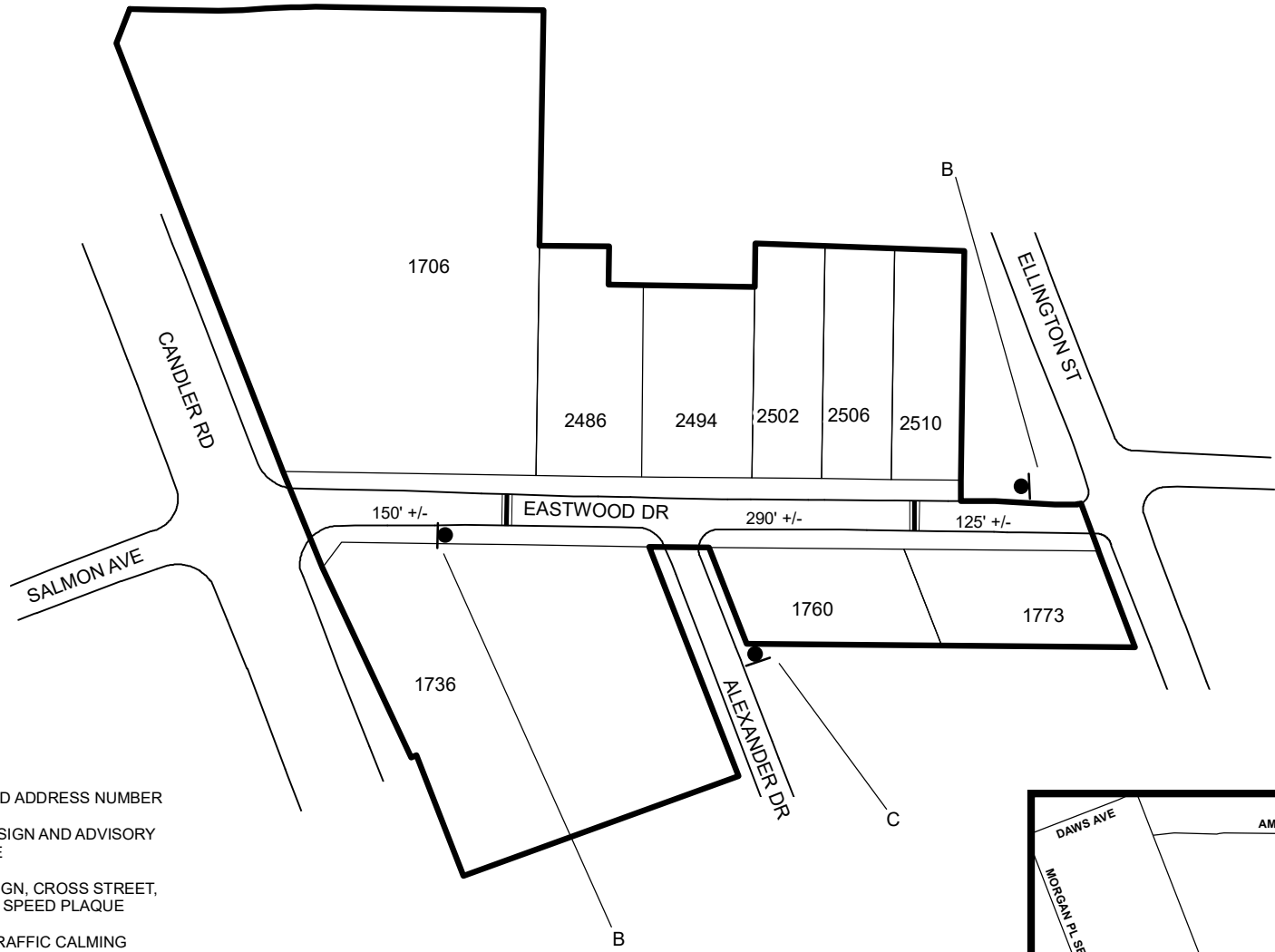





# TRAFFIC CALMING DISTRICT 23-15-00



### LEGEND

-  AFFECTED AREA
-  SPEED TABLES (2)
-  PARCEL BOUNDARY AND ADDRESS NUMBER
-  SPEED HUMPS AHEAD SIGN AND ADVISORY 15 MPH SPEED PLAQUE
-  SPEED HUMP AHEAD SIGN, CROSS STREET, AND ADVISORY 15 MPH SPEED PLAQUE
-  123 +/- DISTANCE BETWEEN TRAFFIC CALMING MEASURES (CENTER TO CENTER) & DISTANCE BETWEEN TRAFFIC CALMING MEASURES AND END OF STREET

### NOTES:

- 1) NUMBER OF PARCELS IN AFFECTED AREA: 9
- 2) STREET(S) IN AFFECTED AREA: EASTWOOD DR, ALEXANDER DR, CANDLER RD, ELLINGTON ST
- 3) EDGE OF TRAFFIC CALMING MEASURE NOT TO ENCROACH WITHIN 5' OF DRIVEWAY RETURNS

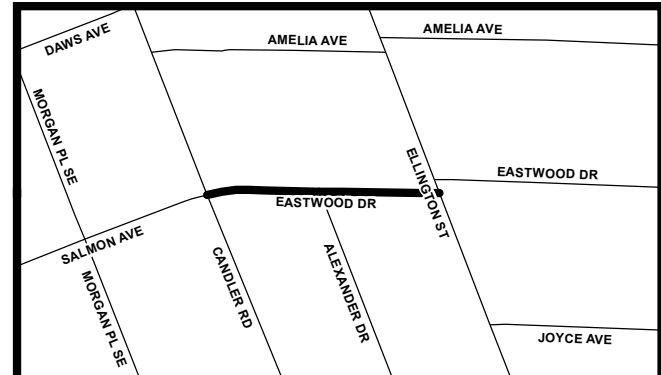

DEKALB COUNTY  
TRANSPORTATION DIVISION  
TRAFFIC CALMING SECTION

DRAWN BY: CH
REVIEWED BY: CH
REVIEWED BY:
REVIEWED BY:

SCALE: N.T.S.
Date: 2/14/2023

EASTWOOD DR  
DIST: 15 TH LAND LOT: 183  
COMMISSION DISTRICTS: 3 & 7