

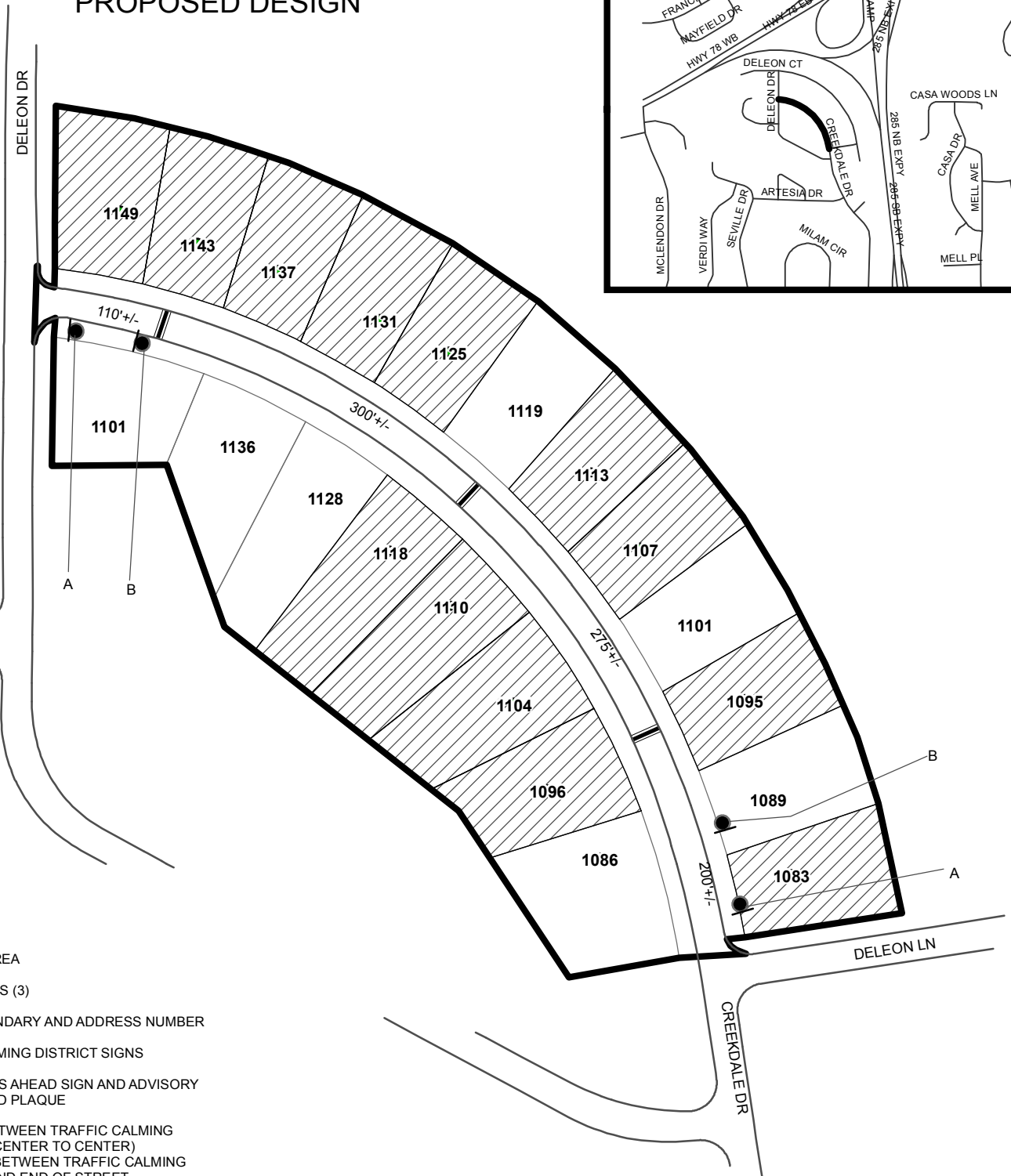

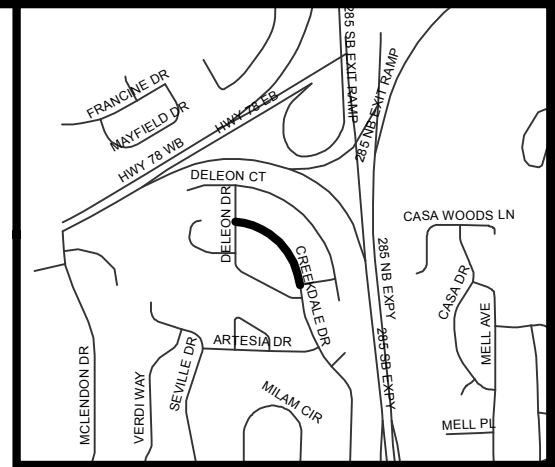

# TRAFFIC CALMING DISTRICT 17-18-04

## PROPOSED DESIGN

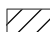

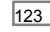
### LEGEND

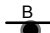
-  YES VOTES
-  AFFECTED AREA
-  SPEED TABLES (3)
-  123 PARCEL BOUNDARY AND ADDRESS NUMBER
-  A TRAFFIC CALMING DISTRICT SIGNS
-  B SPEED HUMPS AHEAD SIGN AND ADVISORY 15 MPH SPEED PLAQUE
- 123 +/- DISTANCE BETWEEN TRAFFIC CALMING MEASURES (CENTER TO CENTER) & DISTANCE BETWEEN TRAFFIC CALMING MEASURES AND END OF STREET

### NOTES:

- 1] NUMBER OF PARCELS IN AFFECTED AREA: 20
- 2] STREET(S) IN AFFECTED AREA: CREEKDALE DRIVE & DELEON DRIVE
- 3] EDGE OF TRAFFIC CALMING MEASURE NOT TO ENCROACH WITHIN 5' OF DRIVEWAY RETURNS

DEKALB COUNTY  
TRANSPORTATION DIVISION  
TRAFFIC CALMING SECTION

DRAWN BY: AE

REVIEWED BY: PGK

REVIEWED BY:

REVIEWED BY:

SCALE: NTS

Date: 5/9/2017

CREEKDALE DRIVE

DIST: 18 TH LAND LOT: 98

COMMISSION DISTRICTS: 4 & 6