

CSXT Transportation (CSXT) General Notes (Aerial):

- 1) Work schedule is subject to the approval of all required construction submittals by the CSXT Construction Representative, verification that proposed work will not conflict with any CSXT U.G. Facilities, and the availability of CSXT Flagging and Protection Services. Construction submittals will be based upon the proposed scope of work and may include, but are not limited to; proposed work plan, project schedule, means and methods, site access, dewatering, temporary excavation/shoring, soil disposition/management, track monitoring, concrete placement work, structural lifting/rigging plans for hoisting operations, substructure construction plans, steel erection plans, roadwork plans, etc. No work may begin on, over, or adjacent to CSXT property, or that could potentially impact CSXT property, operations or safety without the prior completion and approval of the required aforementioned information and approvals.
- 2) CSXT owns its right-of-way for the primary purpose of operating a railroad, and shall maintain unrestricted use of its property for current and future operations. In the event that relocation of facilities becomes necessary to accommodate the movement of rail traffic, Licensee, at its sole risk and expense, shall be required to relocate and/or remove facilities from the rail corridor of Licensor within a time frame mutually agreed.
- 3) CSXT's consent applies to the design and construction of the utility located solely in the right-of-way owned by CSXT and assures that CSXT and AREMA Standard Specifications are met for tracks owned by others over which CSXT operates. It is the utility Owner's (Applicant) responsibility to get permission from the property owner that is other than CSXT to access and construct on their property.
- 4) Refer to the CSXT's "Design & Construction Standard Specifications Wireline Occupancies" revised December 16, 2016 and "Design & Construction Standard Specifications Pipeline Occupancies" revised June 5, 2018 (4.1.2)
- 5) CSXT's signal facilities and/or warning devices at proposed facility crossing, i.e. cantilevers, flashers, and gates are to be located prior to installation.
- 6) No entry or construction on CSXT's railroad corridor is permitted until the utility encroachment review and approval process is completed, you are in receipt of a fully executed License agreement and you have obtained authority from the local Road Master.
- 7) CSXT does not grant or convey an easement for this installation.
- 8) The use of construction safety fencing is required when a CSXT Flagman is not present. Distance of fencing from nearest rail to be determined by the CSXT Roadmaster and shall be removed upon completion of the project.

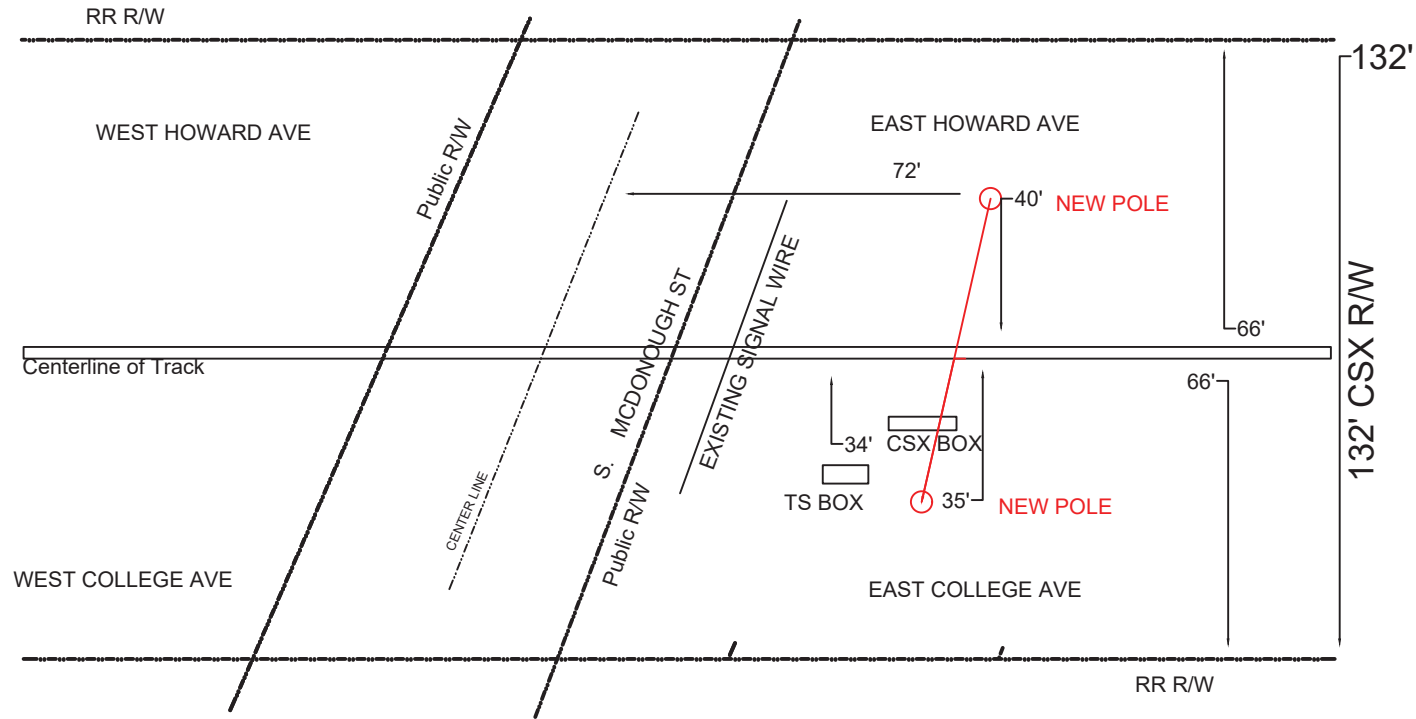

- (a) 72' from center line of S. McDonough st to NEW POLE
- (b) 132' CSX R/W (val map 07159)
- (c) 66' from E. College ave to centerline of track
- (c) 66' from E. Howard ave to centerline of track
- (e) 35' from NEW POLE on E. College ave side to centerline of track
- (e) 40' from NEW POLE on E. Howard ave side to centerline of track

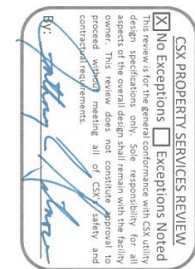

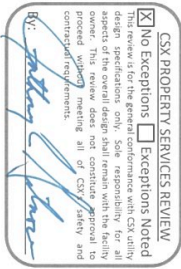

NOTES:

REFER TO ENGINEERING SPECIFICATIONS IN THE APPLICATION PACKAGE FOR ADDITIONAL INFORMATION AND GUIDANCE.

LOCATE CSX'S SIGNAL FACILITIES AND/OR WARNING DEVICES AT PROPOSED FACILITY CROSSING LOCATION, I.E. CANTILEVERS, FLASHERS, GATES AND SHOW CLEARANCES.

POLES/GUY WIRES/ANCHORS AND OTHER ANCILLIARIES ARE NOT PERMITTED ON CSXT R/W.

YOUR DRAWING MUST SHOW ALL SETS OF TRACKS PRESENT AT THE PROPOSED UTILITY CROSSING LOCATION.

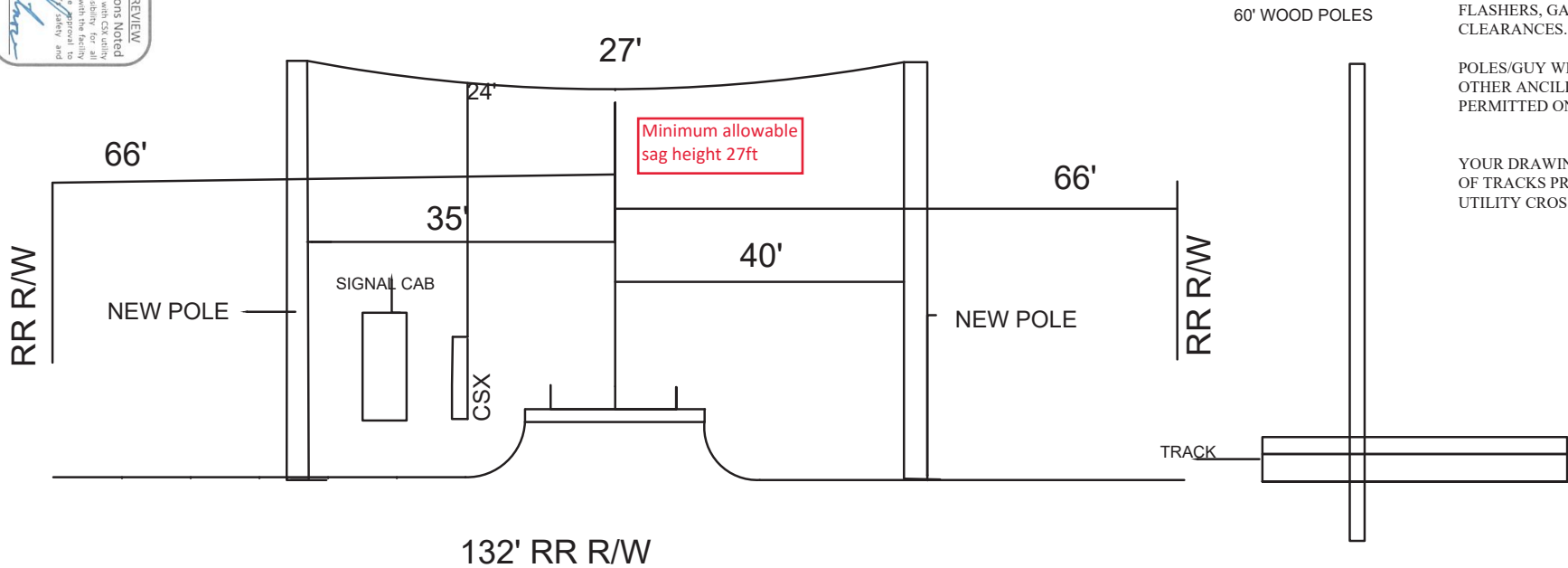

LEGEND		WIRE/CABLE DETAILS				YOUR TITLE BLOCK
Letter	Description	Type:				
(a)	Distance from centerline of track to CSX R/W	<input checked="" type="checkbox"/> Electric <input type="checkbox"/> Communications				Location: _____ Latitude: N ____; ____; ____ Longitude: W ____; ____; ____ Drawing No.: _____ Sheet: ____ of ____ Drawing Date: ____/____/____ Revised: ____/____/____ Drawing Scale: V ____ Inches = ____ Feet Drawing Scale: H ____ Inches = ____ Feet
(b)	Distance from pole to centerline of nearest track	<input type="checkbox"/> Cable TV <input type="checkbox"/> Other Describe: _____				
(c)	Distance from top-of-rail to bottom-of-sag	Conductor Material(s): <input checked="" type="checkbox"/> Aluminum/Copper <input type="checkbox"/> Other Describe: _____	Wire/Cable 1	Wire/Cable 2	Wire/Cable 3	
(d)	Height of wire above CSX aerial facilities	<input type="checkbox"/> Fiber Optic <input type="checkbox"/> Other Describe: _____				
(e)	Distance between existing and proposed cable/wireline	Fiber Cable Count:				
		Wire Size/Pair: 7pr	3pr shielded			
		Voltage: 120				
		If options above not applicable, describe:				
		Number of Phases (Electric Only): single				
		Type of Wire Supports: messenger wire				
		False Dead Ends: 0				
		Total # of CSX Pole Lines to be Crossed: 0				