

TRAFFIC CALMING DISTRICT 23-18-01

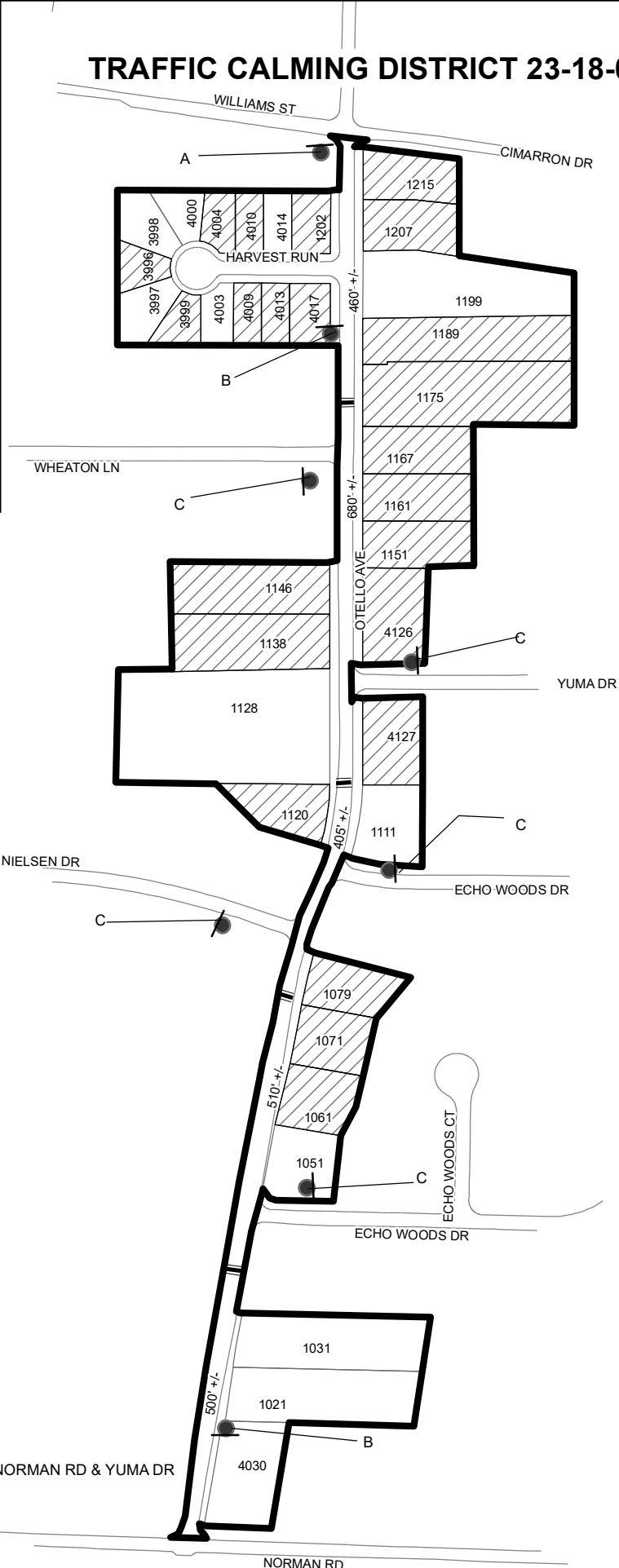
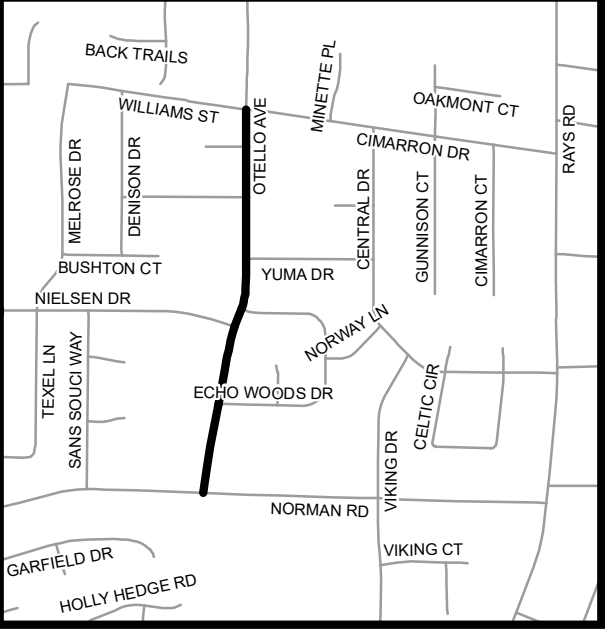

LEGEND

- AFFECTED AREA
- YES VOTES (23)
- SPEED TABLES (4)
- PARCEL BOUNDARY AND ADDRESS NUMBER
- TRAFFIC CALMING DISTRICT SIGNS
- SPEED HUMPS AHEAD SIGN AND ADVISORY 15 MPH SPEED PLAQUE
- SPEED HUMP AHEAD SIGN, CROSS STREET, AND ADVISORY 15 MPH SPEED PLAQUE
- 123 +/- DISTANCE BETWEEN TRAFFIC CALMING MEASURES (CENTER TO CENTER) & DISTANCE BETWEEN TRAFFIC CALMING MEASURES AND END OF STREET

NOTES:

- 1) NUMBER OF PARCELS IN AFFECTED AREA: 35
- 2) STREET(S) IN AFFECTED AREA: OTELLO AVE, HARVEST RUN, NORMAN RD & YUMA DR
- 3) EDGE OF TRAFFIC CALMING MEASURE NOT TO ENCROACH WITHIN 5' OF DRIVEWAY RETURNS

DEKALB COUNTY
TRANSPORTATION DIVISION
TRAFFIC CALMING SECTION

DRAWN BY: AE
REVIEWED BY: AE
REVIEWED BY: AE
REVIEWED BY:

SCALE: N.T.S.
Date: 3/14/2023

OTELLO AVENUE
DIST: 18 TH LAND LOTS: 95 & 120
COMMISSION DISTRICTS: 4 & 6