

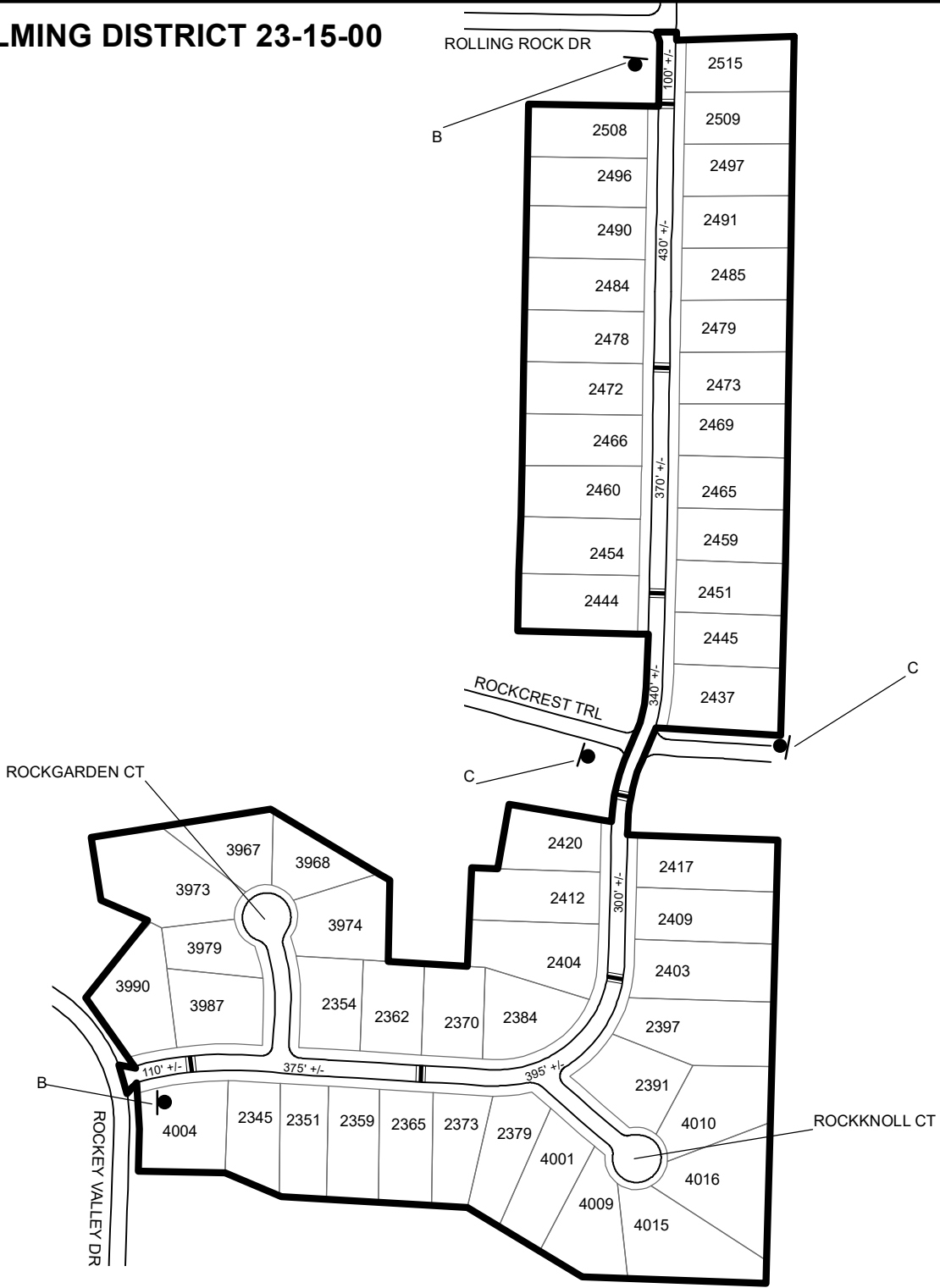

TRAFFIC CALMING DISTRICT 23-15-00



LEGEND

-  AFFECTED AREA
-  SPEED TABLES (7)
-  PARCEL BOUNDARY AND ADDRESS NUMBER
-  SPEED HUMPS AHEAD SIGN AND ADVISORY 15 MPH SPEED PLAQUE
-  SPEED HUMP AHEAD SIGN, CROSS STREET, AND ADVISORY 15 MPH SPEED PLAQUE
- 123 +/- DISTANCE BETWEEN TRAFFIC CALMING MEASURES (CENTER TO CENTER) & DISTANCE BETWEEN TRAFFIC CALMING MEASURES AND END OF STREET

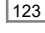
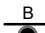
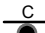
NOTES:

- 1) NUMBER OF PARCELS IN AFFECTED AREA: 54
- 2) STREET(S) IN AFFECTED AREA: ROCKKNOLL DR, ROCKEY VALLEY DR, ROCKGARDEN CT, ROCKKNOLL CT
- 3) EDGE OF TRAFFIC CALMING MEASURE NOT TO ENCROACH WITHIN 5' OF DRIVEWAY RETURNS

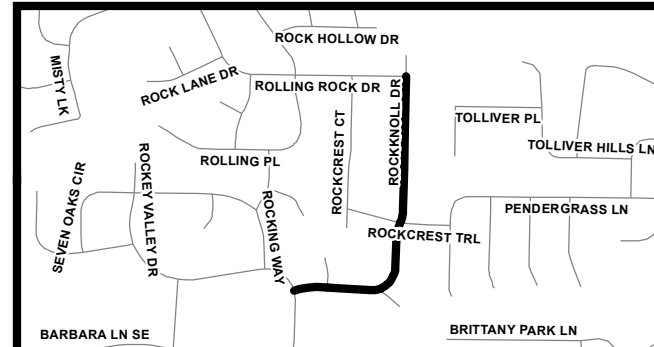

DEKALB COUNTY
TRANSPORTATION DIVISION
TRAFFIC CALMING SECTION

DRAWN BY: CH/AE
REVIEWED BY: CH/AE
REVIEWED BY:
REVIEWED BY:

SCALE: N.T.S.
Date: 8/8/2023

ROCKKNOLL DR
DIST: 15 TH LAND LOTS: 22 & 43
COMMISSION DISTRICTS: 3 & 6