

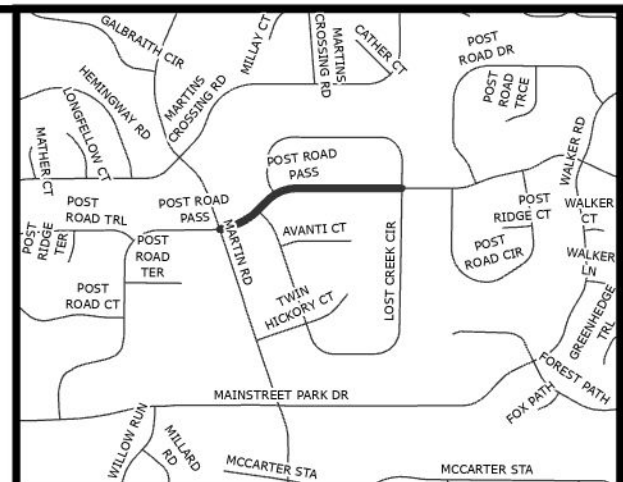







TRAFFIC CALMING DISTRICT 26-16-01

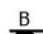

LEGEND:

-  AFFECTED AREA
 -  YES VOTES (11)
 -  SPEED TABLES (3)
 -  123 PARCEL BOUNDARY AND ADDRESS NUMBER
 -  A TRAFFIC CALMING DISTRICT SIGNS
 -  B SPEED HUMPS AHEAD SIGN AND ADVISORY 15 MPH SPEED PLAQUE
 -  C SPEED HUMP AHEAD SIGN, CROSS STREET, AND ADVISORY 15 MPH SPEED PLAQUE
- 123' +/- DISTANCE BETWEEN TRAFFIC CALMING MEASURES (CENTER TO CENTER) & DISTANCE BETWEEN TRAFFIC CALMING MEASURES AND END OF STREET

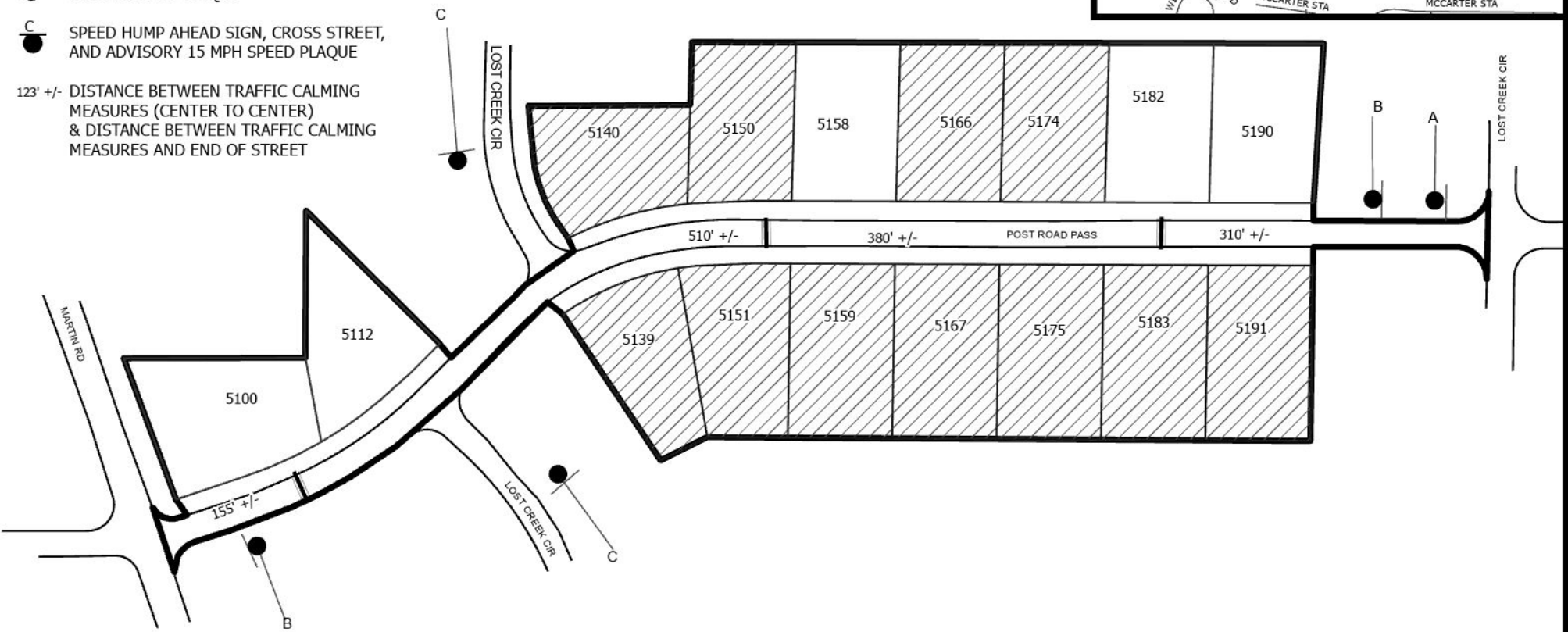

- NOTES:**
- 1] NUMBER OF PARCELS IN AFFECTED AREA: 16
 - 2] STREET(S) IN AFFECTED AREA: POST RD PASS
 - 3] EDGE OF TRAFFIC CALMING MEASURE NOT TO ENCROACH WITHIN 5' OF DRIVEWAY RETURNS

DEKALB COUNTY TRANSPORTATION DIVISION TRAFFIC CALMING SECTION	DRAWN BY: AE	SCALE: N.T.S. DATE: 4/14/2026	POST ROAD PASS DIST: 16 TH LAND LOT: 32 COMMISSION DISTRICTS: 4 & 7
	REVIEWED BY: AE		
	REVIEWED BY:		
	REVIEWED BY:		