

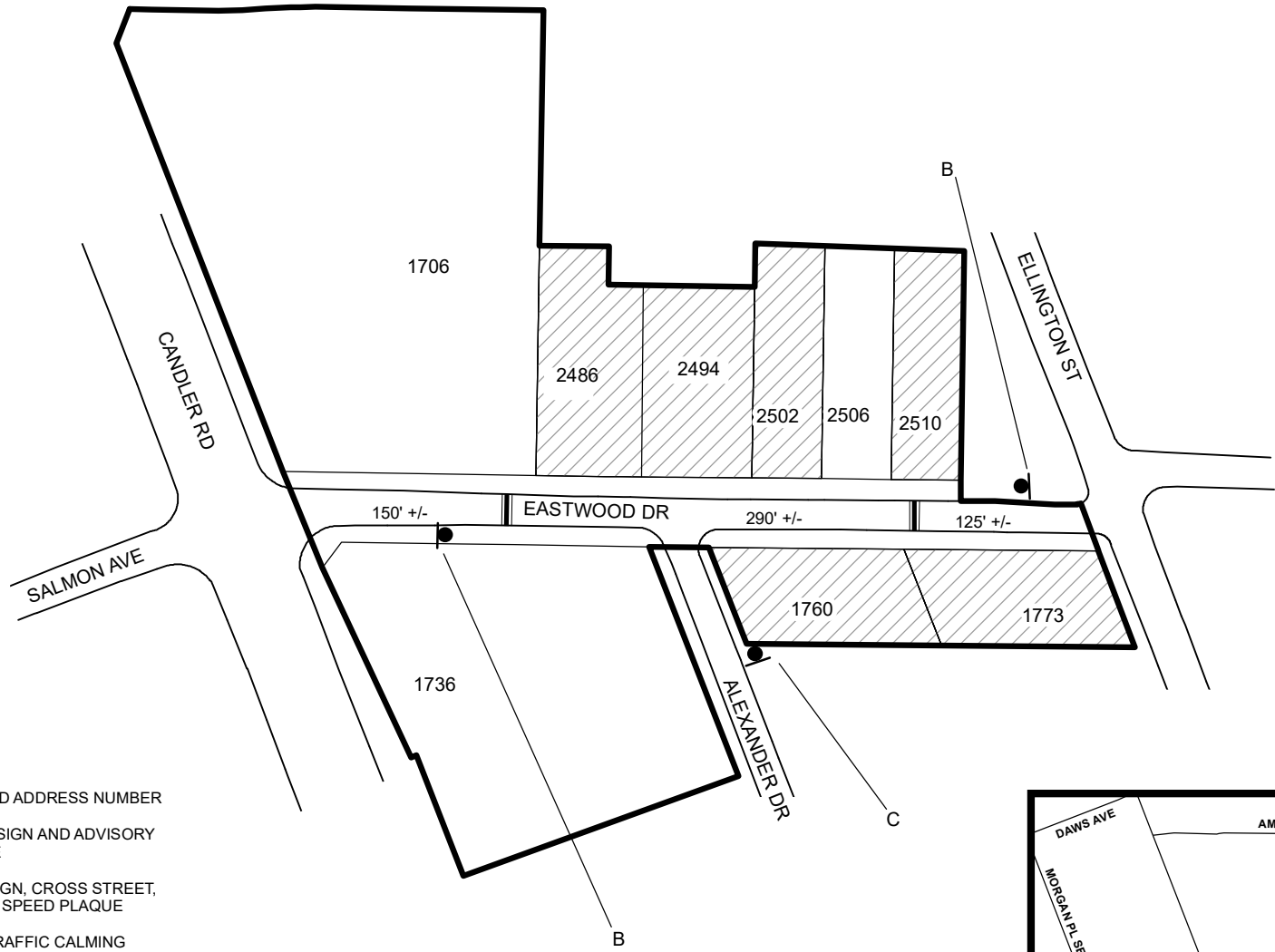







# TRAFFIC CALMING DISTRICT 23-15-07



### LEGEND

-  AFFECTED AREA
-  Yes Votes (6)
-  SPEED TABLES (2)
-  PARCEL BOUNDARY AND ADDRESS NUMBER
-  SPEED HUMPS AHEAD SIGN AND ADVISORY 15 MPH SPEED PLAQUE
-  SPEED HUMP AHEAD SIGN, CROSS STREET, AND ADVISORY 15 MPH SPEED PLAQUE
-  123 +/- DISTANCE BETWEEN TRAFFIC CALMING MEASURES (CENTER TO CENTER) & DISTANCE BETWEEN TRAFFIC CALMING MEASURES AND END OF STREET

### NOTES:

- 1] NUMBER OF PARCELS IN AFFECTED AREA: 9
- 2] STREET(S) IN AFFECTED AREA: EASTWOOD DR, ALEXANDER DR, CANDLER RD, ELLINGTON ST
- 3] EDGE OF TRAFFIC CALMING MEASURE NOT TO ENCROACH WITHIN 5' OF DRIVEWAY RETURNS

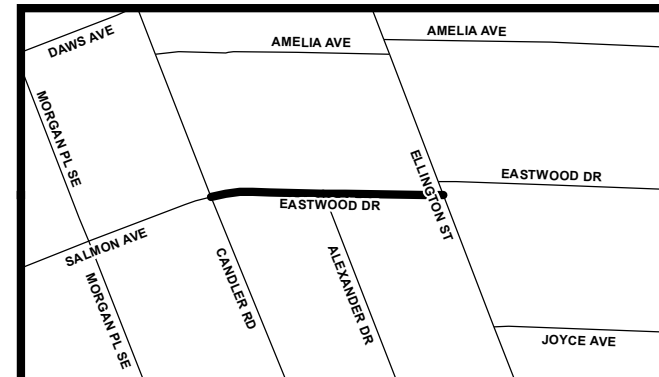

DEKALB COUNTY  
TRANSPORTATION DIVISION  
TRAFFIC CALMING SECTION

DRAWN BY: CH/AE  
REVIEWED BY: CH/AE  
REVIEWED BY:  
REVIEWED BY:

SCALE: N.T.S.

Date: 7/25/2023

EASTWOOD DR

DIST: 15 TH LAND LOT: 183

COMMISSION DISTRICTS: 3 & 7